

**MOORE COUNTY HEALTH DEPARTMENT
ENVIRONMENTAL HEALTH SECTION
OPERATION PERMIT**

61 N. Shamrock
3 bedrooms
LAK# 0004638

Owner: Richard Knight Address: 61 N. Shamrock
 Permit # 22241 Receipt # _____ LAK# 0004638
 Installer: Don Gaddy Telephone: _____
 Address: _____
 System Type: 25% reduction Maximum Design Flow: 360 (gallons/day)
 Wastewater Characteristics: domestic
 Septic Tank Capacity: 1000 (Gallons) Tank I.D. # CITS-1000 STB103
 Nitrification Line Dimensions: 1 @ 150' x 3' of 25% reduction. 1-3-19
 Effluent Distribution Device: serial Gravel Depth: Chamber
 Depth To: Top of Tanks: 6" (Inches) Trench Bottom: @ 18-20" (Inches)

Diagram of Actual Installation: (Depict Property Boundaries, Structures, Driveways, Trees, Water Lines, Water Supplies, Etc.)

Scale: _____ Inch = _____ Feet.

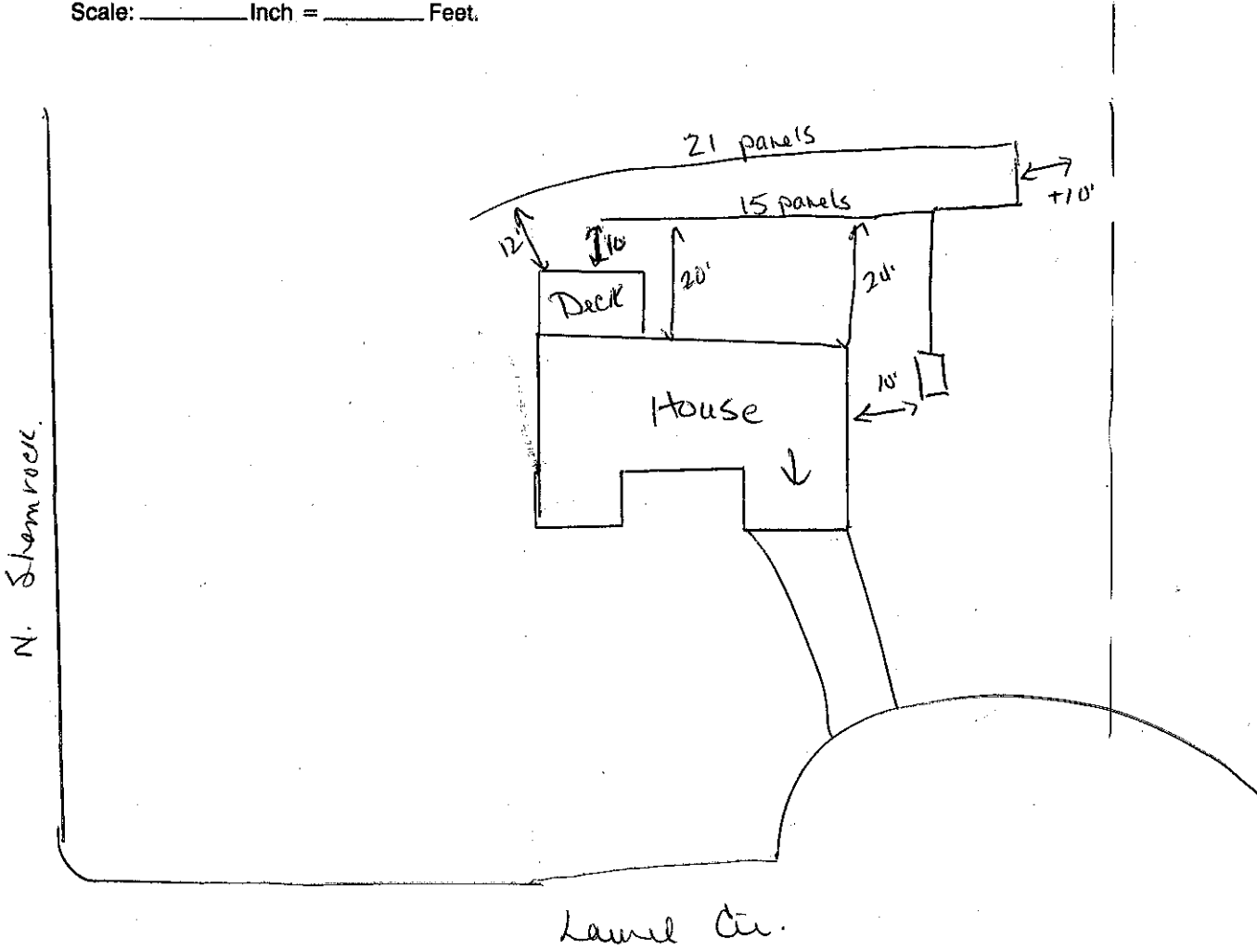

Comments and Conditions: _____

Issued By: Deanne R. West REITS # of Attachments: _____
 Date: 3-1-19

FINAL APPROVAL OF THIS SYSTEM SHALL INDICATE THAT THE SYSTEM HAS BEEN INSTALLED IN ACCORDANCE WITH APPLICABLE PERMIT CONDITIONS, LAWS AND RULES, BUT IN NO WAY SHOULD BE TAKEN AS A GUARANTEE THAT THE SYSTEM WILL FUNCTION SATISFACTORILY FOR ANY GIVEN TIME.