

**SKETCH ADDENDUM**

Intended User  
 Property Address 303 E. James Street  
 City La Grange County Lenoir State NC Zip Code 28551  
 Client Veneta Ford

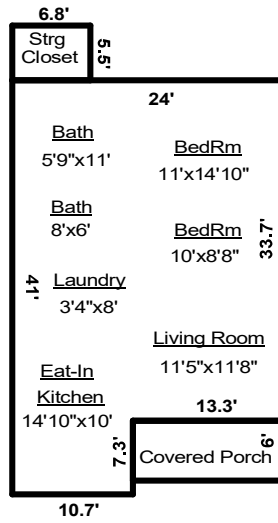

SUMMARY	SQ FT AREA	PERIMETER	AREA CALCULATION DETAILS
Living Area			First Floor
First Floor	887	130	24.0 X 33.7 = 808.8
			10.7 X 7.3 = 78.1
			Total 886.9
Porch			
Porch	80	39	
Other			
Storage Closet	37	25	