

Building Sketch

Borrower/Client	/Diana Holdridge			
Property Address	907 Grandview Drive			
City	Hampstead	County	State	NC
Lender	Measured on 06/21/24 according to NCREC Guidelines			

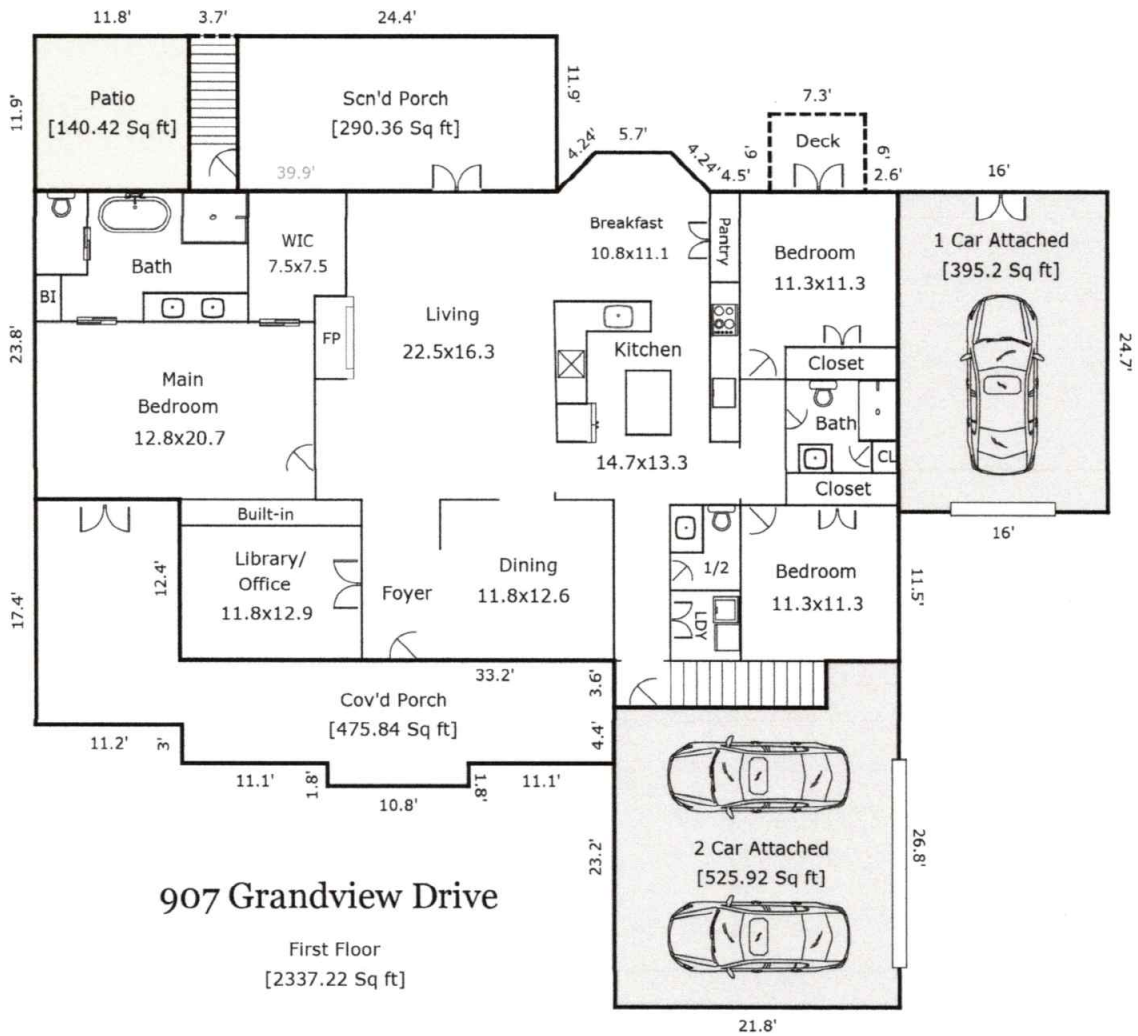

TOTAL Sketch by a la mode

Building Sketch

Borrower/Client	/Diana Holdridge		
Property Address	907 Grandview Drive		
City	Hampstead	County	State NC Zip Code
Lender	Measured on 06/21/24 according to NCREC Guidelines		

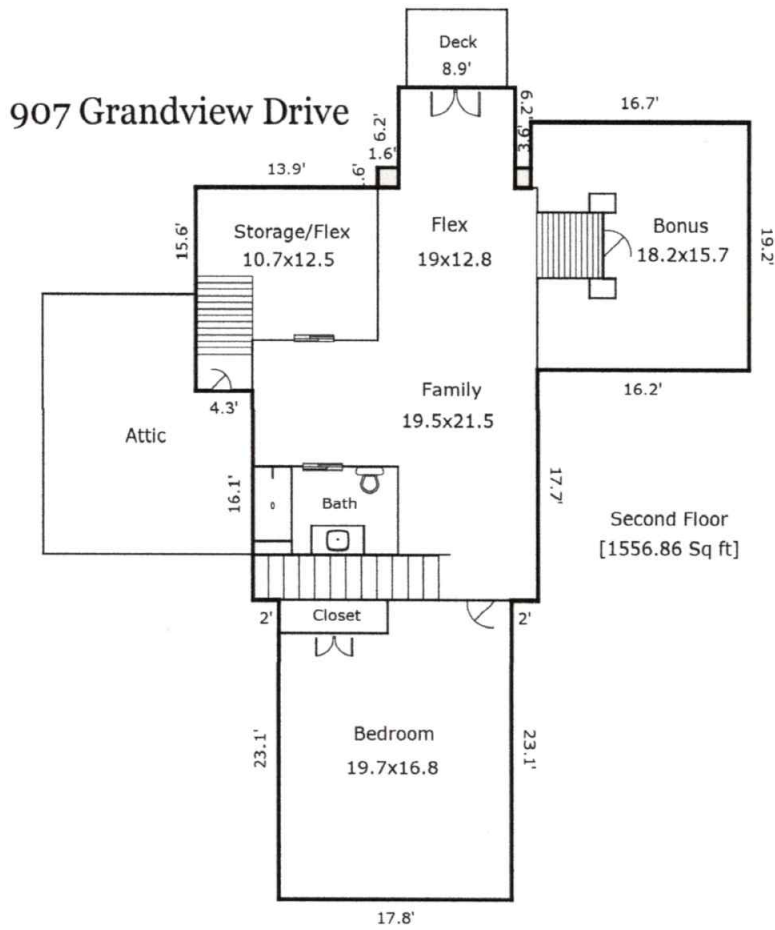

TOTAL Sketch by a la mode

Building Sketch

Borrower/Client	/Diana Holdridge		
Property Address	907 Grandview Drive		
City	Hampstead	County	State NC Zip Code
Lender	Measured on 06/21/24 according to NCREC Guidelines		

TOTAL Sketch by a la mode

Area Calculations Summary

Living Area	Calculation Details	
First Floor	2337.22 Sq ft	$16.2 \times 3.6 = 58.32$ $0.5 \times 3 \times 3 = 4.5$ $0.5 \times 3 \times 3 = 4.5$ $5.7 \times 3 = 17.1$ $36.2 \times 55 = 1991$ $11 \times 23.8 = 261.8$
Second Floor	1556.86 Sq ft	$8.9 \times 6.2 = 55.18$ $17.8 \times 23.1 = 411.18$ $19.2 \times 16.2 = 311.04$ $21.8 \times 16.1 = 350.98$ $15.6 \times 13.9 = 216.84$ $12.2 \times 17.2 = 209.84$ $3.6 \times 0.5 = 1.8$
N-L Area	-2.56 Sq ft	$1.6 \times 1.6 = 2.56$
N-L Area	-1.92 Sq ft	$1.2 \times 1.6 = 1.92$
Total Living Area (Rounded):	3890 Sq ft	
Non-living Area		
1 Car Attached	395.2 Sq ft	$24.7 \times 16 = 395.2$
2 Car Attached	525.92 Sq ft	$21.8 \times 23.2 = 505.76$ $5.6 \times 3.6 = 20.16$
Scn'd Porch	290.36 Sq ft	$24.4 \times 11.9 = 290.36$
Deck	44.03 Sq ft	$3.7 \times 11.9 = 44.03$
Cov'd Porch	475.84 Sq ft	$10.8 \times 1.8 = 19.44$ $11 \times 12.4 = 136.4$ $5 \times 11.2 = 56$ $8 \times 33 = 264$
Patio	140.42 Sq ft	$11.8 \times 11.9 = 140.42$
Deck	43.8 Sq ft	$7.3 \times 6 = 43.8$