

BRUNSWICK COUNTY HEALTH DEPARTMENT

DATE REC: 6-9-92 P.I.N.: _____ FILE NO.: 92 / 28577

MCHENRY GINNY REC. FROM 50.00 AMT. PD 220NA078 TAX PARCEL

108 NE 15TH STREET ADDRESS LONG BEACH CITY NC STATE 28465 ZIP 919278-9874 PHONE

HARBOR DEVELOPMENT CORPORATION CURRENT PROPERTY OWNER OAKWOOD GLEN SUBDIVISION 78/ LOT / BLK / SEC

PROPERTY LOCATED. TOWN/CITY/AREA/ SOUTHPORT DIRECTIONS TO PROPERTY: 1 MI BEHIND BRUNSWIC

K COUNTY AIRPORT

SITE EVALUATION REPORT

FACTORS	A1				A2				A3
	I	II	III	IV	I	II	III	IV	
1) Slope/landscape position	(S)	PS	U		(S)	PS	U		
2) A. Soil Texture	(I)	II	III	IV	(I)	II	III	IV	
B. Soil Structure	(S)	PS	U		(S)	PS	U		
3) Soil Drainage (Wetness)	(S)	PS	(U)		(S)	PS	(U)		
4) Soil Depth	(S)	PS	U		(S)	PS	U		
5) Restrictive Horizon	(S)	(PS)	U		(S)	(PS)	U		
6) Available Space	(S)	(PS)	U		(S)	(PS)	U		

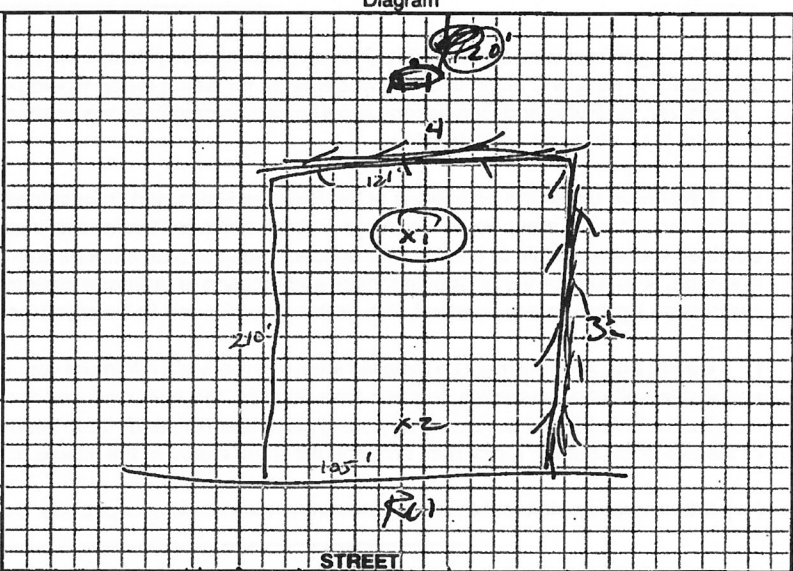

Soil Description		
Area A1	Area A2	Area A3
A Horizon <u>0-12</u> <u>Gray Sand</u>	<u>0-14 Black L</u> <u>14-20 Dark Brn</u>	
Bh Horizon <u>12-20</u> <u>Medium Gray & Black</u>	<u>20-24 Black Brown Firm</u>	
B Horizon <u>20-22</u> <u>HP</u>	<u>24-28 Gray Sand Damp</u> <u>28-29 Firm</u>	
C Horizon <u>22-38 Fine GS</u> <u>38-49 FLS</u>	<u>Brn. Pan</u> <u>ca. 49 10mm x 5mm</u>	

NOTES: See attached fill plan & proposed layout

Over all site classification: Suitable _____ Provisionally suitable _____ Unsuitable X

See diagram above for location of soil borings and area location.

Evaluated by: James Wilkerson Title: _____ Date: 8-6-97

Re-evaluated by: _____ Date: _____ Reclassification: S _____ PS _____ U _____

NOTES: _____ Date Mailed: _____

Reclassification Code _____ Drainage _____ X Fill _____ Alternative System _____ Other _____ SEE REVERSE SIDE OR ATTACHED

Improvement Permit/ _____ Certificate of Completion/Operation Permit _____ Existing System _____ Repair _____ Permit/File No. 92 28577

G.S. CHAPTER 130A ARTICLE 11, G.S. 130 A-333 et. Sec.

Permitted for: H _____ MH _____ Bus _____ Multi-Family _____ Trench Bottom Area (_____) ft² Trench bottom no deeper than: (")

No. Units _____ No. Bedrooms _____ Size of Tank _____

No. Lines _____ Length ea. _____ Trench width _____

Water Supply: Private _____ Public _____

NOTE: ANY CHANGES IN THE NATURE AND VOLUME OF SEWAGE OR CHANGE IN LOCATION OF STRUCTURE WILL VOID PERMIT.

IMPROVEMENT PERMIT VOID 60 MONTHS FROM DATE OF ISSUANCE.

IMPROVEMENT PERMIT DATE: -60-

Conditions: _____

By: _____ SAN.

Permit Not Valid Unless Signed by Authorized Agent/Sanitarian

This permit not to be altered except by authority of Health Department.

Installed by: _____ Certificate of Completion/Operation Permit Approved by: _____ SAN.

NOTE: See important information on reverse side. (Permit Not Valid Unless Signed by Authorized Agent/Sanitarian) Date: _____/_____/_____

Comments/ Conditions: _____

BCHD 04/88

DATE: ____/____/____

APPLICATION NO: ____/____

Dear _____:

A Site evaluation was conducted on that property described in Improvement Permit Application above on ____/____/____. This evaluation was conducted in accordance with applicable rules and regulations as specified in the North Carolina Sewage Rules and Regulations.

The site has been classified as unsuitable due to: _____

The Rules and Regulations Section(s) # _____ require(s) that: _____

If a Sewage Treatment and Disposal System (Septic tank system) were installed on this site without modification, the potential for massive failure of the system to treat and dispose of the wastewater, for which repair would be costly or impossible is a certainty.

However, the Rules and Regulations allow for certain modifications or alternatives to be made to reclassify the site from unsuitable to provisionally suitable. (See checked section below.)

() **Drainage:** under the conditions of the Sewage Rules and Regulations, drainage may be installed to lower the seasonally high water table and/or overcome surface water drainage problems due to "landscape position". For ground water lowering purposes, a suitable outlet must be obtained and accessible to the site. A proposed drainage plan must be submitted for review showing such things as elevation of the outlet; type of drainage, (subsurface tile or open ditches); and location of drainage system in relationship to the lot or site. **NOTE: If soil texture, structure, or restrictive horizons are present, the drainage will need to be monitored during the wet season to determine its effectiveness.**

() **Use of Fill:** Areal fill must be installed such that there is a minimum separation of "two feet" between the trench bottom and any soil horizon with unsuitable soil characteristics. In such area fill sites, the soil used and the areal extent of fill shall be approved by this department prior to the installation. This fill shall have a sandy, loamy sand, loam or sandy loam texture. There shall be a mix of the fill soil and the original soil at the interface of the two soils. Submit a plot plan showing the areal extent of the fill and fill depth for review prior to when the modification work is started.

() Site and/or soil limitations are too severe to overcome except under the provisions listed on "attached letter".

() Other Alternatives: _____

NOTE: The design, construction, operation, and maintenance of sewage, treatment, and disposal system shall be the responsibility of the designer, owner, developer, installer or user of the system as applicable and any design submitted for review is subject to the approval based on any applicable Sewage, Collection, Treatment and Disposal Rules or Regulations.

If you have any questions or would like to meet the Sanitarian on site to discuss these modifications, please call between 8:30 a.m. and 9:30 a.m. from Monday thru Friday or write the Department.

BRUNSWICK COUNTY HEALTH DEPARTMENT
ENVIRONMENTAL HEALTH SECTION
P.O. Box 9
BOLIVIA, NC 28422-0009

(919) 763-1312 Leland
457-5281 Southport/Oak Island
253-4381 All other areas

SIGN _____

IMPROVEMENT PERMIT INFORMATION

Sewage Treatment and Disposal Systems must be installed in accordance with all applicable laws, rules and regulations.

The sewage system shall not be located under paved areas or driveways.

The sewage system shall not be located closer than;

- 100'from any water supply* (no less than 50' with certain conditions)
- 10'from any water line
- 5'from any building foundation
- 10'from any property line** (no less than 5'-lots of record as of 7/1/77)
- (____)other specify _____

Any change in location of the sewage system must be approved by the Health Dept. prior to installation.

Call for an inspection upon completion between 8:30 a.m. and 9:30 a.m., Monday thru Friday.

FILL

In some cases your property can be modified in order to install a conventional or modified conventional septic tank system. A commonly accepted Site Modification is the use of **Fill**.

Fill is a specific amount of soil (sandy to sandy loam) placed in an area designated for the septic system to overcome limitations of the soil and site due to shallow soils, shallow seasonal high water tables, restrictive soil horizons, and other soil characteristics. Fill can be placed on a site to raise the area for the nitrification drain line so the more suitable shallow soils can be utilized. The area and depth of the fill will vary due to the limiting soil condition.

If your lot (site) can be modified with **Fill**, contact the Environmental Health Specialist (Sanitarian) for details and specifics regarding the site evaluation of your lot (site).

*3 Bedcom
9005-
3(67)1140*

FILL PLAN

Depth of fill 12"
 Total area of fill 40' X 83'
 System and buffer zone area 32' X 80'
 Length of side slope 4'
 Number and length of lines 3 (67')

File # 92/2 8577

* Not to scale

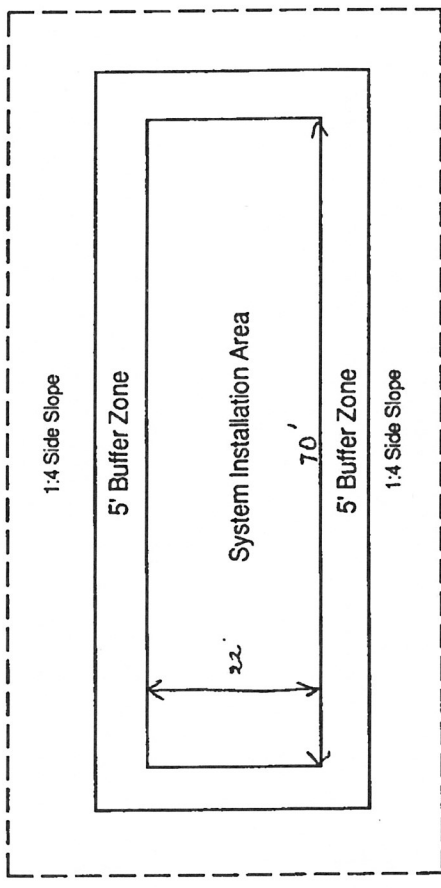

CROSS SECTIONS

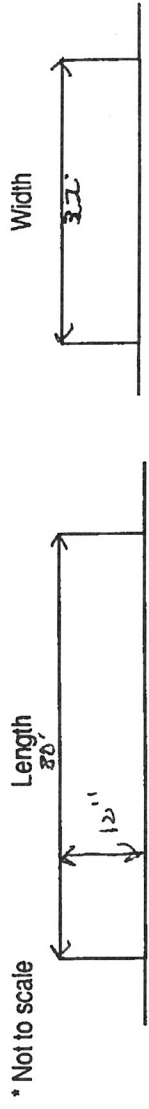

* Not to scale

NOTES

- Home site may need to be modified to insure gravity flow to the system.
- If home site is not modified, a pump or low pressure pipe system is required.
- Any setbacks required are calculated from the toe of the fill.

FILL INSTALLATION

- Remove vegetation and root mat.
- Disc fill site.
- After the addition of 4" - 6" of sand or loamy sand fill, disc fill site again to provide a mix of fill and natural soil to a depth of 6" below the interface.
- Add additional sand or loamy sand fill to depth required in system installation area and buffer zone area.
- Construct a 1:4 side slope as shown from the top edge of the fill tapered down to the natural ground surface.
- Call for re-inspection by Health Department.