

CERTIFICATE OF APPROVAL FOR RECORDING  
 I HEREBY CERTIFY THAT THE SUBDIVISION PLAT SHOWN HEREON HAS BEEN FOUND TO COMPLY WITH SUBDIVISION REGULATIONS OF THE COUNTY OF ONSLOW, NORTH CAROLINA, AND THAT THIS PLAT HAS BEEN APPROVED BY THE ONSLOW COUNTY PLANNING BOARD FOR RECORDING IN THE OFFICE OF THE REGISTER OF DEEDS OF ONSLOW COUNTY.  
 DATE: 1/20/06  
 SUBDIVISION ADMINISTRATOR

NORTH CAROLINA, ONSLOW COUNTY  
 I, A NOTARY PUBLIC OF THE COUNTY AND STATE ABOVE SAID, DO HEREBY CERTIFY THAT JOHN L. PIERCE, A PROFESSIONAL LAND SURVEYOR, HAS APPEARED BEFORE ME THIS DAY AND ACKNOWLEDGED THE EXECUTION OF THE FOREGOING INSTRUMENT.  
 WITH MY HAND AND OFFICIAL SEAL, THIS DAY OF JANUARY, 2006.  
 SEAL OR STAMP: JOHN L. PIERCE, LAND SURVEYOR, LICENSE NUMBER 2596, EXPIRES DECEMBER 28, 2008.

STATE OF NORTH CAROLINA, ONSLOW COUNTY  
 I, *John L. Pierce*, REVIEW OFFICER OF ONSLOW COUNTY, CERTIFY THAT THE MAP OR PLAT TO WHICH THIS CERTIFICATION IS AFFIXED MEETS ALL STATUTORY REQUIREMENTS FOR RECORDING.  
 DATE: 1/20/06  
 REVIEW OFFICER

Doc ID: 000881100001 Type: CRP  
 Recorded: 01/20/2006 at 04:12:49 PM  
 Fee Amt: \$21.00 Page 1 of 1  
 Onslow County, NC  
 Mildred M Thomas Register of Deeds  
 BK 50 pg 28  
 Slide L-1126  
 REGISTER OF DEEDS

CURVE	CHORD BRG	CHORD	DELTA	RADIUS	ARC	TANGENT
C1	S121°50'00"E	365.31	41°30'00"	557.89	404.09	211.37
C2	N81°30'00"W	73.33	28°40'01"	50.00	231.84	53.93
C3	S121°50'00"E	352.80	41°30'00"	497.89	360.63	188.63
C4	N65°27'38"E	171.87	14°28'23"	682.20	172.33	86.62
C5	S15°14'32"E	73.39	28°34'20"	50.00	231.76	54.02
C6	N32°08'11"W	35.09	1°43'38"	1164.26	35.10	17.55
C7	N30°33'13"W	29.22	1°28'18"	1164.26	29.23	14.61
C20	N31°25'02"W	64.31	3°09'55"	1164.26	64.32	32.17
C21	S28°18'00"E	118.18	13°23'59"	497.89	118.44	58.49
C22	S12°54'00"E	118.18	13°23'59"	497.89	118.44	58.49
C23	S01°08'58"W	127.40	14°42'03"	497.89	127.75	64.23
C24	S28°35'00"W	18.26	42°30'00"	25.00	18.69	9.81
C25	N29°49'44"E	36.66	43°00'33"	50.00	37.53	19.70
C26	N17°42'40"W	43.89	52°04'16"	50.00	45.44	24.43
C27	N74°59'19"W	51.87	82°29'01"	50.00	54.53	30.33
C28	S42°37'53"W	51.71	82°16'37"	50.00	54.35	30.21
C29	S11°25'13"E	38.93	45°49'34"	50.00	39.99	21.13
C30	N12°55'00"W	18.26	42°30'00"	25.00	18.69	9.81
C31	S04°30'34"W	74.74	7°40'33"	557.89	74.79	37.45
C32	S08°18'52"E	138.55	14°15'58"	557.89	138.91	69.82
C33	S20°11'54"E	131.18	13°30'05"	557.89	131.46	66.04
C34	S29°58'28"E	58.89	6°03'03"	557.89	58.92	28.49
C35	N12°42'46"E	28.63	91°25'36"	20.00	31.91	20.50
C36	N65°22'21"E	150.47	13°53'25"	622.20	150.84	75.79
C37	S85°04'10"E	19.23	45°13'35"	25.00	19.73	10.41
C38	S52°20'04"W	17.40	40°43'32"	25.00	17.77	9.28
C39	N71°38'06"E	25.29	2°07'28"	682.20	25.29	12.65
C40	N64°23'54"E	148.75	12°20'56"	682.20	147.03	73.90
C41	N77°23'17"W	27.98	88°48'54"	20.00	30.99	19.58
C42	N32°08'11"W	33.29	1°43'38"	1104.26	33.29	16.64
C45	N89°50'54"W	48.01	54°47'03"	50.00	47.81	25.91
C46	S36°29'48"W	44.25	52°31'33"	50.00	45.84	24.67
C47	S14°44'23"E	42.22	49°56'50"	50.00	43.59	23.29
C48	S85°12'19"E	43.04	50°59'01"	50.00	44.49	23.84
C49	N60°38'14"E	47.97	57°19'53"	50.00	50.03	27.34

DEPARTMENT OF TRANSPORTATION  
 DIVISION OF HIGHWAYS  
 PROPOSED SUBDIVISION ROAD  
 CONSTRUCTION STANDARDS CERTIFICATION  
*R. Avame*  
 APPROVED  
 1/20/06  
 DATE

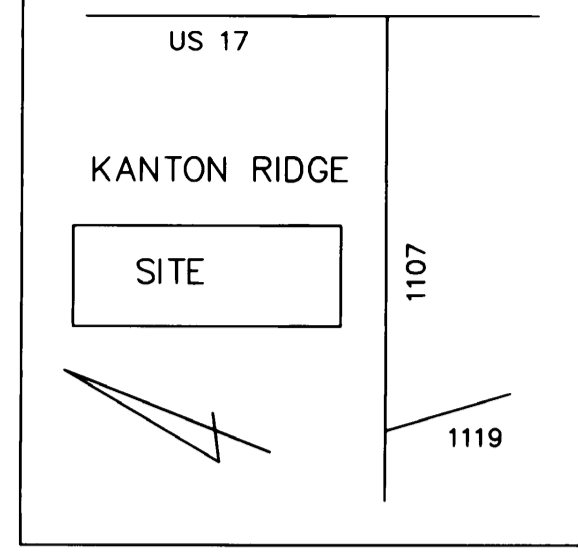

VICINITY MAP - NOT TO SCALE

LINE	BEARING	LENGTH
L1	S58°43'38"W	60.00
L2	N13°41'25"W	39.90
L3	N42°03'37"W	73.68
L4	N00°33'30"W	92.37
L5	N02°12'16"W	118.89
L6	N45°58'36"W	70.70
L7	N05°18'08"E	84.02
L8	N19°28'18"E	128.59
L9	N17°29'50"W	122.62
L10	N03°39'00"E	89.12
L11	N02°22'51"E	76.52
L12	N38°22'36"E	65.78
L13	N18°21'21"E	87.05
L14	N07°33'50"W	114.04
L15	N05°34'51"W	102.71
L16	N21°00'51"W	95.21
L17	N28°05'53"W	94.53
L18	N63°18'24"W	63.40
L19	N05°54'54"W	106.00
L20	N50°33'53"E	122.88
L21	N61°08'08"E	83.28
L22	N74°58'54"E	119.53
L23	N41°42'37"E	141.37
L24	N45°50'44"E	104.35
L25	N28°07'50"E	75.10
L26	N34°07'18"E	93.92
L27	N31°54'12"E	84.63
L28	N78°17'18"E	53.78
L29	S13°03'51"E	70.71
L30	S23°19'41"W	82.66
L31	S23°51'48"W	108.10
L32	S09°48'58"W	82.85
L33	S21°03'52"E	91.24
L34	S60°34'05"E	85.55
L35	N33°00'00"W	95.16
L36	N03°30'00"E	64.59
L37	N08°30'00"E	64.59
L38	N13°17'29"E	58.80
L39	N19°32'59"E	61.13
L40	N15°31'37"E	72.12
L41	N75°55'20"W	20.03
L42	N75°13'14"W	17.09
L43	S77°37'03"E	19.10
L44	N74°28'03"W	77.53
L45	N78°12'11"E	71.36

- NOTES:
- SETBACKS: FRONT - 25'; SIDE STREET, CORNER LOT - 20'; SIDE YARD - 8'; REAR - 15'
  - A PORTION OF THIS PROPERTY IS WITHIN THE 100-YEAR FLOOD PLAIN ACCORDING TO FEMA MAP 370340-4344J, DATED NOV. 3, 2005. THIS PORTION IS IN ZONE AE - THE BALANCE OF THE TRACT IS IN ZONE X.
  - A SMALL PORTION OF THIS PROPERTY IS SUBJECT TO 404 WETLANDS AS SHOWN HEREON. THEIR DELINEATION IS CONSISTENT WITH POLICIES AND REGULATIONS OF THE U.S. ARMY CORPS OF ENGINEERS. LOT OWNERS OF AFFECTED LOTS ARE ADVISED TO CONTACT US ARMY CORPS OF ENGINEERS REGARDING DEVELOPMENT WITHIN THE 404 WETLANDS.
  - ALL LOTS ARE LIMITED TO ONE PRIMARY RESIDENTIAL STRUCTURE.
  - ALL STREETS HEREON ARE INTENDED TO BE DEDICATED FOR PUBLIC USE, BUT HAVE NOT BEEN ACCEPTED AS OF THIS DATE. THE DEPARTMENT OF TRANSPORTATION MAY BE PETITIONED TO ACCEPT STREETS UPON MEETING RESIDENCY REQUIREMENTS OF TWO (2) OCCUPIED HOMES FOR EACH 0.1 MILE OF STREET, PROVIDED 20% OF THE HOMES ARE INDIVIDUALLY OWNED. PROPERTY AND/OR LOT OWNERS ARE RESPONSIBLE FOR MAINTENANCE UNTIL THE STREETS ARE ADDED TO A PUBLIC SYSTEM.
  - LOTS 40A, 43A, 44A, AND 47A REPRESENT NITRIFICATION LOTS FOR RESIDENTIAL LOTS 40, 43, 44, AND 47, RESPECTIVELY. EACH RESIDENTIAL LOT IS TO BE CONVEYED CONCURRENTLY AND PERPETUALLY WITH ITS CORRESPONDING NITRIFICATION LOT.

FINAL PLAT  
 SHOWING  
**KANTON HILLS, SECTION II**  
 STUMP SOUND TOWNSHIP, ONSLOW COUNTY, NC  
 PREPARED FOR  
**SUNSET COVE DEVELOPMENT, INC.**  
 PREPARED BY  
**JOHN L. PIERCE & ASSOCIATES, P.A.**

409 JOHNSON BLVD. JACKSONVILLE, NC 28541  
 PHONE: 910-346-9800 DATE: JANUARY 4, 2006  
 SCALE: 1" = 100'

GRAPHIC SCALE

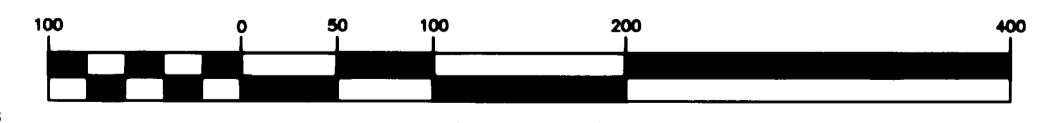

B K 5 0 P 9 2 8