

Book 11
Page 132

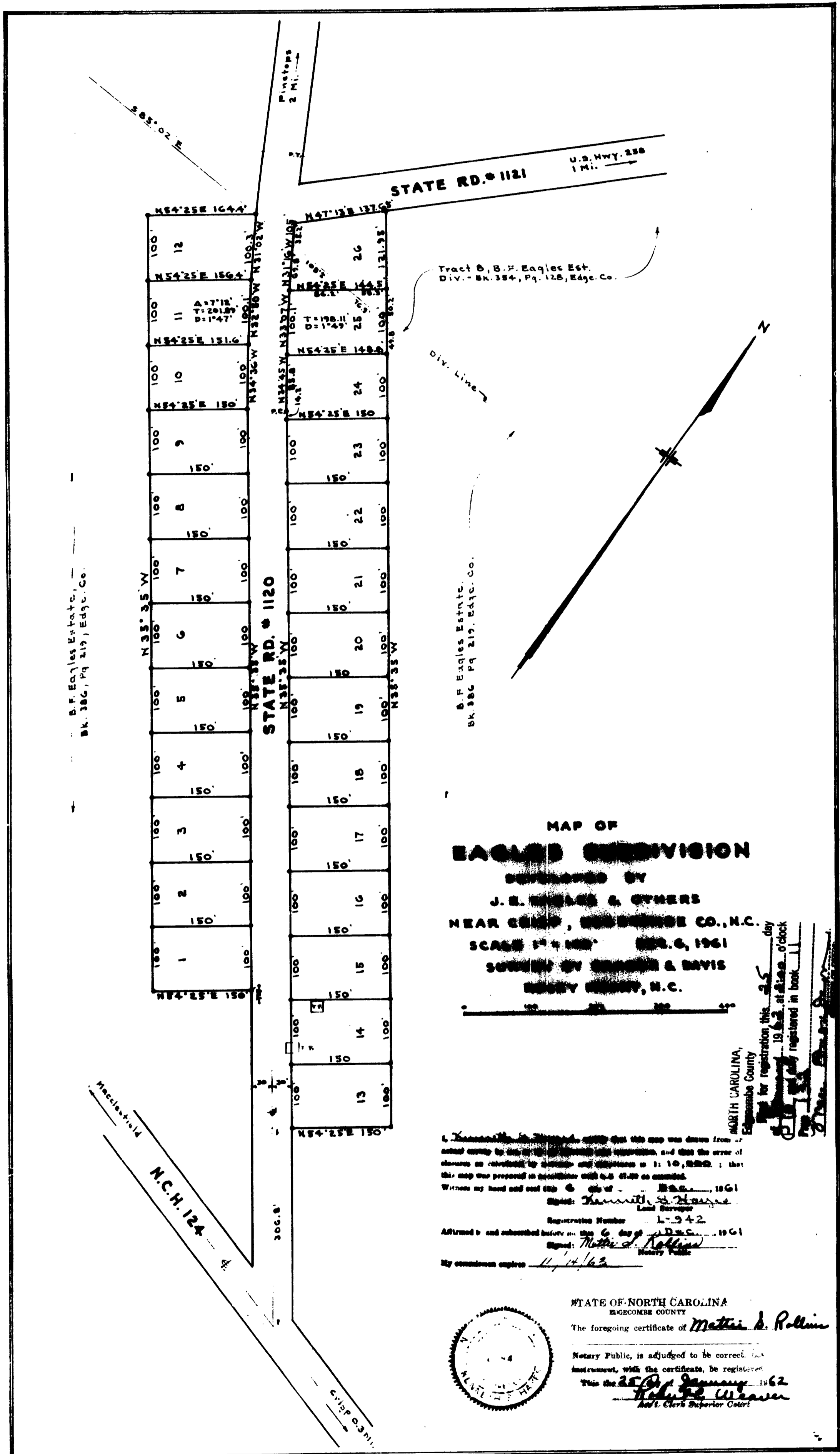

MAP OF
EAGLES SUBDIVISION
 DEVELOPED BY
J. E. EAGLES & OTHERS
 NEAR CAMP, WOODBORO, N.C.
 SCALE 1" = 100' JULY 6, 1961
 SURVEYED BY **BRADY & DAVIS**
 WAREHOUSING, N.C.

I, **Matthew S. Rollins**, Notary Public, do hereby certify that this map was drawn from a correct survey by **Brady & Davis**, Surveyors, and that the area of eleven acres as indicated by bearings and distances is 1.10, 100.00; that this map was prepared in accordance with G.S. 41-20 as amended.
 Witness my hand and seal this 6 day of **July**, 1961
 Signature: **Matthew S. Rollins**
 Land Surveyor
 Registration Number: **L-942**
 Affirmed to and subscribed before me this 6 day of **July**, 1961
 Signed: **Matthew S. Rollins**
 My commission expires **11/1/63**

STATE OF NORTH CAROLINA
 WOODBORO COUNTY
 The foregoing certificate of **Matthew S. Rollins**
 Notary Public, is adjudged to be correct and
 instrument, with the certificate, be registered
 This the **25th** day of **January**, 1962
Robert Weaver
 Not. Clerk Superior Court

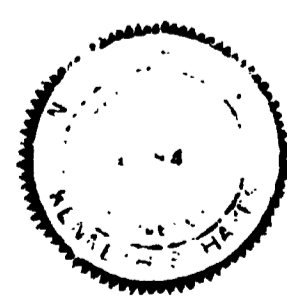

NORTH CAROLINA,
 WOODBORO County
 for registration this **25** day
 of **January**, 1962, at 10:00 o'clock
 A.M. and registered in book **11**
 page **132**