

## Building Sketch (Page - 1)

Client	Amy Mezzanotte - The Legacy Team - Intracoastal Realty		
Property Address	9278 Checkerberry Sq NW		
City	Calabash	County Brunswick	State NC Zip Code 28467
Client	Amy Mezzanotte - The Legacy Team - Intracoastal Realty		

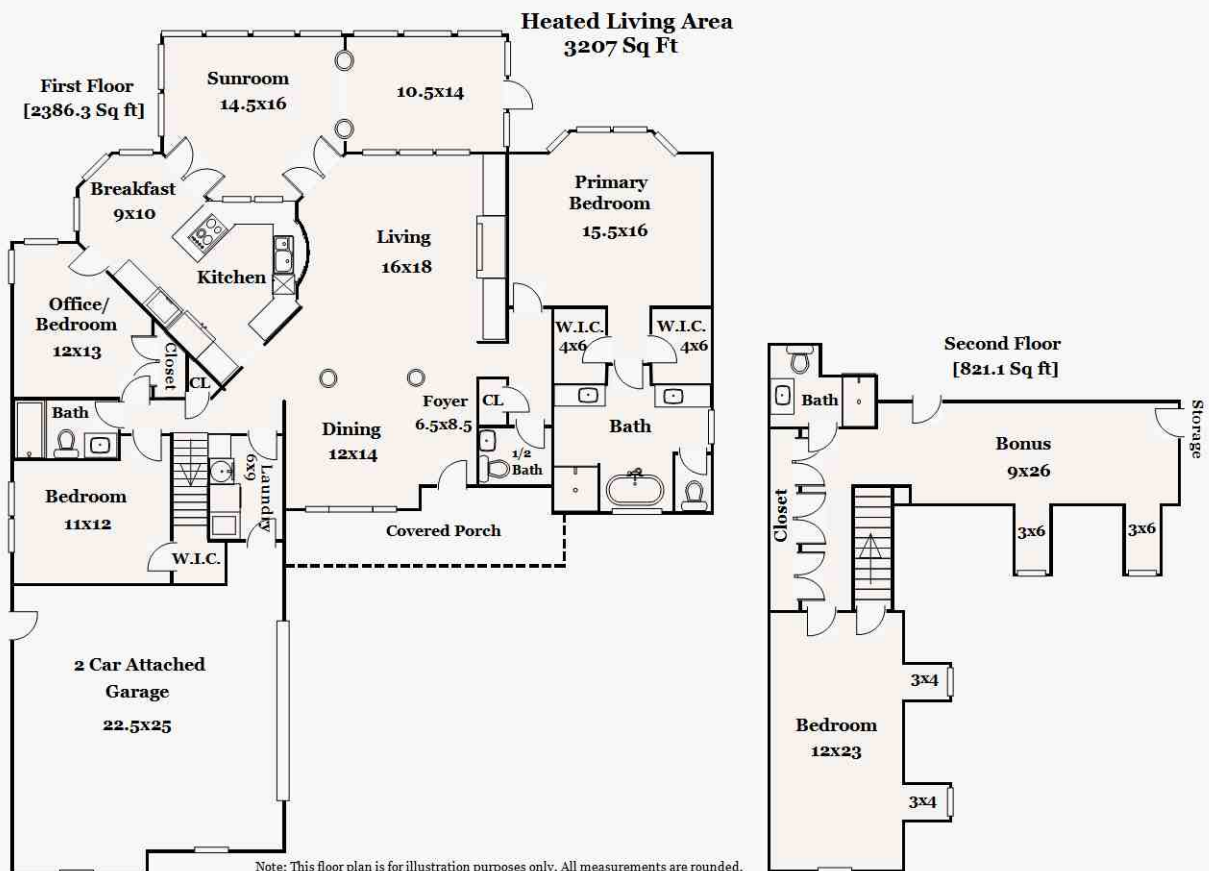

Note: This floor plan is for illustration purposes only. All measurements are rounded. Square footage is based on ANSI measurement standards from exterior dimensions. Floor plan produced by Precision Home Measuring (910) 620-9711

## Building Sketch (Page - 2)

Client	Amy Mezzanotte - The Legacy Team - Intracoastal Realty		
Property Address	9278 Checkerberry Sq NW		
City	Calabash	County Brunswick	State NC Zip Code 28467
Client	Amy Mezzanotte - The Legacy Team - Intracoastal Realty		

TOTAL Sketch by a la mode

### Area Calculations Summary

Living Area	Calculation Details	
First Floor	2386.3 Sq ft	$30.7 \times 10.5 = 322.35$ $0.5 \times 1.98 \times 1.98 = 1.96$ $0.5 \times 1.98 \times 1.98 = 1.96$ $7.3 \times 1.98 = 14.45$ $32 \times 14.2 = 454.4$ $29.6 \times 11.8 = 349.28$ $31.7 \times 12.1 = 383.57$ $19 \times 3.9 = 74.1$ $24.2 \times 26.56 = 642.74$ $7.94 \times 15.36 = 121.97$ $3.04 \times 4.9 = 14.9$ $0.5 \times 3.04 \times 3.04 = 4.62$
Second Floor	821.1 Sq ft	$3.3 \times 6.2 = 20.46$ $3.3 \times 6.2 = 20.46$ $3.3 \times 4.2 = 13.86$ $3.3 \times 4.2 = 13.86$ $4.6 \times 2.8 = 12.88$ $12 \times 23.1 = 277.2$ $11 \times 9.5 = 104.5$ $11.5 \times 9.6 = 110.4$ $9.2 \times 26.9 = 247.48$
<b>Total Living Area (Rounded):</b>	<b>3207 Sq ft</b>	
<b>Non-living Area</b>		
Covered Porch	148.98 Sq ft	$5 \times 12.1 = 60.5$ $7.1 \times 11.8 = 83.78$ $1 \times 4.7 = 4.7$
2 Car Attached	617.82 Sq ft	$5.2 \times 3.9 = 20.28$ $24.2 \times 23.7 = 573.54$ $2 \times 12 = 24$