

## Building Sketch (Page - 1)

|                  |              |        |       |          |
|------------------|--------------|--------|-------|----------|
| Borrower/Client  |              |        |       |          |
| Property Address | 513 Derby Pl |        |       |          |
| City             | Zebulon      | County | State | Zip Code |
| Lender           |              |        |       |          |

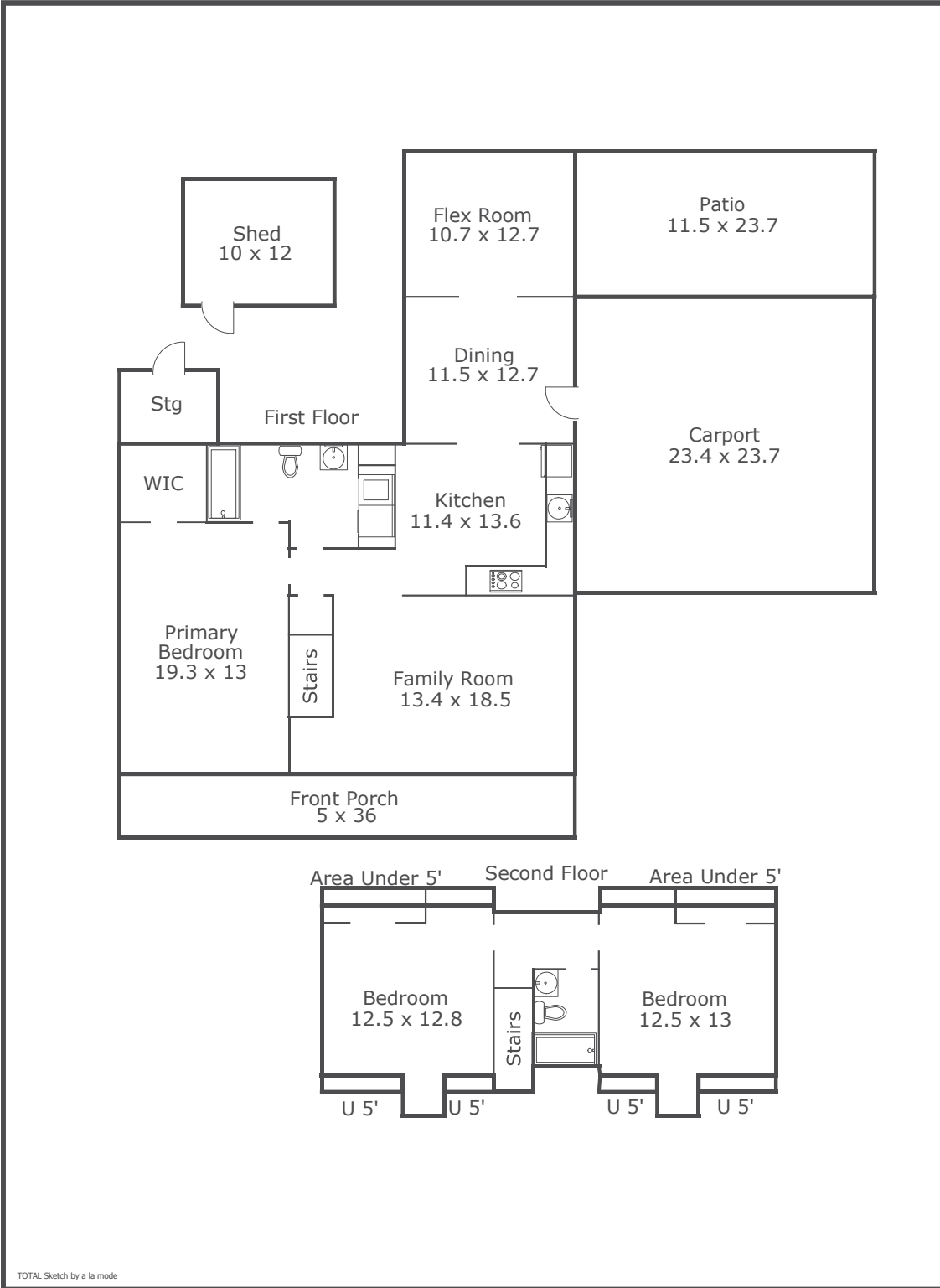

## Building Sketch (Page - 2)

|                  |              |        |       |          |
|------------------|--------------|--------|-------|----------|
| Borrower/Client  |              |        |       |          |
| Property Address | 513 Derby Pl |        |       |          |
| City             | Zebulon      | County | State | Zip Code |
| Lender           |              |        |       |          |

TOTAL Sketch by a la mode

### Area Calculations Summary

| Living Area                         |                   |
|-------------------------------------|-------------------|
| First Floor                         | 1251.4 Sq ft      |
| Second Floor                        | 498.3 Sq ft       |
| <b>Total Living Area (Rounded):</b> | <b>1750 Sq ft</b> |
| Non-living Area                     |                   |
| Carport                             | 554.6 Sq ft       |
| Patio                               | 272.5 Sq ft       |
| Storage                             | 45.2 Sq ft        |
| Front Porch                         | 180 Sq ft         |
| Shed                                | 120 Sq ft         |
| Area Under 5'                       | 5.9 Sq ft         |
| Area Under 5'                       | 19.5 Sq ft        |
| Area Under 5'                       | 5.1 Sq ft         |
| Area Under 5'                       | 8.3 Sq ft         |
| Area Under 5'                       | 19 Sq ft          |
| Area Under 5'                       | 7.9 Sq ft         |