

26

I, F. WADE DAVENPORT, REGISTERED LAND SURVEYOR NO. L-3552, CERTIFY TO THE FOLLOWING:
 THAT THIS PLAT IS OF A SURVEY THAT CREATES A SUBDIVISION OF LAND WITHIN THE AREA OF A COUNTY OR MUNICIPALITY THAT HAS AN ORDINANCE THAT REGULATES PARCELS OF LAND.

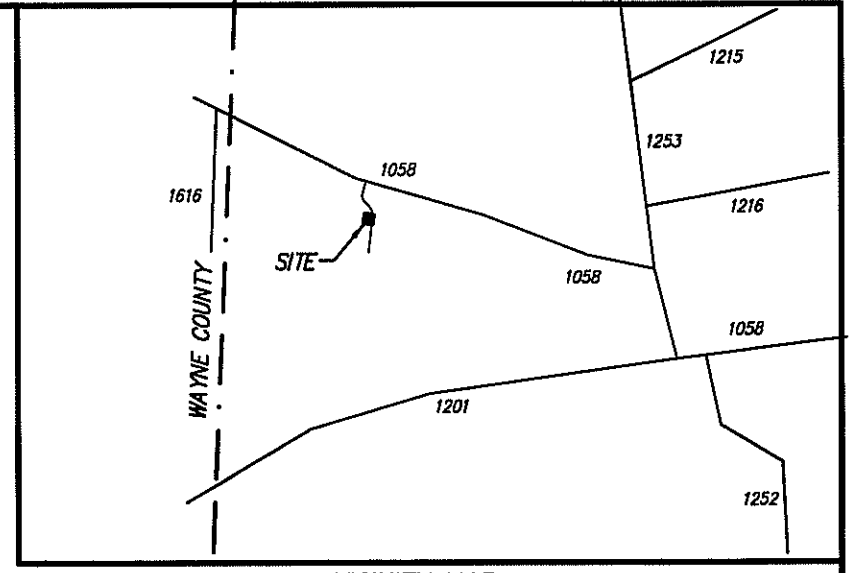

THIS PROPERTY IS LOCATED IN ZONE C AND IS NOT IN A SPECIAL FLOOD HAZARD AREA AS DETERMINED BY SCALING AND GRAPHIC PLOTTING FROM N.F.I.P. RATE MAPS DATED 1-6-83 COMMUNITY PANEL 370378-0035-B

SOURCE OF TITLE
 DB 387, P 193
 MB 11, P 35

CURVE	RADIUS	LENGTH	TANGENT	CHORD	BEARING	DELTA
C-1	125.00'	127.75'	70.08'	122.26'	S 04°52'45" W	58°33'19"
C-2	325.00'	128.00'	64.84'	127.17'	S 13°06'57" E	22°33'54"

LEGEND
 EPK = EXISTING PK NAIL
 EIP = EXISTING IRON PIPE
 O = NO POINT SET
 NIP = NEW IRON PIPE
 R/W = RIGHT OF WAY
 CL = CENTERLINE
 --- = NOT TO SCALE
 N/F = NOW OR FORMERLY

BUILDING SETBACKS
 FRONT - 30'
 SIDE - 10'
 REAR - 10'

NOTE: THIS LOT WILL BE SERVED BY A SEPTIC TANK SYSTEM, COMMUNITY WATER, AND OVERHEAD ELECTRICAL.

J. ISAAC GURLEY FARMS, INC.
 DB 468, P 171
 MB 24, P 70

I HEREBY CERTIFY THAT NO SWINE FARM BUILDING OR SWINE POND / LAGOON IS WITHIN 1500' FROM THE BOUNDARY OF THE 0.918 AC. ± LOT SHOWN HEREON.
 Louise Ginn
 OWNER
 F. Wade Davenport
 SURVEYOR

STATE OF NORTH CAROLINA LENOIR COUNTY
 I, F. WADE DAVENPORT, CERTIFY THAT THIS PLAT WAS DRAWN UNDER MY SUPERVISION FROM AN ACTUAL SURVEY MADE UNDER MY SUPERVISION (DEED DESCRIPTION RECORDED IN BOOK 387, PAGE 193, ETC.) (OTHER); THAT THE BOUNDARIES NOT SURVEYED ARE CLEARLY INDICATED AS DRAWN FROM INFORMATION FOUND IN MB 11, PAGE 35. THE PRECISION RATIO OF PRECISION AS CALCULATED IS 816.0000. THIS PLAT WAS PREPARED IN ACCORDANCE WITH THE STATUTES AS AMENDED. WITNESS MY ORIGINAL SIGNATURE, REGISTRATION NUMBER AND SEAL THIS 12TH DAY OF NOVEMBER 2008.
 F. Wade Davenport
 L-3552

STATE OF NORTH CAROLINA GREENE COUNTY
 I, Richard A. Ellis, REVIEW OFFICER OF GREENE COUNTY, CERTIFY THAT THE MAP OR PLAT TO WHICH THIS CERTIFICATION IS AFFIXED MEETS ALL STATUTORY REQUIREMENTS FOR RECORDING.
 Richard A. Ellis
 REVIEW OFFICER

DATE 6-23-08

ATLANTIC SURVEYING, P.A.
 111 SOUTH QUEEN STREET
 KINSTON, NC 28501
 (252) 527-6994
 (252) 522-2414
 DRAWN BY : R.D.M.
 SCALE : 1" = 100'
 PROJ. NO. : 95292
 DATE : 11-12-02

I (WE) HEREBY CERTIFY THAT I AM (WE ARE) THE OWNER(S) OF THE PROPERTY SHOWN AND DESCRIBED HEREON WHICH WAS CONVEYED TO ME (US) BY DEED RECORDED IN BOOK 387, PAGE 193, AND THAT I (WE) HEREBY ADOPT THIS PLAN OF SUBDIVISION WITH MY (OUR) FREE CONSENT.

I (WE) FURTHER CERTIFY THAT THE LAND AS SHOWN HEREON IS WITHIN THE SUBDIVISION REGULATIONS JURISDICTION OF GREENE COUNTY.

DATE 6-27-08
 Louise Ginn
 OWNERS

I HEREBY CERTIFY THAT THE SUBDIVISION PLAT SHOWN HEREON HAS BEEN FOUND TO COMPLY WITH THE SUBDIVISION REGULATIONS FOR GREENE COUNTY, WITH THE EXCEPTION OF SUCH VARIANCES, IF ANY, AS ARE NOTED IN THE MINUTES OF THE GREENE COUNTY PLANNING BOARD MEETING HELD THIS DATE, AND THAT IT HAS BEEN APPROVED FOR RECORDING IN THE OFFICE OF THE REGISTERS OF DEEDS.

6-27-08
 Philip Harrison
 CHAIRMAN
 GREENE COUNTY PLANNING BOARD

ATTEST: Chas Robison
 CLERK

SURVEY FOR
 LOUISE GINN

BULL HEAD TOWNSHIP NOVEMBER 12, 2002
 GREENE COUNTY NORTH CAROLINA

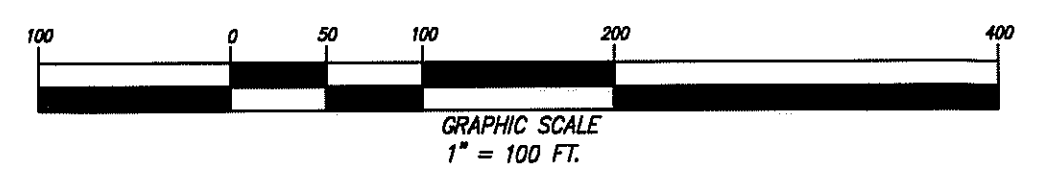

Filed for registration on this 27th day of June 2008 at 12:05 o'clock in Book No 29 Page 26
 Nancy Murphy
 Register of Deeds, Greene County

BY: _____

OWNER: HENRY LEE GINN
 RT. 1, BOX 247
 PIKEVILLE, N.C. 27863

NOTE: THIS IS A MAP OF ONE LOT, CUT OUT OF THE HENRY LEE GINN PROPERTY RECORDED IN DB 387, P 193 OF THE GREENE COUNTY REGISTRY AND IS SHOWN HEREON AS LOT 1.

6-27-08 12:05 p.m.