

Permit # 54885 LRK# 00033098  
Property Address: Lot 5 Tower Street, Southern Pines, N.C. 28388

Page 1 of 4  
Number of Bedrooms: 4



## Moore County Health Department

Environmental Health Section  
PO Box 279, Carthage, NC 27327  
Phone: 910-947-6283 Fax: 910-947-5127

### Improvement Permit

Owner: Koby Robson/ Legacy Home Construction, Inc. Phone # 910-725-1371  
Directions To Property: US HWY 1 South to Valley View at Highland Golf Course, then go approximately one mile and take a right on Tower Street and property is on corner  
Design Flow Units: 4 Bdrms. GPD per Unit: 120 Total Daily Design Flow: 480 gpd  
Waste Strength: Domestic Number of Occupants: 8 Water Supply: Public  
Tri-Party Agreement? Yes:        No: X Easements Required: Yes:        No: X

#### Initial System

Septic Tank Size: 1000 gal Pump Tank Size: N/A gal Max Trench Depth: 33 in  
LTAR: 0.8 Total Trench Length: 150 ft Trench Width: 3 ft  
Media Depth: 12 in System Type: 25% Reuction Distribution Method: Serial

#### Repair System

Septic Tank Size: 1000 gal Pump Tank Size: 1000 gal Max Trench Depth: 33 in  
LTAR: 0.8 Total Trench Length: 150 ft Trench Width: 3 ft  
Media Depth: 12 in System Type: 25% Reduction Distribution Method: Serial

#### Permit Conditions:

- 1) Distance to Water Supplies: Wells, Springs, Etc: >50' Lakes, Streams, Etc.: >50'  
Water Lines: >10' Interceptor/Storm Drains: 10'/15'
- 2) Any underground utilities, irrigation components, accessory structures, or pools shall not be installed within the septic system area or septic repair area.
- 3) Maintain all applicable setbacks to septic system components.

**4) Authorization to Construct will be issued once the re-location of the overhead power lines plan has been submitted.**

Issued By: Russ Kelly Date: 4-15-25

The issuance of this permit in no way guarantees the issuance of other permits. The permit holder is responsible for checking with appropriate governing bodies in meeting their requirements. This permit is subject to revocation if the site plan, plat, or the intended use changes. The Improvement Permit shall not be affected by a change in ownership of the site. This permit is subject to compliance with the provisions of 15A NCAC 18E and to the conditions of this permit. This Permit is Valid for a period of Sixty (60) Months unless the site, site plan, plat, or intended use of the property changes.

### Authorization to Construct Wastewater System

Issued By: \_\_\_\_\_ Date: \_\_\_\_\_

The requirements of 15A NCAC 18E are incorporated by reference into this permit and shall be met. Systems shall be installed in accordance with the attached site sketch. This Construction Authorization is subject to revocation if the site plan, plat, or the intended use changes. The Construction Authorization shall not be affected by a change in ownership of the site. This Construction Authorization is subject to compliance with the provisions of 15A NCAC 18E, or 15A NCAC 18A .1900, as applicable, and to the conditions of this permit. This Authorization is Necessary Prior to Obtaining a Building or Electrical Permit and expires Sixty (60) Months from the date issued or immediately if the site, site plan, or intended use of the property changes.

- Do not grade, compact, or otherwise disturb soil in original system area or repair area
- Property lines/corners must be clearly marked at time of installation and inspection
- Divert downspouts and all surface water from system area
- Install interceptor drain \_\_\_\_\_ inches deep
- Install on contour
- Authorization to construct permit will be issued after receiving final house/site plan
- Six inches of approved soil over nitrification lines required
- Rake trench sidewalls
- Install pipe for copper sulfate. Add copper sulfate in system
- Pump, crush, and fill existing tank
- Filter fabric required
- Seed and straw nitrification lines
- Filter rated for grease removal
- Filter rated for hair removal in wash tank
- Approved and properly rated effluent filter required
- Risers and openings must be sealed with mastic, butyl rubber, and fibered cement or hydraulic cement
- Must test electrical and pump components
- 50 lbs. pressure for two hours on pressure line
- Must water or vacuum test tanks
- Call health department before installing system (910) 947-6284
- Meet health department onsite a minimum of 24 hours before installing system

# Env\_Health\_Editing\_Map

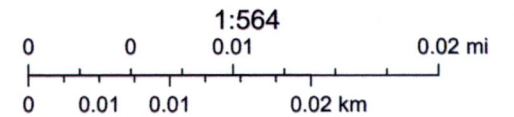
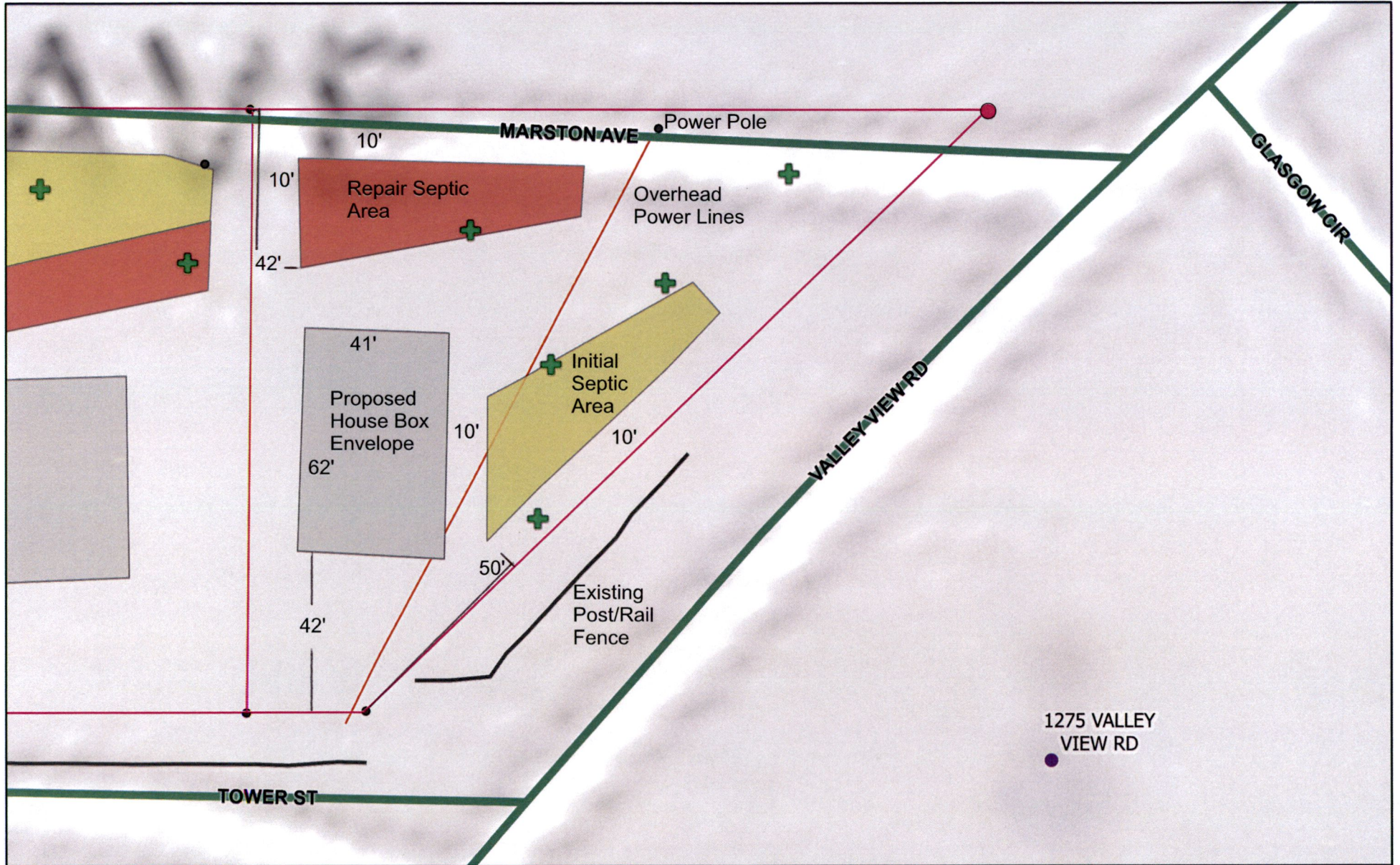

# Env\_Health\_Editing\_Map

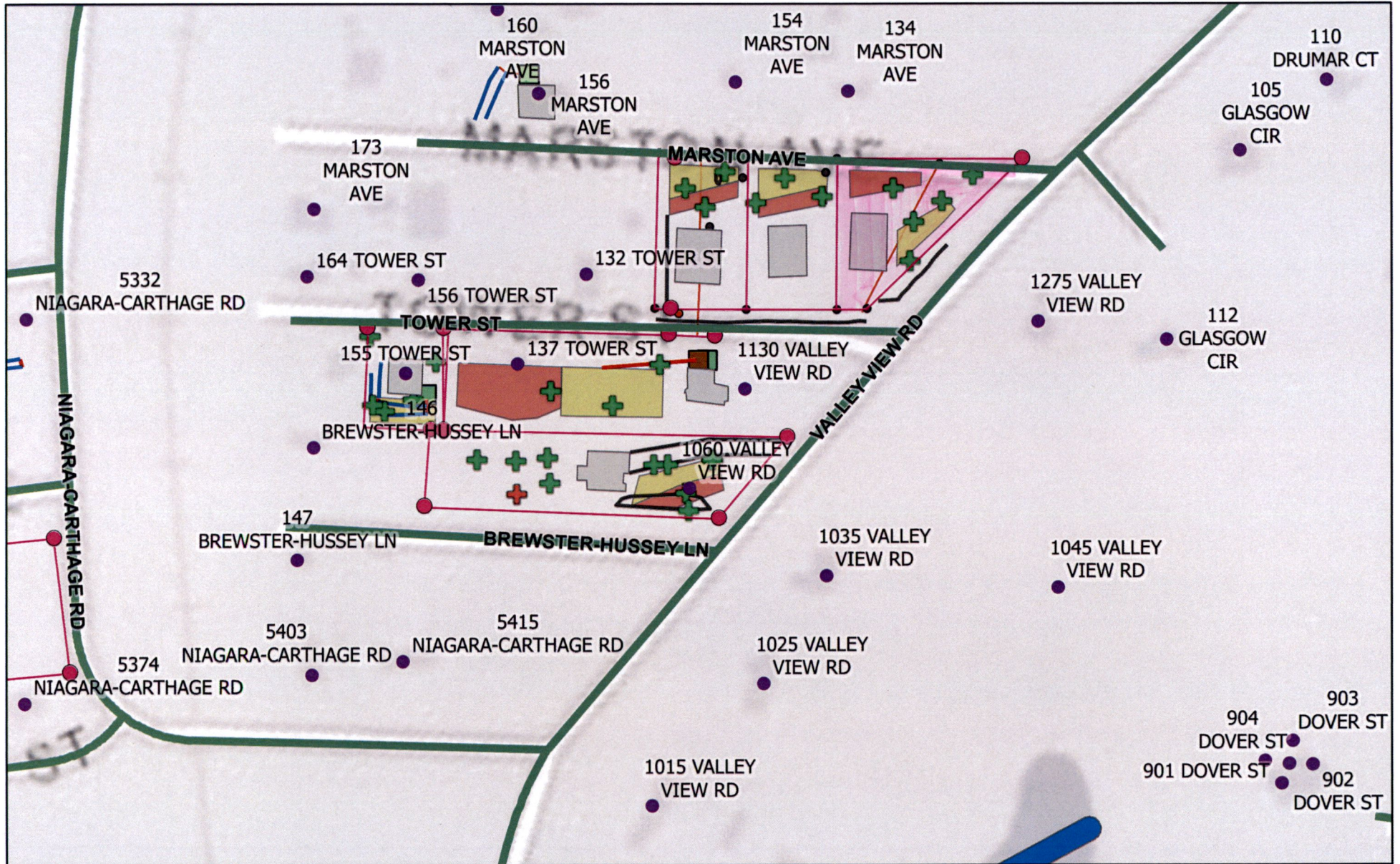

4/15/2025 Page 4 of 4  
IP Permit # 54885

Property Location Map

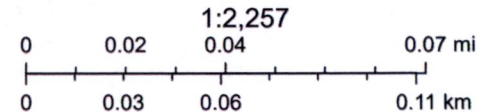

State of North Carolina DOT, State of North Carolina DOT, Esri, HERE, Garmin, GeoTechnologies, Inc., USGS, EPA