

Cherokee County Health Department

228 Hilton Street Murphy, NC 28906 (828) 835-3853

Permit #: 2021000487

Associated PDWW Permit: N/A

SUBSURFACE SEWAGE SYSTEM OPERATIONS PERMIT

New Installation Addition to Existing System Repair
 Single family dwelling(s): 1# Multi-family dwelling Commercial (type): _____

Total Bedrooms: 2 Maximum # Occupants 4 Daily Flow: 240 gpd Zone: MP PIN#: 540900531509000

Property Owner/ Applicant: Nantahala Bank

Property Description: Overlook Brasstown Lot 12

Type of System: LDP-10 (Gravity) Sapolite: No System Class: III f Trench Depth: 18" Trench Width: 12"

Type of Repair: Drip (Pump NSF 40) Sapolite: No System Class: V

Septic Tank: 1000 gal Serial # IM-1000 STB-1060 Pump Tank: NA Serial # NA

Drinking Source: Single Family Well Spring Shared Well/ Spring off-site Public Community

Date IP/CA issued: 09/20/2022 Installer: Tripp Beaver Cert. # 1430

Operator Required? No Maintenance Inspection Required? No

Inspection Frequency: Health Dept.: NA Mgt. Entity: NA Reporting Frequency: NA

The following checked items are on file and are part of this Operations Permit. Application IP/CA Soil Sheet LSS Report Survey Engineer's Drawing

As-Built Diagram (Not to Scale)

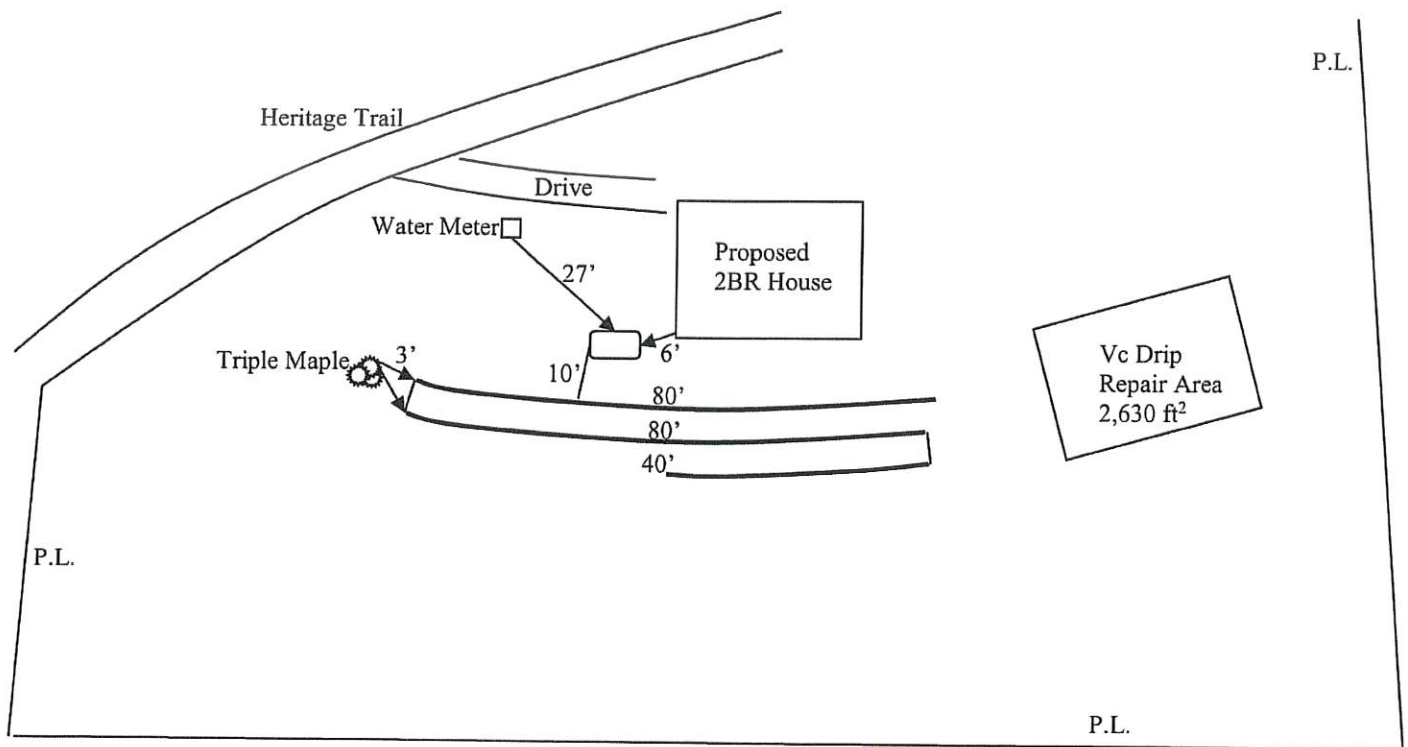

A representative of the Cherokee County Health Department has inspected this sewage disposal system and finds that it conforms to state guidelines. This Permit is issued subject to all the provisions of the North Carolina Laws and Rules for Sewage Treatment and Disposal. **No person is permitted to make alterations to this system without the approval of an authorized Environmental Health Specialist.** This approval indicates that this system has been installed in compliance with the standards as set forth in the above regulations, but shall in no way be taken as a guarantee that the system will function satisfactorily for any given period of time. **The area designated as "repair area" is required for future use and must remain undisturbed.**

Date of Issue: 4/8/2022

Alli Gray, REHS 2765

Authorized State Agent

- IMPROVEMENT PERMIT** (Valid for 60 months from date of issue) (Building permit cannot be issued unless CA is marked)
- CONSTRUCTION AUTHORIZATION** (Expires with Improvement Permit on: 02/24/2016)

This authorization is for a/n _____ to a wastewater system.

Applicant/Owner: **Transcendent, LLC** PIN#: **540900643403000** Zone: **MP** Acreage: **0.4**

Property Description: **Overlook Brasstown Lot # 12A 109** *(12A)*

Facility: **Residential, 2 bedrooms** Basement: **Yes with fixtures**

Design Flow: **240 gpd** Water Supply: **Existing Shared Well** (off-site)

IMPROVEMENT PERMIT

CONSTRUCTION AUTHORIZATION

System: LDP-8 - Gravity Class: III f
 Soil Depth: 29" Saprolite: 0 LTAR: 0.5 Slope: 36%
 Repair: Drip - Pump NSF-40 Class: Vc
 Repair Soil Depth: 19" LTAR: 0.2

Septic Tank: 1000 gal Pump Tank: Not Req'd
 Trench Length: 240' & Spacing: 6' Min (On Center)
 Trench Depth: 10" Max (Low Side) & Width: 12" Max
 Distribution: Equal

Permit Conditions:

Do not disturb designated system areas. Divert all drainage from system areas. Maintain all setbacks. Do not bench
 Installer is responsible for installing lines level and on contour.
MUST ADD 6" OF CLEAN FILL SOIL AFTER DRAINFIELD PRODUCT IS INSTALLED AND STABILIZE.

Diagram (Not to Scale)

Install per LSS report attached submitted by HUFF ENVIRONMNETAL CONSULTING, INC. sealed by David Knox Huff on 02/17/2011

03/15/2011 *(12A)*

Must follow LSS stabilization plan proposal letter attached submitted by HUFF ENVIRONMNETAL CONSULTING, INC dated 02/10/2011.

House and drive must be built to accommodate system and repair.

** LOT NUMBER CHANGED FROM 12A TO 109 EVERY THING ELSE IS THE SAME,*

This permit/authorization is subject to revocation if the information submitted in the application is found to have been incorrect, falsified or changed, the site is altered, or intended use changes; is transferable; and is subject to the provisions of the Laws and Rules for Sewage System Collection, Treatment, and Disposal of the North Carolina Administrative Code. (By signing this document, I accept the specifications of this permit)

Date: 2-24-11 _____ Owner/Legal Reps. Signature

Issue Date: 02/24/2011 Trevor Peterson, REHS 2143 Trevor Peterson *REHS* Authorized State Agent

LOT 12A
± 0.4 AC

Site Location: Lot #12A Overl
 Primary Onsite System Type:
 LTAR: 0.5 gal/ft²
 Design Daily Flow: 240 gallon
 Trench Width: 12 inches (equi
 Total Nitrification Line Length

Repair Area Onsite System T
 Designated Operator: Environ
 LTAR: 0.2 gal/ft²
 Design Daily Flow: 240 gallon
 Trench Width: N/A
 Total Nitrification Field Area:

- Notes & Comments:
- 1) Base Map Source:
 - 2) Borings were locate
 - 3) Site alterations duri
 profile (e.g., grading
 reevaluated to deter
 - 4) Down-spouts and di
 - 5) When trench lines a
 bottom. Smearing c
 picked to expose na
 - 6) The proposed syste
 area. Soil conditio
 meet or exceed the)
 - 7) The upland soils ob
 dip of the underlyin
 Department of Agri
 2006. U.S. Departm
 system type(s) is co
 Carolina Administr
 site improvements &
 installation or confi
 - 8) This soil survey ma
 map does not exten
 Consulting, Inc. nar

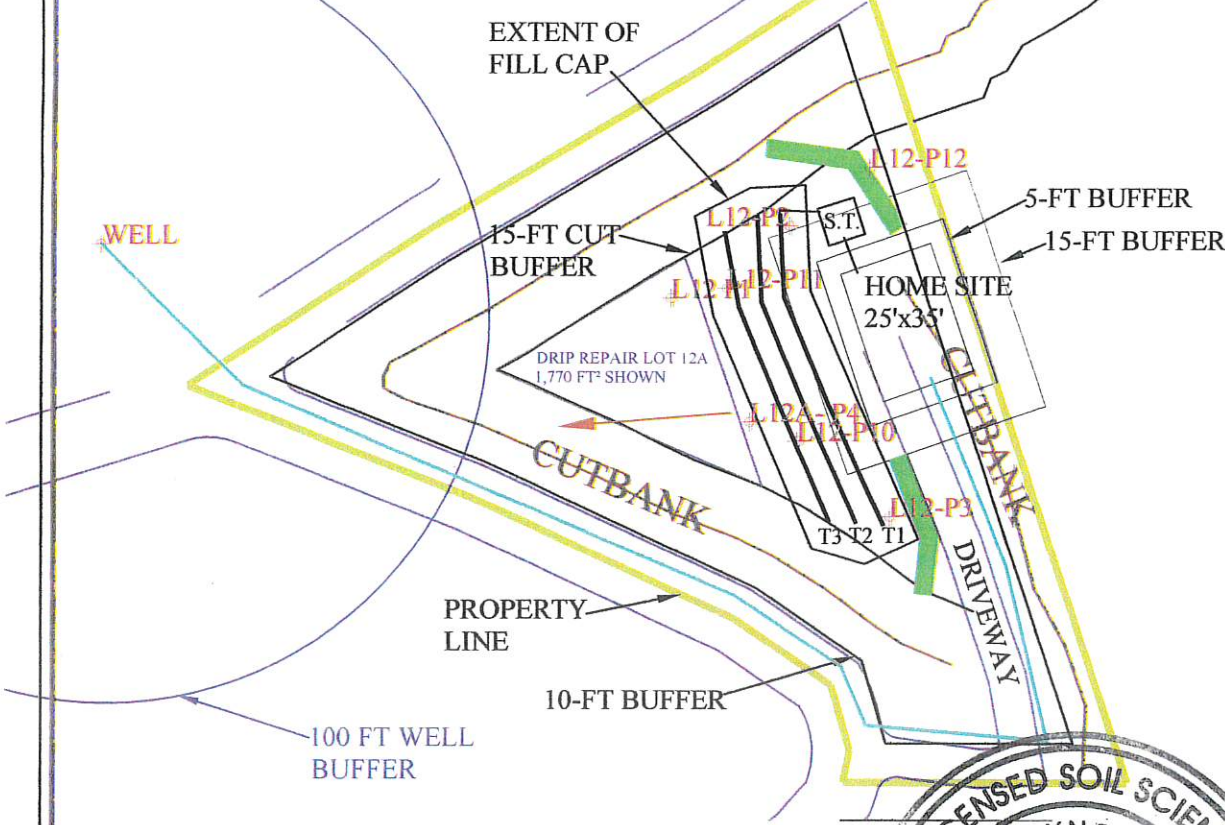

PRIMARY ONSITE SYSTEM LOT 12A
 8" LDP ULTRA SHALLOW - 250 FEET
 T1 - 85'l x 12"w x 10"d x 6' o.c.
 T2 - 85'l x 12"w x 10"d x 6' o.c.
 T3 - 80'l x 12"w x 10"d x 6' o.c.

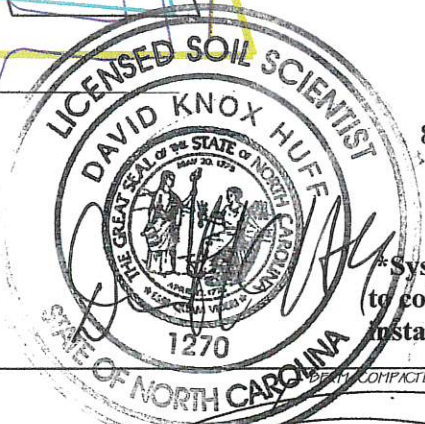

*System components repr
 to confirm the general layo
 installation to ensure prop

LEGEND	
	GPS DATA POINT
	PRIMARY SYSTEM
	DRIP REPAIR AREA
	DOWN-SLOPE DIRECTION
	PROPOSED WATER LINE
	DIVERSION
	SEPTIC TANK

