

**Environmental Health  
Pitt County Government  
Backlog Permit File Scanning Separator Page  
Template**

«BRITTNEY\_DANIELS»

11/1/2021

For Barcode Fields, use underscore ( \_ ) for spaces and include \* before and after entry. Exp: \*01732\*

**Permit #:** <

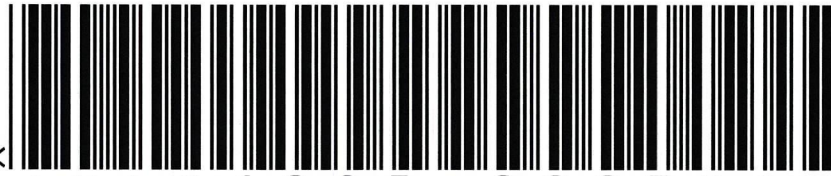

\* W L S 1 9 8 7 - 0 0 0 3 2 1 \*

>

PITT COUNTY HEALTH DEPARTMENT

1825 West Fifth Street  
Greenville, North Carolina 27834

New  Existing \_\_\_\_\_ Repair \_\_\_\_\_

Permit No. 321-87-E

CERTIFICATE OF COMPLETION (COMPLIANCE)

Ground Absorption Sewage Disposal System (Septic Tanks)  
N. C. General Statutes, Chapter 130A-Article 11

Sketch of Layout

Date 5-22-87 PN 44992

Owner Roland Williams (for David Inasure)  
well

Address S.R. 1751

Type of Use: Residence House # Bedrooms 3  
Other \_\_\_\_\_ # Users \_\_\_\_\_

Tank: Capacity 1000+1000 Mfgt. AAA Serial # STB-15

Distance From House 10'

Drain Lines: Sq. Ft. 1500 # Lines 5 Width 36"

Depth of Surface 6"-8"

Drainage: Required  Completed

Water Supply Well

Installed by Curtis Matthews

Inspected by Charles J. Johnson  
Sanitarian

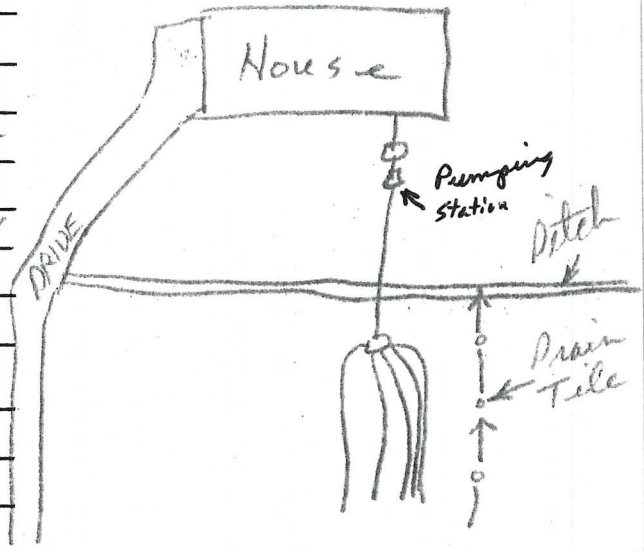

Suitable  
Provisionally Suitable  
Unsuitable

PITT COUNTY HEALTH DEPARTMENT  
ENVIRONMENTAL HEALTH DIVISION  
1825 West Sixth Street  
Greenville, N.C. 27834 - Phone: 752-4141

3:30  
C. Matthews Existing  
New   
Repair

APPLICATION

Article 11 of Chapter 130A of The General Statutes of North Carolina PN 44792  
2554 Dec Leflin Rd

Date Received 2/27/87  
Owner Roland Williams for David Trasure  
Address 1508 Hooker Rd City Greenville Zip \_\_\_\_\_  
Subdivision Name \_\_\_\_\_ Lot No. \_\_\_\_\_ Block No. \_\_\_\_\_

In Reply Please Refer To:  
Permit Number 301-87  
Phone 755-5049

Directions SR 1751 County Home Rd to Veterans X rds turn left  
op to 1st rd. Turn left. immediately turn right. op 1 mile  
on right. lot enclosed with white fence around lot  
Land Use house Bedrooms 3 Water Supply well  
Plat Required: Yes \_\_\_\_\_ No \_\_\_\_\_

\*\*\* This is an official document. Please retain with other valuable papers.

Roland Williams  
Owner's Signature or Agent

IMPROVEMENT PERMIT

Site Classification Information:  
Topography S Soil Texture PS  
Soil Structure PS Soil Depth S  
Restrictive Horizon: S  
Soil Drainage: Internal PS External S  
Soil Permeability \_\_\_\_\_  
Other \_\_\_\_\_ Estimated Flow 360

Septic Tank Capacity 1000  
Nitrification Square Footage 1500  
Land Requirements drain tile as shown attract 4" deep

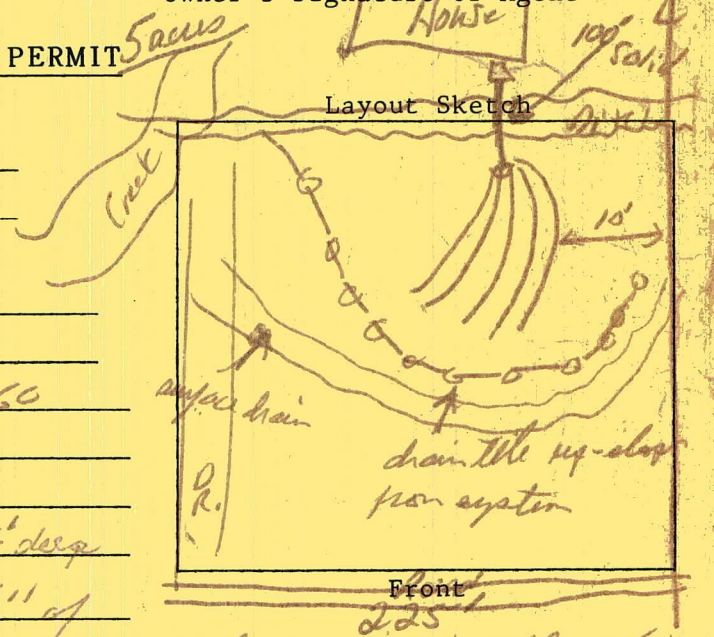

Comments Keep rock in lines within 6" of soil surface. Start of lines may be deeper but maintain atleast 6" on end of lines due to slope on lot. Locate all existing drain tile and re-route if possible or cut off. Keep system on high side of lot. Drain tile must be installed and the drainage form signed before final approval. Also a surface drain must be constructed up-slope from system to direct all

Date Issued 3-5-87 By Ernie Tucker Sanitarian  
surface water before final approval.

Septic Tank Approval  
Date Approved 5-22-87 By Charles J. Lehmann Sanitarian

Roland Williams  
Permit # 321-87

CERTIFICATION STATEMENT  
Subsurface Drainage

Name of drain tubing manufacturer: P.T.I.

Material used for cover or filter: None

Outlet Pipe: Length 10' Type PVC Size 6"

Outlet Clearance 6"

Animal Guard Installed: Yes  No

Proper Surface Water Diversion: Yes  No

Sketch of System  
(show length and size of each line)

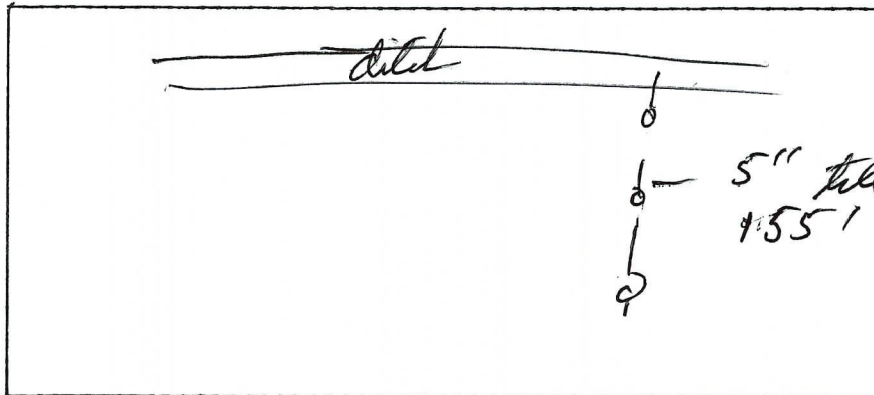

I certify that this drainage has been completed in accordance with the drawing and specifications furnished to me. Exceptions, if any, are listed below:

None

---

---

---

---

Contractor's signature:

Curtis Matthews

Date: 5-22-87

Landowner's signature:

\_\_\_\_\_

Date: \_\_\_\_\_

Ray Roberts (Realtor)

PN 44792

321-87-E

(Walter Davis says the septic system is off the property 11-9-01)

# Pitt County Environmental Health

Bolland Williams

2554 Doc Loftin Rd  
Ayden

1717 W. Fifth St.  
Greenville, NC 27834  
413-1253

~~Cannon~~ ~~Ac Gowan~~ ~~St~~  
for David Frasure?

1987



Permit # \_\_\_\_\_

house is 18 yrs old



**An Authorization to Construct a wastewater system must be obtained from the Environmental Health Division before construction of the wastewater system begins.**

This map is furnished by PITT COUNTY for illustration purposes only. This map is NOT a certified survey.

# Pitt County Environmental Health

## Soil Series

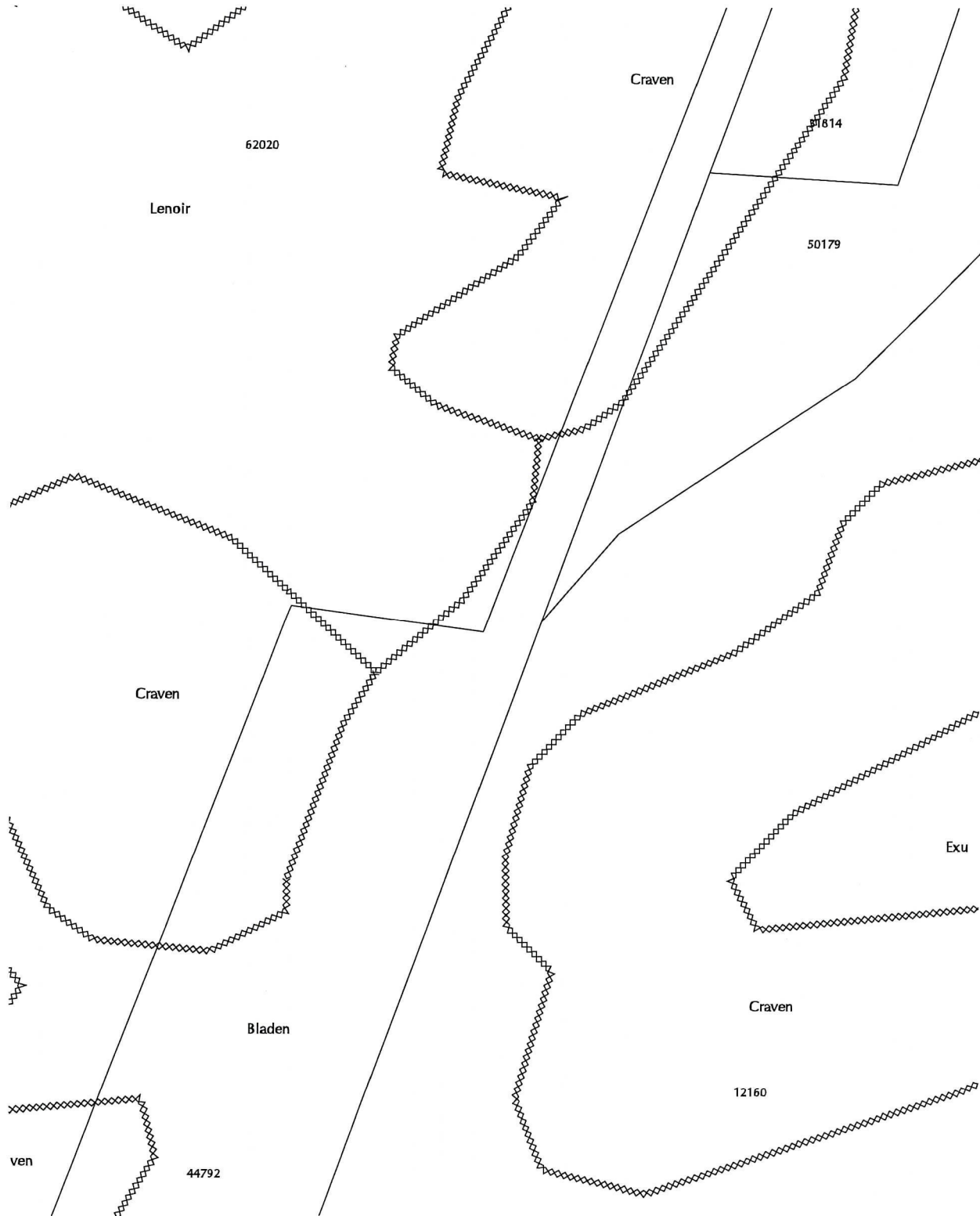

1" = 155'



**PITT COUNTY  
HEALTH DEPARTMENT  
ENVIRONMENTAL HEALTH DIVISION**  
1717 W. 5<sup>TH</sup> STREET  
GREENVILLE, NORTH CAROLINA 27834-1696

TELEPHONE: (252) 902-3200

**REVIEW OF TYPE III-B SEWAGE DISPOSAL SYSTEM**

In accordance with Rule .1961(b) of LAWS AND RULES FOR SEWAGE TREATMENT, AND DISPOSAL SYSTEMS, Article 11, Chapter 130A of NCGS 15A NCAC 18A .1900 et seq, the local health department is required to inspect septic systems which use a single effluent pump or single siphon every five years. The details of this inspection and any necessary maintenance requirements are detailed below.

Owner Michael Marshall Parcel# 44792 Operation Permit # 321-87  
System Location Address 2554 Doc Loftin Rd Inspection Date 10-15-08  
Mailing Address 2554 Doc Loftin Rd Ayden, NC 28513

TANK:

Pump tank and risers visibly sound	<i>N/A</i>	Y	N
Surface water diverted away from tanks		Y	N
Risers accessible and extend at least 6 inches above finished grade		Y	N
Riser joined to the tank top and sealed to prevent water entrance		Y	N

*System installed in 1987 before riser's needed*

DOSING SYSTEM:

Floats operating properly, no excessive buildup preventing flotation	(Y)	N
Float tree or bracket corrosion resistant and in good working condition	(Y)	N
Quick disconnect union in good working order	(Y)	N
Pipes and connections in good condition and not leaking	(Y)	N
Pump lift chain or rope corrosion resistant and in good condition	(Y)	N
Wiring inside tank free of splices	(Y)	N
Gate valve in pump tank intact and accessible	Y	N

(N/A)

CONTROL PANEL:

Audible and visible high water alarm present and operating properly	(Y)	N
Control panel enclosures/components in good condition	(Y)	N
Conduit into enclosure box sealed against corrosive gases	(Y)	N
Elapsed Time Meter reading		hrs

(N/A)

NITIFICATION FIELDS:

Surface water diverted from drainfield area, no depressions on drainfield	(Y)	N
Vegetative cover adequate and maintained properly	(Y)	N
Ditches, swales, diversions, tile drains, etc., properly maintained	(Y)	N
Protected from traffic and destructive uses	(Y)	N
Repair area properly reserved and maintained	(Y)	N
Valve at field intact, protected and accessible	(Y)	N
Manifold cleanout intact, protected, and accessible	(Y)	N
Nitrification field shows no signs of effluent surfacing	(Y)	N

N/A