

# Halifax County, NC

## Summary

**Parcel Number** 1101075  
**Location Address** 607 E 9TH ST  
**Legal Description** H E 9TH ST  
**Property Class** R - RESIDENTIAL  
**Neighborhood** R104  
**Land Use Code** (510) R - SINGLE FAMILY DWELLING, PLATTED LOT  
**Township** SCOTLAND NECK Township  
**Reval Route** 11C08\_32  
**Acres** 0.3076  
**Subdivision**  
**PIN (ALT-ID)** 4866-08-88-2556  
**Topography** LEVEL  
**Street Type** PAVED  
**Utilities** ALL PUBLIC  
**Deed Book** 2725  
**Page** 162

[View Map](#)

## Tax Bill

2025 Tax Bill (PDF)

## Owner

Lunnon, Orlando  
 1717 KINGS CIRCLE  
 ROCKY MOUNT NC 27801

Owner Info Last Updated 4/26/2024

## Valuation

Disclaimer: The assessed values are for informational purposes only and are subject to change. Please call (252) 583-2121 to verify.

	2025	2024	2023	2022	2021	2020
+ Appraised Land	\$4,800	\$4,800	\$4,800	\$4,800	\$4,800	\$4,800
- Land Deferment	\$0	\$0	\$0	\$0	\$0	\$0
= Total Assessed Land	\$0	\$0	\$0	\$0	\$0	\$0
+ Assessed Building	\$40,100	\$40,100	\$29,200	\$29,200	\$29,200	\$29,200
= Total Assessed Value	\$44,900	\$44,900	\$34,000	\$34,000	\$34,000	\$34,000

## Land

Description	Land Type	Land Code	Sq. ft.	Acres	Price
HOMESITE	S	1	13,400	0.3076	\$4,840

**Total Acres:**  
 0.3076  
**Total Land-Value:**  
 \$4,840

## Dwelling Description

**Card 1**  
**Stories** 1  
**Exterior Wall** FRAME  
**Style** CONVENTIONAL  
**YB/Remodeled/EYB** 1950/0/1968  
**Ground Floor Area** 1124  
**Finished Bsmt Sqft** CRAWL  
**Physical Condition** AVERAGE  
**Grade** D+- BELOW AVERAGE +  
**Total Rooms** 5  
**Bedrooms** 3  
**Full Bath/Half Bath** 1/0  
**Attic** NONE  
**Add'l Fixtures** 0  
**System** FORCED AIR  
**Heating System** CENTRAL W/ AC  
**Total Fixtures** 5  
**Fuel Type** GAS  
**Int/Ext** 2  
**Mason Trim Area** 0  
**Prefab Fireplace** 0  
**Split Level/Foyer** A  
**Unfinished Area** 0  
**Rec. Room Area** 0  
**WBFP Stacks/Opening** 1 / 1  
**Bsmt. Gar. (No Cars)**  
**MSC O.F.DES/Quan** /0  
**MSC O.F.DES/Quan** /0  
**S.F.L.A.** 1124  
**Physical Cond** 0  
**Value** 39200

**Other Building & Yard Improvements**

Card 1

Description	Year Built	Area	Grade	Value	Type	Quan.	Size	Mods	Cond	F	MD%
PAVING CON	1980	528	D-BELOW AVERAGE	\$900	PA3	1	24 x 22		F		0

**Sales**

Sale Date	Sale Price	Instrument	Deed Book	Deed Page	Owner	Previous Owner	Recording
2/7/2023	\$45,000	WD	2725	162	LUNNON, OLANDO	MOE, SAMANTHA T	2725 162
3/25/2021	\$35,000	WD	2651	704	MOE, SAMANTHA T	WILLIAMS, EULA	2651 704

**Sketches**

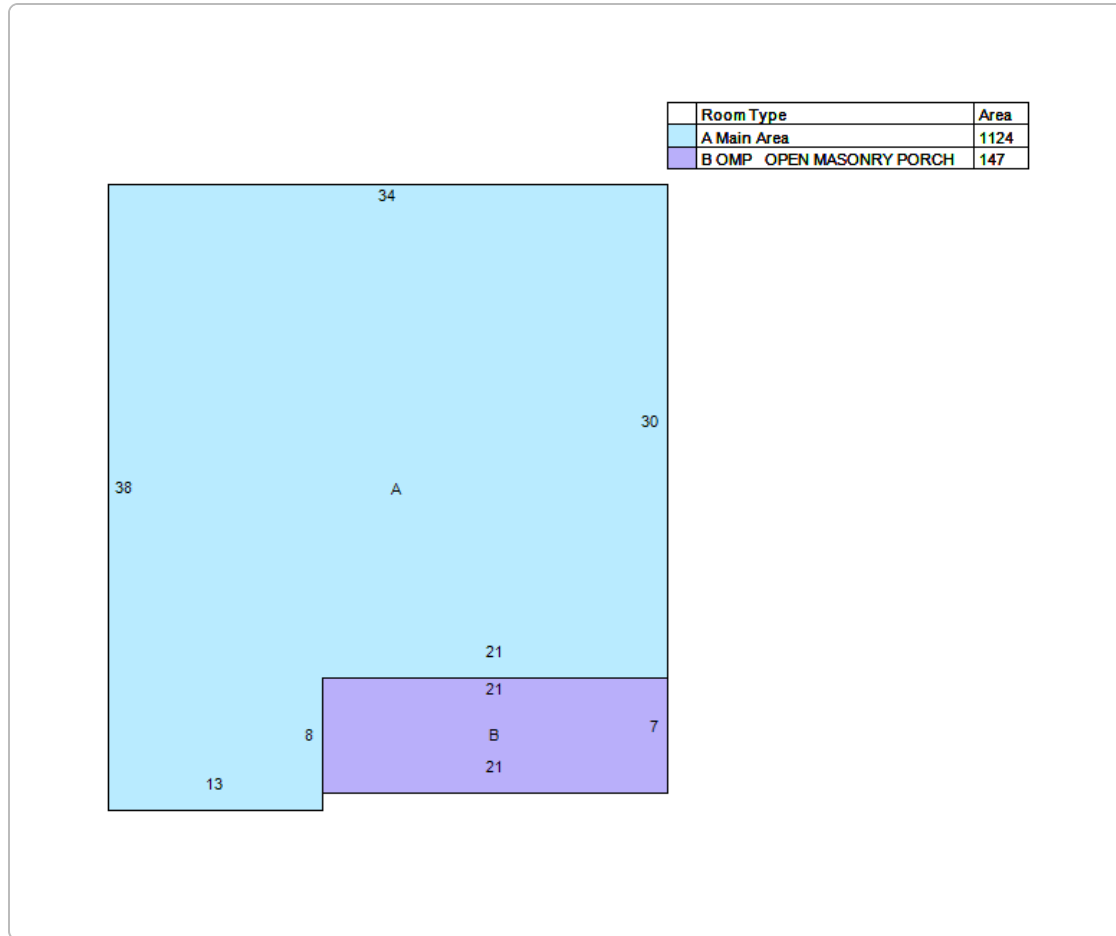

**Property Tax Relief**

Apply for Property Tax Relief

**Present-Use Value**

Apply for Present-Use Value

**Mailing Address Change**

Address Change

**Abstract**

Abstract (PDF)

**Sales Questionnaire Form**

Would you like to submit a Sales Questionnaire?

Sales Questionnaire Form

No data available for the following modules: Building Description, Other Features, Interior/Exterior Information, Permits.

Halifax County makes every effort to produce the most accurate information possible. No warranties, expressed or implied, are provided for the data herein, its use or interpretation. Tax parcel data is for the 2025 tax year. In other words, the records reflect the tax listing for the 2024 tax bills and recorded documents for the period between January 1 and December 31, 2024. Maps are for illustrative purposes only and are NOT legal documents.  
[| User Privacy Policy](#) | [GDPR Privacy Notice](#)  
[Last Data Upload: 10/1/2025, 5:28:39 AM](#)

Contact Us

