



**STATE OF NORTH CAROLINA
MINERAL AND OIL AND GAS RIGHTS MANDATORY DISCLOSURE STATEMENT**

Instructions to Property Owners

1. The Residential Property Disclosure Act (G.S. 47E) ("Disclosure Act") requires owners of certain residential real estate such as single-family homes, individual condominiums, townhouses, and the like, and buildings with up to four dwelling units, to furnish purchasers a Mineral and Oil and Gas Rights Disclosure Statement ("Disclosure Statement"). This form is the only one approved for this purpose.
2. A disclosure statement is not required for some transactions. For a complete list of exemptions, see G.S. 47E-2(a). **A DISCLOSURE STATEMENT IS REQUIRED FOR THE TRANSFERS IDENTIFIED IN G.S. 47E-2(b)**, including transfers involving the first sale of a dwelling never inhabited, lease with option to purchase contracts where the lessee occupies or intends to occupy the dwelling, and transfers between parties when both parties agree not to provide the Residential Property and Owner's Association Disclosure Statement.
3. You must respond to each of the following by placing a check in the appropriate box.

MINERAL AND OIL AND GAS RIGHTS DISCLOSURE

Mineral rights and/ or oil and gas rights can be severed from the title to real property by conveyance (deed) of the mineral rights and/ or oil and gas rights from the owner or by reservation of the mineral rights and/ or oil and gas rights by the owner. If mineral rights and/ or oil and gas rights are or will be severed from the property, the owner of those rights may have the perpetual right to drill, mine, explore, and remove any of the subsurface mineral and/or oil or gas resources on or from the property either directly from the surface of the property or from a nearby location. With regard to the severance of mineral rights and/or oil and gas rights, Seller makes the following disclosures:

	Yes	No	No Representation
<u> </u> Buyer Initials	<input type="checkbox"/>	<input type="checkbox"/>	<input checked="" type="checkbox"/>
1. Mineral rights were severed from the property by a previous owner.			
<u> </u> Buyer Initials	<input type="checkbox"/>	<input checked="" type="checkbox"/>	
2. Seller has severed the mineral rights from the property.			
<u> </u> Buyer Initials	<input type="checkbox"/>	<input checked="" type="checkbox"/>	
3. Seller intends to sever the mineral rights from the property prior to transfer of title to the Buyer.			
<u> </u> Buyer Initials	<input type="checkbox"/>	<input type="checkbox"/>	<input checked="" type="checkbox"/>
4. Oil and gas rights were severed from the property by a previous owner.			
<u> </u> Buyer Initials	<input type="checkbox"/>	<input checked="" type="checkbox"/>	
5. Seller has severed the oil and gas rights from the property.			
<u> </u> Buyer Initials	<input type="checkbox"/>	<input checked="" type="checkbox"/>	
6. Seller intends to sever the oil and gas rights from the property prior to transfer of title to Buyer.			

Note to Purchasers

If the owner does not give you a Mineral and Oil and Gas Rights Disclosure Statement by the time you make your offer to purchase the property, or exercise an option to purchase the property pursuant to a lease with an option to purchase, you may under certain conditions cancel any resulting contract without penalty to you as the purchaser. To cancel the contract, you must personally deliver or mail written notice of your decision to cancel to the owner or the owner's agent within three calendar days following your receipt of this Disclosure Statement, or three calendar days following the date of the contract, whichever occurs first. However, in no event does the Disclosure Act permit you to cancel a contract after settlement of the transaction or (in the case of a sale or exchange) after you have occupied the property, whichever occurs first.

Property Address: **1117 Rosedale Avenue, Rocky Mount, NC 27804**

Owner's Name(s): **Jatinkumar K Patel, Divva J. Patel**

Owner(s) acknowledge having examined this Disclosure Statement before signing and that all information is true and correct as of the date signed.

Signed by:
 Owner Signature: Jatinkumar K. Patel **Jatinkumar K Patel** Date 4/21/2025
 Owner Signature: Divva J. Patel **Divva J. Patel** Date 4/21/2025

Purchaser(s) acknowledge receipt of a copy of this Disclosure Statement; that they have examined it before signing; that they understand that this is not a warranty by owner or owner's agent; and that the representations are made by the owner and not the owner's agent(s) or subagent(s).

Purchaser Signature: _____ Date _____
 Purchaser Signature: _____ Date _____



Residential Property And Owners' Association Disclosure Statement

Protecting the Public Interest in Real Estate Brokerage Transactions

Property Address/Description: 1117 Rosedale Avenue, Rocky Mount, NC 27804

Owner's Name(s): Jatinkumar K Patel, Divya J. Patel

North Carolina law N.C.G.S. 47E requires residential property owners to complete this Disclosure Statement and provide it to the buyer prior to any offer to purchase.

An owner is required to provide a response to every question by selecting Yes (Y), No (N), No Representation (NR), or Not Applicable (NA).

- If an owner selects Y or N, the owner is only obligated to disclose information about which they have actual knowledge. If an owner selects Y in response to any question about a problem, the owner must provide a written explanation or attach a report from an attorney, engineer, contractor, pest control operator, or other expert or public agency describing it.

For purposes of completing this Disclosure Statement: "Dwelling" means any structure intended for human habitation, "Property" means any structure intended for human habitation and the tract of land, and "Not Applicable" means the item does not apply to the property or exist on the property.

OWNERS: The owner must give a completed and signed Disclosure Statement to the buyer no later than the time the buyer makes an offer to purchase property. If the owner does not, the buyer can, under certain conditions, cancel any resulting contract.

The owner should keep a copy signed by the buyer for their records. If something happens to make the Disclosure Statement incorrect or inaccurate (for example, the roof begins to leak), the owner must promptly give the buyer an updated Disclosure Statement or correct the problem.

BUYERS: The owner's responses contained in this Disclosure Statement are not a warranty and should not be a substitute for conducting a careful and independent evaluation of the property. Buyers are strongly encouraged to:

- Carefully review the entire Disclosure Statement.
Obtain their own inspections from a licensed home inspector and/or other professional.

DO NOT assume that an answer of N or NR is a guarantee of no defect. If an owner selects N, that means the owner has no actual knowledge of any defects. It does not mean that a defect does not exist. If an owner selects NR, it could mean the owner (1) has knowledge of an issue and chooses not to disclose it, or (2) simply does not know.

BROKERS: A licensed real estate broker shall furnish their seller-client with a Disclosure Statement for the seller to complete in connection with the transaction. A broker shall obtain a completed copy of the Disclosure Statement and provide it to their buyer-client to review and sign.

- Brokers are NOT permitted to complete this Disclosure Statement on behalf of their seller-clients.
Brokers who own the property may select NR in this Disclosure Statement but are obligated to disclose material facts they know or reasonably should know about the property.

Buyer Initials _____ Owner Initials JP, DP
Buyer Initials _____ Owner Initials JP, DP

REC 4.22
REV 5/24 1

**SECTION A.
STRUCTURE/FLOORS/WALLS/CEILING/WINDOW/ROOF**

	Yes	No	NR																																																																											
A1. Is the property currently owner-occupied? Date owner acquired the property: _____ If not owner-occupied, how long has it been since the owner occupied the property? _____	<input type="checkbox"/>	<input checked="" type="checkbox"/>	<input type="checkbox"/>																																																																											
A2. In what year was the dwelling constructed? <u>2004</u>			<input type="checkbox"/>																																																																											
A3. Have there been any structural additions or other structural or mechanical changes to the dwelling(s)?	<input type="checkbox"/>	<input checked="" type="checkbox"/>	<input type="checkbox"/>																																																																											
A4. The dwelling's exterior walls are made of what type of material? (Check all that apply) <input checked="" type="checkbox"/> Brick Veneer <input type="checkbox"/> Vinyl <input type="checkbox"/> Stone <input type="checkbox"/> Fiber Cement <input type="checkbox"/> Synthetic Stucco <input type="checkbox"/> Composition/Hardboard <input type="checkbox"/> Concrete <input type="checkbox"/> Aluminum <input type="checkbox"/> Wood <input type="checkbox"/> Asbestos <input type="checkbox"/> Other: _____			<input type="checkbox"/>																																																																											
A5. In what year was the dwelling's roof covering installed? <u>2004</u>			<input type="checkbox"/>																																																																											
A6. Is there a leakage or other problem with the dwelling's roof or related existing damage?	<input type="checkbox"/>	<input checked="" type="checkbox"/>	<input type="checkbox"/>																																																																											
A7. Is there water seepage, leakage, dampness, or standing water in the dwelling's basement, crawl space, or slab?	<input type="checkbox"/>	<input checked="" type="checkbox"/>	<input type="checkbox"/>																																																																											
A8. Is there an infestation present in the dwelling or damage from past infestations of wood destroying insects or organisms that has not been repaired?	<input type="checkbox"/>	<input checked="" type="checkbox"/>	<input type="checkbox"/>																																																																											
A9. Is there a problem, malfunction, or defect with the dwelling's:																																																																														
<table border="0" style="width:100%; border-collapse: collapse;"> <tr> <td></td> <td align="center">NA</td> <td align="center">Yes</td> <td align="center">No</td> <td align="center">NR</td> <td></td> <td align="center">NA</td> <td align="center">Yes</td> <td align="center">No</td> <td align="center">NR</td> <td></td> <td align="center">NA</td> <td align="center">Yes</td> <td align="center">No</td> <td align="center">NR</td> </tr> <tr> <td>Foundation</td> <td align="center"><input type="checkbox"/></td> <td align="center"><input type="checkbox"/></td> <td align="center"><input checked="" type="checkbox"/></td> <td align="center"><input type="checkbox"/></td> <td>Windows</td> <td align="center"><input type="checkbox"/></td> <td align="center"><input type="checkbox"/></td> <td align="center"><input checked="" type="checkbox"/></td> <td align="center"><input type="checkbox"/></td> <td>Attached Garage</td> <td align="center"><input type="checkbox"/></td> <td align="center"><input type="checkbox"/></td> <td align="center"><input checked="" type="checkbox"/></td> <td align="center"><input type="checkbox"/></td> </tr> <tr> <td>Slab</td> <td align="center"><input type="checkbox"/></td> <td align="center"><input type="checkbox"/></td> <td align="center"><input checked="" type="checkbox"/></td> <td align="center"><input type="checkbox"/></td> <td>Doors</td> <td align="center"><input type="checkbox"/></td> <td align="center"><input type="checkbox"/></td> <td align="center"><input checked="" type="checkbox"/></td> <td align="center"><input type="checkbox"/></td> <td>Fireplace/Chimney</td> <td align="center"><input type="checkbox"/></td> <td align="center"><input type="checkbox"/></td> <td align="center"><input checked="" type="checkbox"/></td> <td align="center"><input type="checkbox"/></td> </tr> <tr> <td>Patio</td> <td align="center"><input type="checkbox"/></td> <td align="center"><input type="checkbox"/></td> <td align="center"><input checked="" type="checkbox"/></td> <td align="center"><input type="checkbox"/></td> <td>Ceilings</td> <td align="center"><input type="checkbox"/></td> <td align="center"><input type="checkbox"/></td> <td align="center"><input checked="" type="checkbox"/></td> <td align="center"><input type="checkbox"/></td> <td>Interior/Exterior Walls</td> <td align="center"><input type="checkbox"/></td> <td align="center"><input type="checkbox"/></td> <td align="center"><input checked="" type="checkbox"/></td> <td align="center"><input type="checkbox"/></td> </tr> <tr> <td>Floors</td> <td align="center"><input type="checkbox"/></td> <td align="center"><input type="checkbox"/></td> <td align="center"><input checked="" type="checkbox"/></td> <td align="center"><input type="checkbox"/></td> <td>Deck</td> <td align="center"><input checked="" type="checkbox"/></td> <td align="center"><input type="checkbox"/></td> <td align="center"><input type="checkbox"/></td> <td align="center"><input type="checkbox"/></td> <td>Other: _____</td> <td align="center"><input type="checkbox"/></td> <td align="center"><input type="checkbox"/></td> <td align="center"><input type="checkbox"/></td> <td align="center"><input type="checkbox"/></td> </tr> </table>		NA	Yes	No	NR		NA	Yes	No	NR		NA	Yes	No	NR	Foundation	<input type="checkbox"/>	<input type="checkbox"/>	<input checked="" type="checkbox"/>	<input type="checkbox"/>	Windows	<input type="checkbox"/>	<input type="checkbox"/>	<input checked="" type="checkbox"/>	<input type="checkbox"/>	Attached Garage	<input type="checkbox"/>	<input type="checkbox"/>	<input checked="" type="checkbox"/>	<input type="checkbox"/>	Slab	<input type="checkbox"/>	<input type="checkbox"/>	<input checked="" type="checkbox"/>	<input type="checkbox"/>	Doors	<input type="checkbox"/>	<input type="checkbox"/>	<input checked="" type="checkbox"/>	<input type="checkbox"/>	Fireplace/Chimney	<input type="checkbox"/>	<input type="checkbox"/>	<input checked="" type="checkbox"/>	<input type="checkbox"/>	Patio	<input type="checkbox"/>	<input type="checkbox"/>	<input checked="" type="checkbox"/>	<input type="checkbox"/>	Ceilings	<input type="checkbox"/>	<input type="checkbox"/>	<input checked="" type="checkbox"/>	<input type="checkbox"/>	Interior/Exterior Walls	<input type="checkbox"/>	<input type="checkbox"/>	<input checked="" type="checkbox"/>	<input type="checkbox"/>	Floors	<input type="checkbox"/>	<input type="checkbox"/>	<input checked="" type="checkbox"/>	<input type="checkbox"/>	Deck	<input checked="" type="checkbox"/>	<input type="checkbox"/>	<input type="checkbox"/>	<input type="checkbox"/>	Other: _____	<input type="checkbox"/>	<input type="checkbox"/>	<input type="checkbox"/>	<input type="checkbox"/>			
	NA	Yes	No	NR		NA	Yes	No	NR		NA	Yes	No	NR																																																																
Foundation	<input type="checkbox"/>	<input type="checkbox"/>	<input checked="" type="checkbox"/>	<input type="checkbox"/>	Windows	<input type="checkbox"/>	<input type="checkbox"/>	<input checked="" type="checkbox"/>	<input type="checkbox"/>	Attached Garage	<input type="checkbox"/>	<input type="checkbox"/>	<input checked="" type="checkbox"/>	<input type="checkbox"/>																																																																
Slab	<input type="checkbox"/>	<input type="checkbox"/>	<input checked="" type="checkbox"/>	<input type="checkbox"/>	Doors	<input type="checkbox"/>	<input type="checkbox"/>	<input checked="" type="checkbox"/>	<input type="checkbox"/>	Fireplace/Chimney	<input type="checkbox"/>	<input type="checkbox"/>	<input checked="" type="checkbox"/>	<input type="checkbox"/>																																																																
Patio	<input type="checkbox"/>	<input type="checkbox"/>	<input checked="" type="checkbox"/>	<input type="checkbox"/>	Ceilings	<input type="checkbox"/>	<input type="checkbox"/>	<input checked="" type="checkbox"/>	<input type="checkbox"/>	Interior/Exterior Walls	<input type="checkbox"/>	<input type="checkbox"/>	<input checked="" type="checkbox"/>	<input type="checkbox"/>																																																																
Floors	<input type="checkbox"/>	<input type="checkbox"/>	<input checked="" type="checkbox"/>	<input type="checkbox"/>	Deck	<input checked="" type="checkbox"/>	<input type="checkbox"/>	<input type="checkbox"/>	<input type="checkbox"/>	Other: _____	<input type="checkbox"/>	<input type="checkbox"/>	<input type="checkbox"/>	<input type="checkbox"/>																																																																

Explanations for questions in Section A (identify the specific question for each explanation):

**SECTION B.
HVAC/ELECTRICAL**

B1. Is there a problem, malfunction, or defect with the dwelling's electrical system (outlets, wiring, panels, switches, fixtures, generator, etc.)?	<input type="checkbox"/>	<input checked="" type="checkbox"/>	<input type="checkbox"/>
B2. Is there a problem, malfunction, or defect with the dwelling's heating and/or air conditioning?	<input type="checkbox"/>	<input checked="" type="checkbox"/>	<input type="checkbox"/>
B3. What is the dwelling's heat source? (Check all that apply; indicate the year of each system manufacture)			<input type="checkbox"/>
<input type="checkbox"/> Furnace [___ # of units] Year: _____		<input type="checkbox"/> Heat Pump [___ # of units] Year: _____	
<input type="checkbox"/> Baseboard [___ # of bedrooms with units] Year: _____		<input type="checkbox"/> Other: _____ Year: _____	

Buyer Initials _____ Owner Initials JP
Buyer Initials _____ Owner Initials DP

REC 4.22
REV 5/24

Yes No NR

B4. What is the dwelling's cooling source? (Check all that apply; indicate the year of each system manufacture)

Central Forced Air: _____ Year: ____ Wall/Windows Unit(s): _____ Year: ____
 Other: _____ Year: ____

B5. What is the dwelling's fuel source? (Check all that apply)

Electricity Natural Gas Solar Propane Oil Other: _____

Explanations for questions in Section B (identify the specific question for each explanation):

**SECTION C.
PLUMBING/WATER SUPPLY/SEWER/SEPTIC**

Yes No NR

C1. What is the dwelling's water supply source? (Check all that apply)

City/County Shared well Community System Private well Other: _____

If the dwelling's water supply source is supplied by a private well, identify whether the private well has been tested for: (Check all that apply).

Quality Pressure Quantity

If the dwelling's water source is supplied by a private well, what was the date of the last water quality/quantity test? _____

C2. The dwelling's water pipes are made of what type of material? (Check all that apply)

Copper Galvanized Plastic Polybutylene Other: _____

C3. What is the dwelling's water heater fuel source? (Check all that apply; indicate the year of each system manufacture) Gas: _____ Electric: _____ Solar: _____ Other: _____

C4. What is the dwelling's sewage disposal system? (Check all that apply)

Septic tank with pump community system Septic tank Drip system
 Connected to City/County System City/County system available Other: _____
 Straight pipe (wastewater does not go into a septic or other sewer system) *Note: Use of this type of system violates State Law.

If the dwelling is serviced by a septic system, how many bedrooms are allowed by the septic system permit? _____ No Records Available

Date the septic system was last pumped: _____

C5. Is there a problem, malfunction, or defect with the dwelling's:

	NA	Yes	No	NR		NA	Yes	No	NR
Septic system	<input checked="" type="checkbox"/>	<input type="checkbox"/>	<input type="checkbox"/>	<input type="checkbox"/>	Plumbing system (pipes, fixtures, water heater, etc.)	<input type="checkbox"/>	<input type="checkbox"/>	<input checked="" type="checkbox"/>	<input type="checkbox"/>
Sewer system	<input type="checkbox"/>	<input type="checkbox"/>	<input checked="" type="checkbox"/>	<input type="checkbox"/>	Water supply (water quality, quantity, or pressure)	<input type="checkbox"/>	<input type="checkbox"/>	<input checked="" type="checkbox"/>	<input type="checkbox"/>

Explanations for questions in Section C (identify the specific question for each explanation):

Buyer Initials _____ Owner Initials TS
Buyer Initials _____ Owner Initials DL

REC 4.22
REV 5/24

**SECTION D.
FIXTURES/APPLIANCES**

D1. Is the dwelling equipped with an elevator system? Yes No NR
 If yes, when was it last inspected? _____
 Date of last maintenance service: _____

D2. Is there a problem, malfunction, or defect with the dwelling's:

Attic fan, exhaust fan, ceiling fan	NA <input type="checkbox"/>	Yes <input type="checkbox"/>	No <input checked="" type="checkbox"/>	NR <input type="checkbox"/>	Irrigation system	NA <input type="checkbox"/>	Yes <input type="checkbox"/>	No <input checked="" type="checkbox"/>	NR <input type="checkbox"/>	Sump pump	NA <input type="checkbox"/>	Yes <input type="checkbox"/>	No <input type="checkbox"/>	NR <input checked="" type="checkbox"/>	Garage Door system	NA <input type="checkbox"/>	Yes <input type="checkbox"/>	No <input checked="" type="checkbox"/>	NR <input type="checkbox"/>
Elevator system or component	NA <input type="checkbox"/>	Yes <input type="checkbox"/>	No <input type="checkbox"/>	NR <input checked="" type="checkbox"/>	Pool/hot tub /spa	NA <input type="checkbox"/>	Yes <input type="checkbox"/>	No <input type="checkbox"/>	NR <input checked="" type="checkbox"/>	Gas logs	NA <input type="checkbox"/>	Yes <input type="checkbox"/>	No <input checked="" type="checkbox"/>	NR <input type="checkbox"/>	Security system	NA <input type="checkbox"/>	Yes <input type="checkbox"/>	No <input type="checkbox"/>	NR <input checked="" type="checkbox"/>
Appliances to be conveyed	NA <input type="checkbox"/>	Yes <input type="checkbox"/>	No <input checked="" type="checkbox"/>	NR <input type="checkbox"/>	TV cable wiring or satellite dish	NA <input type="checkbox"/>	Yes <input type="checkbox"/>	No <input checked="" type="checkbox"/>	NR <input type="checkbox"/>	Central vacuum	NA <input type="checkbox"/>	Yes <input type="checkbox"/>	No <input type="checkbox"/>	NR <input checked="" type="checkbox"/>	Other:	NA <input type="checkbox"/>	Yes <input type="checkbox"/>	No <input type="checkbox"/>	NR <input checked="" type="checkbox"/>

Explanations for questions in Section D (identify the specific question for each explanation):

**SECTION E.
LAND/ZONING**

E1. Is there a problem, malfunction, or defect with the drainage, grading, or soil stability of the property? Yes No NR

E2. Is the property in violation of any local zoning ordinances, restrictive covenants, or local land-use restrictions (including setback requirements?) Yes No NR

E3. Is the property in violation of any building codes (including the failure to obtain required permits for room additions or other changes/improvements?) Yes No NR

E4. Is the property subject to any utility or other easements, shared driveways, party walls, encroachments from or on adjacent property, or other land use restrictions? Yes No NR

E5. Does the property abut or adjoin any private road(s) or street(s)? Yes No NR

E6. If there is a private road or street adjoining the property, are there any owners' association or maintenance agreements dealing with the maintenance of the road or street? NA Yes No NR

Explanations for questions in Section E (identify the specific question for each explanation):

**SECTION F.
ENVIRONMENTAL/FLOODING**

F1. Is there hazardous or toxic substance, material, or product (such as asbestos, formaldehyde, radon gas, methane gas, lead-based paint) that exceed government safety standards located on or which otherwise affect the property? Yes No NR

Buyer Initials _____ Owner Initials JS
 Buyer Initials _____ Owner Initials _____

REC 4.22
REV 5/24

- | | Yes | No | NR |
|--|-------------------------------------|-------------------------------------|--------------------------|
| F2. Is there an environmental monitoring or mitigation device or system located on the property? | <input type="checkbox"/> | <input checked="" type="checkbox"/> | <input type="checkbox"/> |
| F3. Is there debris (whether buried or covered), an underground storage tank, or an environmentally hazardous condition (such as contaminated soil or water or other environmental contamination) located on or which otherwise affect the property? | <input type="checkbox"/> | <input checked="" type="checkbox"/> | <input type="checkbox"/> |
| F4. Is there any noise, odor, smoke, etc., from commercial, industrial, or military sources that affects the property? | <input type="checkbox"/> | <input checked="" type="checkbox"/> | <input type="checkbox"/> |
| F5. Is the property located in a federal or other designated flood hazard zone? | <input checked="" type="checkbox"/> | <input type="checkbox"/> | <input type="checkbox"/> |
| F6. Has the property experienced damage due to flooding, water seepage, or pooled water attributable to a natural event such as heavy rainfall, coastal storm surge, tidal inundation, or river overflow? | <input type="checkbox"/> | <input checked="" type="checkbox"/> | <input type="checkbox"/> |
| F7. Have you ever filed a claim for flood damage to the property with any insurance provider, including the National Flood Insurance Program? | <input type="checkbox"/> | <input checked="" type="checkbox"/> | <input type="checkbox"/> |
| F8. Is there a current flood insurance policy covering the property? | <input type="checkbox"/> | <input checked="" type="checkbox"/> | <input type="checkbox"/> |
| F9. Have you received assistance from FEMA, U.S. Small Business Administration, or any other federal disaster flood assistance for flood damage to the property? | <input type="checkbox"/> | <input checked="" type="checkbox"/> | <input type="checkbox"/> |
| F10. Is there a flood or FEMA elevation certificate for the property? | <input type="checkbox"/> | <input checked="" type="checkbox"/> | <input type="checkbox"/> |

NOTE: An existing flood insurance policy may be assignable to a buyer at a lesser premium than a new policy. For properties that have received disaster assistance, the requirement to obtain flood insurance passes down to all future owners. Failure to obtain flood insurance can result in an owner being ineligible for future assistance.

Explanations for questions in Section F (identify the specific question for each explanation):

SECTION G. MISCELLANEOUS

- | | Yes | No | NR |
|--|-------------------------------------|-------------------------------------|--------------------------|
| G1. Is the property subject to any lawsuits, foreclosures, bankruptcy, judgments, tax liens, proposed assessments, mechanics' liens, materialmen's liens, or notices from any governmental agency that could affect title to the property? | <input type="checkbox"/> | <input checked="" type="checkbox"/> | <input type="checkbox"/> |
| G2. Is the property subject to a lease or rental agreement? | <input type="checkbox"/> | <input checked="" type="checkbox"/> | <input type="checkbox"/> |
| G3. Is the property subject to covenants, conditions, or restrictions or to governing documents separate from an owners' association that impose various mandatory covenants, conditions, and or restrictions upon the lot or unit? | <input checked="" type="checkbox"/> | <input type="checkbox"/> | <input type="checkbox"/> |

Explanations for question in Section G (identify the specific question for each explanation):

Buyer Initials _____ Owner Initials JB
 Buyer Initials _____ Owner Initials DP

REC 4.22

REV 5/24

5

**SECTION H.
OWNERS' ASSOCIATION DISCLOSURE**

If you answer 'Yes' to question H1, you must complete the remaining questions in Section H. If you answered 'No' or 'No Representation' to question H1, you do not need to answer the remaining questions in Section H.

	Yes	No	NR
H1. Is the property subject to regulation by one or more owners' association(s) including, but not limited to, obligations to pay regular assessments or dues and special assessments? If "yes," please provide the information requested below as to each owners' association to which the property is subject [insert N/A into any blank that does not apply]: a. (specify name) <u>The Townes at Westview</u> whose regular assessments ("dues") are \$ <u>165</u> per <u>month</u> . The name, address, telephone number, and website of the president of the owners' association or the association manager are: <u>MARION STUBA 252-314-7964</u>	<input checked="" type="checkbox"/>	<input type="checkbox"/>	<input type="checkbox"/>
b. (specify name) _____ whose regular assessments ("dues") are \$ _____ per _____. The name, address, telephone number, and website of the president of the owners' association or the association manager are: _____			
c. Are there any changes to dues, fees, or special assessment which have been duly approved and to which the lot is subject? <u>NO</u> If "yes," state the nature and amount of the dues, fees, or special assessments to which the property is subject: _____			

H2. Is there any fee charged by the association or by the association's management company in connection with the conveyance or transfer of the lot or property to a new owner?
If "yes," state the amount of the fees: _____

H3. Is there any unsatisfied judgment against, pending lawsuit, or existing or alleged violation of the association's governing documents involving the property?
If "yes," state the nature of each pending lawsuit, unsatisfied judgment, or existing or alleged violation: _____

H4. Is there any unsatisfied judgment or pending lawsuits against the association?
If "yes," state the nature of each unsatisfied judgment or pending lawsuit: _____

Explanations for questions in Section H (identify the specific question for each explanation):

Owner(s) acknowledge(s) having reviewed this Disclosure Statement before signing and that all information is true and correct to the best of their knowledge as of the date signed.

Owner Signature: Jatin Patel Jatinkumar K Patel Date 4/24/25
 Owner Signature: Divya J Patel Divya J. Patel Date 4/24/25

Buyers(s) acknowledge(s) receipt of a copy of this Disclosure Statement and that they have reviewed it before signing.

Buyer Signature: _____ Date _____
 Buyer Signature: _____ Date _____

SKETCH ADDENDUM

Borrower or Owner

Property Address 1117 Rosedale Ave

City Rocky Mount

County

State NC

Zip Code 27804

Client Market Leader Realty

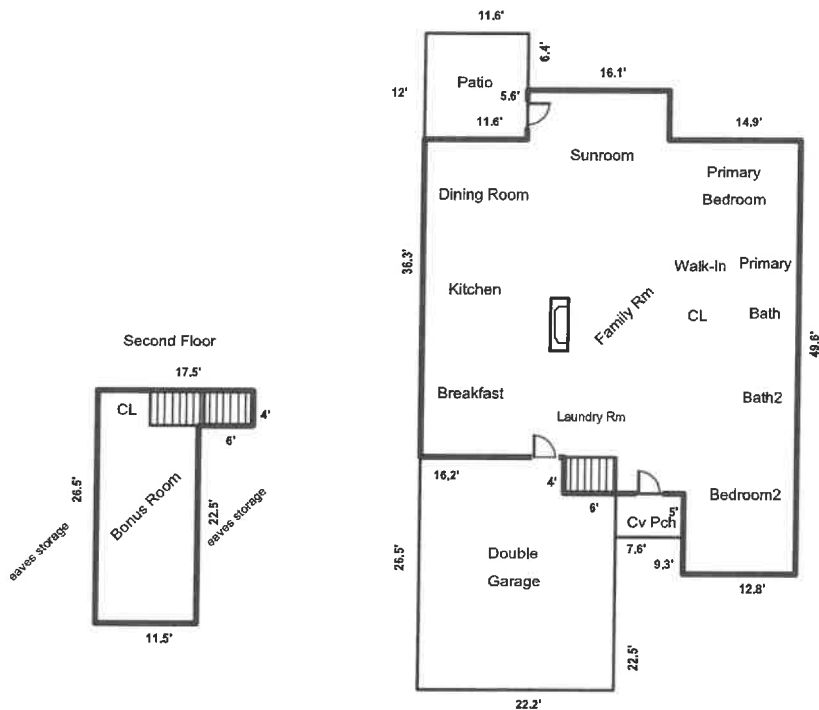

SUMMARY	SQ FT AREA	PERIMETER	AREA CALCULATION DETAILS	
Living Area			First Floor	
First Floor	1861	196	16.1 X 41.9 =	674.5
Second Floor	329	88	11.6 X 36.3 =	421.0
Total	2190	284	14.9 X 40.3 =	600.4
Garage/Carport			11.5 X 4.0 =	46.0
Attached Garage	564	97	12.8 X 9.3 =	119.0
			Total	1860.9
Porches/Patios			Second Floor	
Cv Pch	38	25	17.5 X 4.0 =	70.0
Patio	139	47	11.5 X 22.5 =	258.7
			Total	328.7