

# Building Sketch (Page - 1)

Borrower/Client					
Property Address 2108 Hidden Harbor Dr					
City New Bern		County Craven		State NC Zip Code 28562-7328	
Lender					

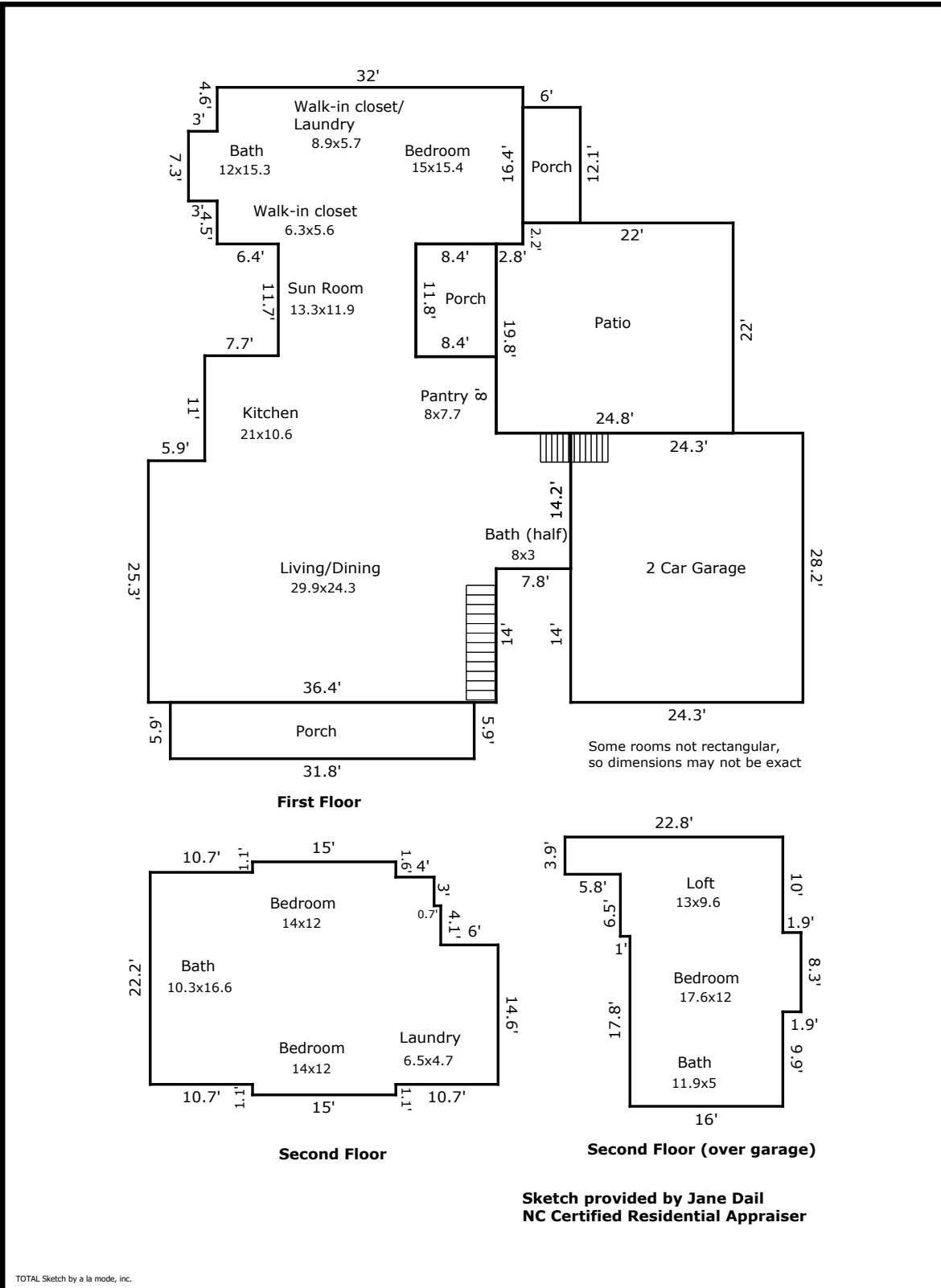

TOTAL Sketch by a la mode, inc.

## Building Sketch (Page - 2)

Borrower/Client							
Property Address	2108 Hidden Harbor Dr						
City	New Bern	County	Craven	State	NC	Zip Code	28562-7328
Lender							

TOTAL Sketch by a la mode, inc.

### Area Calculations Summary

Living Area	Area	Calculation Details
First Floor	2081.52 Sq ft	$7.3 \times 3 = 21.9$ $14.2 \times 7.8 = 110.76$ $32 \times 16.4 = 524.8$ $14.4 \times 11.7 = 168.48$ $36.4 \times 25.3 = 920.92$ $10.9 \times 8.4 = 91.56$ $22.1 \times 11 = 243.1$
Second Floor	499.99 Sq ft	$8.3 \times 1.9 = 15.77$ $16 \times 17.8 = 284.8$ $3.9 \times 5.8 = 22.62$ $17 \times 10.4 = 176.8$
Second Floor	791.03 Sq ft	$15 \times 1.1 = 16.5$ $22.2 \times 10.7 = 237.54$ $23.3 \times 15 = 349.5$ $4 \times 3 = 12$ $4.7 \times 4.1 = 19.27$ $10.7 \times 14.6 = 156.22$
<b>Total Living Area (Rounded):</b>	<b>3373 Sq ft</b>	
<b>Non-living Area</b>		
Open Porch	187.62 Sq ft	$31.8 \times 5.9 = 187.62$
2 Car Built-in	685.26 Sq ft	$24.3 \times 28.2 = 685.26$
Open Porch	99.12 Sq ft	$8.4 \times 11.8 = 99.12$
Concrete Patio	539.44 Sq ft	$22 \times 22 = 484$ $2.8 \times 19.8 = 55.44$
Open Porch	72.6 Sq ft	$6 \times 12.1 = 72.6$