

REVISED - NEW TANK SIZE & TYPE

| | | | |
|--|---|--|---|
| SUBSURFACE WASTEWATER DISPOSAL SYSTEM APPLICATION | | Maine Dept. of Health & Human Services Division of Environmental Health, SHS 11 (207) 287-5672 Fax: (207) 287-3165 | |
| PROPERTY LOCATION | | CAUTION: PERMIT REQUIRED - ATTACH IN SPACE BELOW | |
| City, Town, or Plantation | Otis | Town/City _____ | Permit # _____ |
| Street or Road | 463 West Shore Road | Date Permit Issued ___/___/___ | Fee: \$ _____ Double Fee Charged [] |
| Subdivision, Lot # | Beech Hill Pond | L.P.I. # _____ | |
| OWNER/APPLICANT INFORMATION | | Local Plumbing Inspector Signature _____ | |
| Name (last, first, MI) | Bar Harbor Homes, LLC. <input checked="" type="checkbox"/> Owner <input type="checkbox"/> Applicant | <input type="checkbox"/> Owner <input type="checkbox"/> Town <input type="checkbox"/> State | |
| Mailing Address of Owner/Applicant | Attn: Robard Abraham 1389 Bayside Road, Trenton, ME 04605 | The Subsurface Wastewater Disposal System shall not be installed until a Permit is issued by the Local Plumbing Inspector. The Permit shall authorize the owner or installer to install the disposal system in accordance with this application and the Maine Subsurface Wastewater Disposal Rules. | |
| Daytime Tel. # | 207-907-6122 | Part of Municipal Tax Map # <u>R-1</u> Lot # <u>4 & 4A</u> | |
| OWNER OR APPLICANT STATEMENT | | CAUTION: INSPECTION REQUIRED | |
| I state and acknowledge that the information submitted is correct to the best of my knowledge and understand that any falsification is reason for the Department and/or Local Plumbing Inspector to deny a Permit. | | I have inspected the installation authorized above and found it to be in compliance with the Subsurface Wastewater Disposal Rules Application. | |
| _____ Signature of Owner or Applicant | | _____ Local Plumbing Inspector Signature | |
| _____ Date | | _____ (1st) date approved | |
| _____ Date | | _____ (2nd) date approved | |
| PERMIT INFORMATION | | | |
| TYPE OF APPLICATION <input type="checkbox"/> 1. First Time System <input checked="" type="checkbox"/> 2. Replacement System Type replaced: <u>Old Tank + Trench</u> Year installed: <u>Unknown</u> <input type="checkbox"/> 3. Expanded System <input type="checkbox"/> a. <25% Expansion <input type="checkbox"/> b. ≥25% Expansion <input type="checkbox"/> 4. Experimental System <input type="checkbox"/> 5. Seasonal Conversion | THIS APPLICATION REQUIRES <input checked="" type="checkbox"/> 1. No Rule Variance <input type="checkbox"/> 2. First Time System Variance <input type="checkbox"/> a. Local Plumbing Inspector Approval <input type="checkbox"/> b. State & Local Plumbing Inspector <input type="checkbox"/> 3. Replacement System Variance <input type="checkbox"/> a. Local Plumbing Inspector Approval <input type="checkbox"/> b. State & Local Plumbing Inspector <input type="checkbox"/> 4. Minimum Lot Size Variance <input type="checkbox"/> 5. Seasonal Conversion Permit | DISPOSAL SYSTEM COMPONENTS <input checked="" type="checkbox"/> 1. Complete Non-engineered System <input type="checkbox"/> 2. Primitive System (graywater & alt. toilet) <input type="checkbox"/> 3. Alternative Toilet, specify: _____ <input type="checkbox"/> 4. Non-engineered Treatment Tank (only) <input type="checkbox"/> 5. Holding Tank, _____ gallons <input type="checkbox"/> 6. Non-engineered Disposal Field (only) <input type="checkbox"/> 7. Separated Laundry System <input type="checkbox"/> 8. Complete Engineered System (2000 gpd or more) <input type="checkbox"/> 9. Engineered Treatment Tank (only) <input type="checkbox"/> 10. Engineered Disposal Field (only) <input type="checkbox"/> 11. Pre-treatment, specify: _____ <input type="checkbox"/> 12. Miscellaneous Components | |
| SIZE OF PROPERTY 1.7 +/- <input type="checkbox"/> SQ. FT. <input checked="" type="checkbox"/> ACRES | DISPOSAL SYSTEM TO SERVE <input type="checkbox"/> 1. Single Family Dwelling Unit, No. of Bedrooms: _____ <input checked="" type="checkbox"/> 2. Multiple Family Dwelling, No. of Units: <u>Two 2BR Units</u> <input type="checkbox"/> 3. Other: _____ (specify) | TYPE OF WATER SUPPLY <input type="checkbox"/> 1. Drilled Well <input type="checkbox"/> 2. Dug Well <input type="checkbox"/> 3. Private <input type="checkbox"/> 4. Public <input checked="" type="checkbox"/> 5. Other - Pressurized From Lake | |
| SHORELAND ZONING <input checked="" type="checkbox"/> Yes <input type="checkbox"/> No | Current Use <input type="checkbox"/> Seasonal <input checked="" type="checkbox"/> Year Round <input type="checkbox"/> Undeveloped | | |
| DESIGN DETAILS (SYSTEM LAYOUT SHOWN ON PAGE 3) | | | |
| TREATMENT TANK <input checked="" type="checkbox"/> 1. Concrete OR <input checked="" type="checkbox"/> a. Regular <input type="checkbox"/> b. Low Profile <input type="checkbox"/> 2. Plastic w/ A1800 <input type="checkbox"/> 3. Other: <u>Zabel Filter</u> CAPACITY: <u>1,500</u> GAL | DISPOSAL FIELD TYPE & SIZE <input type="checkbox"/> 1. Stone Bed <input type="checkbox"/> 2. Stone Trench <input checked="" type="checkbox"/> 3. Proprietary Device Conc. Chambers <input type="checkbox"/> a. cluster array <input type="checkbox"/> c. Linear <input type="checkbox"/> b. regular load <input type="checkbox"/> d. H-20 load <input type="checkbox"/> 4. Other: _____ SIZE: <u>1,188</u> sq. ft. <input type="checkbox"/> lin. ft. | GARBAGE DISPOSAL UNIT <input checked="" type="checkbox"/> 1. No <input type="checkbox"/> 2. Yes <input type="checkbox"/> 3. Maybe If Yes of Maybe, specify one below: <input type="checkbox"/> a. multi-compartment tank <input type="checkbox"/> b. _____ tanks in series <input type="checkbox"/> c. increase in tank capacity <input checked="" type="checkbox"/> d. Filter on Tank Outlet | DESIGN FLOW <u>360</u> gallons per day BASED ON: <input checked="" type="checkbox"/> 1. Table 4A (dwelling unit(s)) <input type="checkbox"/> 2. Table 4C (other facilities) SHOW CALCULATIONS _____ for other facilities _____ Two 2BR Rental Camps |
| SOIL DATA PROFILE <u>3</u> / <u>C</u> at Observation Hole # <u>HTP-1</u> Depth <u>18</u> " of Most Limiting Soil Factor Dense Layer | DISPOSAL FIELD SIZING <input type="checkbox"/> 1. Medium---2.6 sq. ft. / gpd <input checked="" type="checkbox"/> 2. Medium---Large 3.3 sq. f.t / gpd <input type="checkbox"/> 3. Large---4.1 sq. ft. / gpd <input type="checkbox"/> 4. Extra Large---5.0 sq. ft. / gpd | EFFLUENT/EJECTOR PUMP <input type="checkbox"/> 1. Not Required <input type="checkbox"/> 2. May Be Required <input checked="" type="checkbox"/> 3. Required Specify only for engineered systems: DOSE: _____ | ATTACH WATER METER DATA LATITUDE AND LONGITUDE at center of disposal area Lat. <u>044</u> d <u>41'</u> m <u>07.46"</u> s Lon. <u>068</u> d <u>27'</u> m <u>39.05"</u> s if g.p.s. state margin of error: _____ |
| SITE EVALUATOR STATEMENT | | | |
| I certify that on <u>09-14-2021</u> (date) I completed a site evaluation on this property and state that the data reported are accurate and that the proposed system is in compliance with the State of Maine Subsurface Wastewater Disposal Rules (10-144A CMR 241). | | | |
| _____ Site Evaluator Signature | | <u>264</u> SE # | <u>7-19-22</u> Date |
| <u>DAVID W. MOYSE</u> Site Evaluator Name Printed | | <u>(207) 945-6179</u> Telephone Number | <u>dave@moyseenvironmental.com</u> Email Address |
| Note: Changes to or deviations from the design should be confirmed with the Site Evaluator. | | | |

SUBSURFACE WASTEWATER DISPOSAL SYSTEM APPLICATION

Maine Dept. of Health & Human Services
 Division of Environmental Health, SHS 11
 (207) 287-5672 Fax: (207) 287-3165

Town, City, Plantation
 Otis, Maine

Street, Road, Subdivision
 463 West Shore Road

Owner or Applicant Name
 Bar Harbor Homes, LLC.

SITE PLAN Scale 1" = 60' ft.

SITE LOCATION PLAN

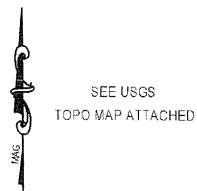
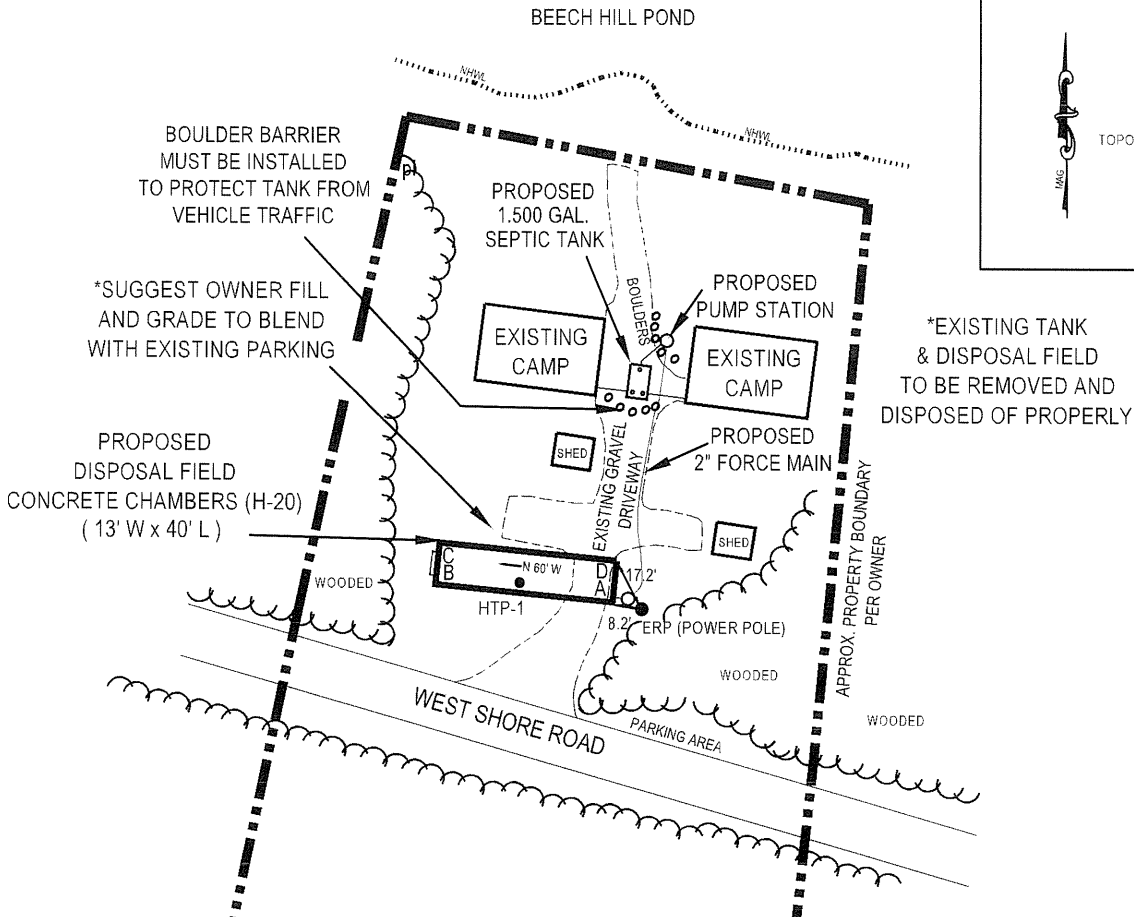

SOIL PROFILE DESCRIPTION AND CLASSIFICATION (Location of Observation Holes Shown Above)

Observation Hole # HTP-1 Test Pit Boring

6 " Depth of organic horizon above mineral soil

| Texture | Consistency | Color | Mottling |
|--------------------|------------------|-------------------|--------------|
| EXTREMELY BOULDERY | FRIABLE | REDDISH BROWN | NONE |
| SANDY | TO FIRM | STRONG BROWN | |
| WARM | (DENSE IN PLACE) | YELLOWISH BROWN | |
| FINE SANDY | | LIGHT OLIVE BROWN | COMMON FAINT |
| WARM | | | DISTINCT |

| | | | | |
|-----------------------|-------------------------|-------|--|--------------------------------------|
| Soil Profile <u>3</u> | Classification <u>C</u> | Slope | Limiting Factor | <input type="checkbox"/> Groundwater |
| Condition | Percent | Depth | <input type="checkbox"/> Restrictive Layer | <input type="checkbox"/> Bedrock |

Observation Hole # B1 Test Pit Boring

6 " Depth of organic horizon above mineral soil

| Texture | Consistency | Color | Mottling |
|---------|-------------|-------|----------|
| SAME | | | |

| | | | | |
|--------------|----------------|-------|--|--------------------------------------|
| Soil Profile | Classification | Slope | Limiting Factor | <input type="checkbox"/> Groundwater |
| Condition | Percent | Depth | <input type="checkbox"/> Restrictive Layer | <input type="checkbox"/> Bedrock |

Site Evaluator Signature *[Signature]*

SE # 264 Date 2-14-22

Site Location Map - USGS Topo

Beech Hill Pond, Otis ME

Legend

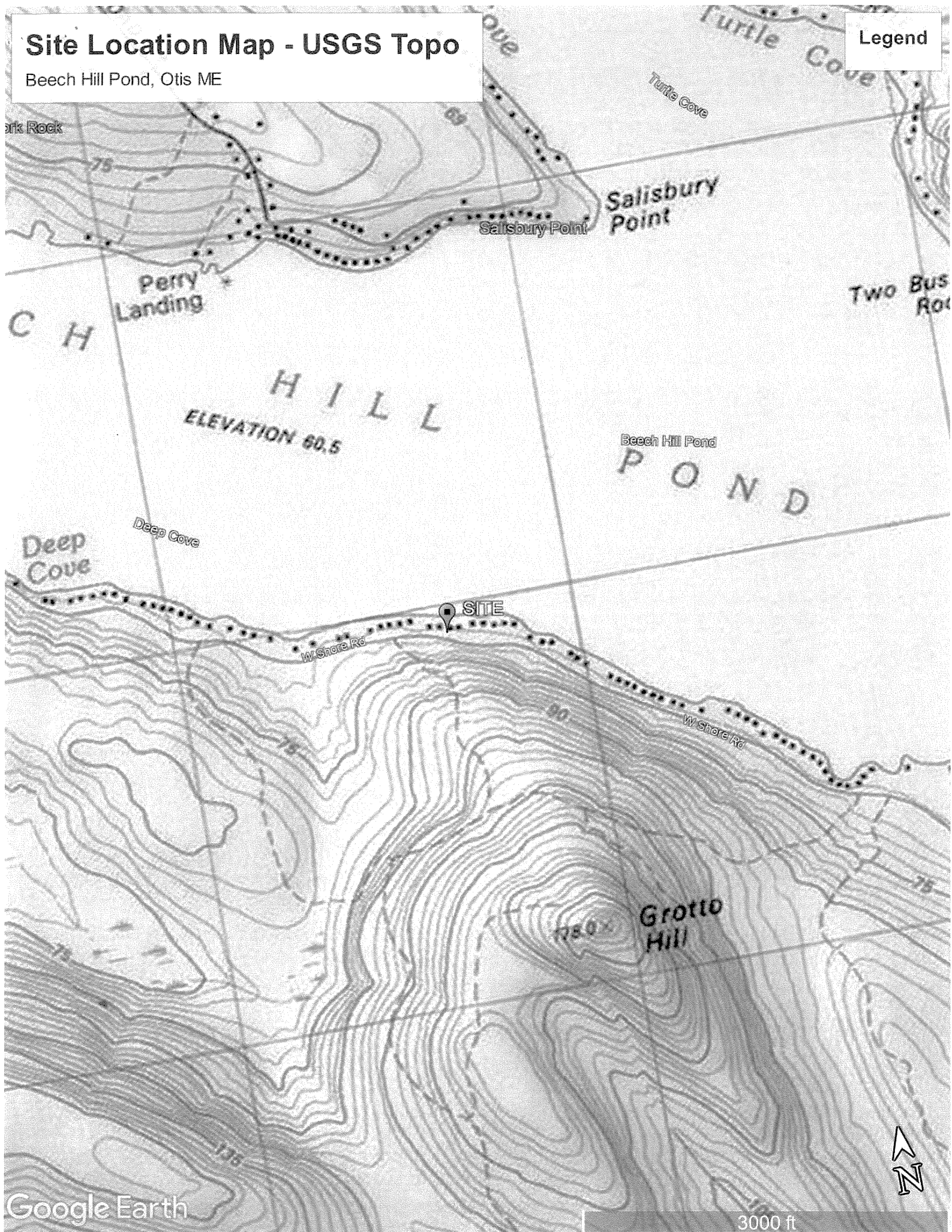

SUBSURFACE WASTEWATER DISPOSAL SYSTEM APPLICATION

Maine Dept. of Health & Human Services
 Division of Environmental Health, SHS 11
 (207) 287-5672 Fax: (207) 287-2165

Town, City, Plantation
Otis, Maine

Street, Road, Subdivision
463 West Shore Road

Owner or Applicant Name
Bar Harbor Homes, LLC.

SUBSURFACE WASTEWATER DISPOSAL PLAN

Scale: 1" = 20' ft

* SEE ATTACHED NOTES

*** PROPER EROSION AND SEDIMENT CONTROL MEASURES TO BE IN PLACE PRIOR TO SOIL DISTURBANCE**

INSTALL 4" DIA. D-MANHOLE (2 OUTLETS) USING ONE OUTLET (DETAIL). BE SURE LEVEL, BEDDED IN GRAVEL AND INSULATED. PROTECT FROM FREEZING.

INSTALL 2" HD 100 POLY PRESSURE FORCE MAIN TO D-MANHOLE. BOTTOM FEED. BEDDED PROPERLY TO PROTECT AGAINST CRUSHING AND FREEZING.

INSTALL NEW SEWER LINE 4" SOLID SCH. 40 PVC 1/4" PER FT. MINIMUM GRADIENT. (APPROX. SEWER OUTLET LOCATION)

INSTALL 4" DIA. DUPLEX PUMP STATION W/ SLIDE RAILS & SECURE ALUM. HATCH.

EXISTING GRADE ELEVATIONS

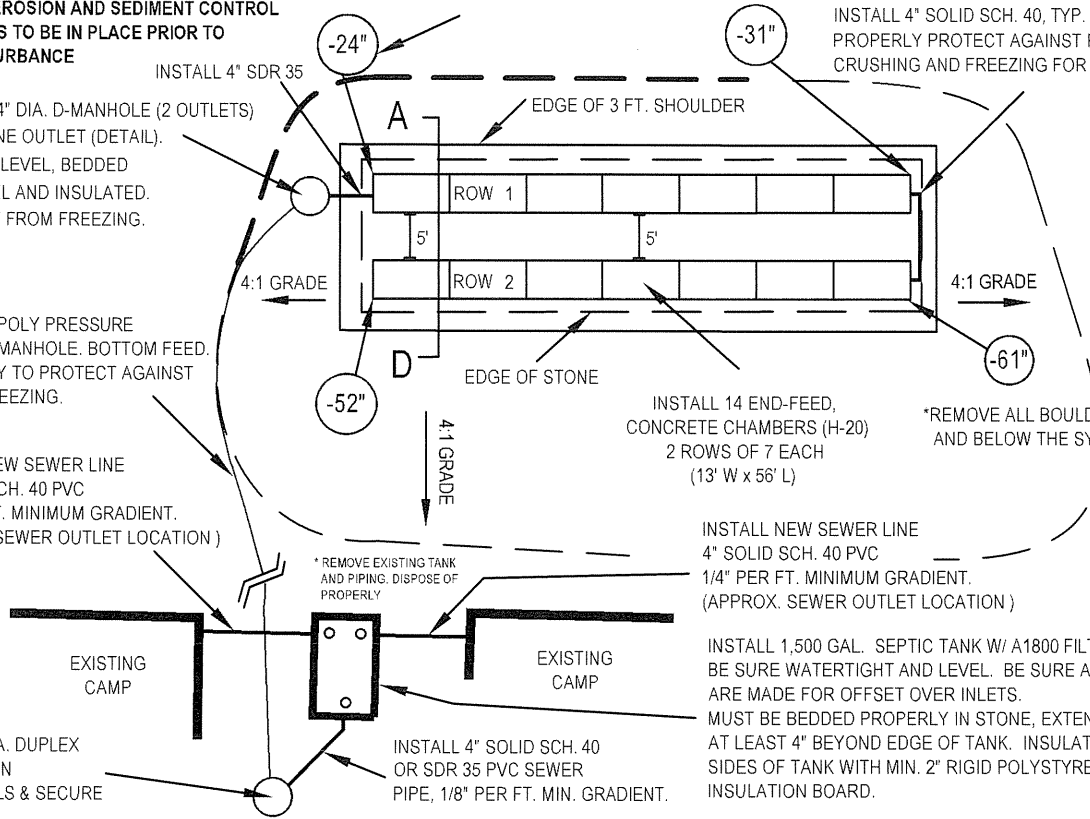

INSTALL 4" SOLID SCH. 40, TYP. PROPERLY PROTECT AGAINST PIPE SETTLEMENT, CRUSHING AND FREEZING FOR H-20 LOAD

INSTALL 14 END-FEED, CONCRETE CHAMBERS (H-20) 2 ROWS OF 7 EACH (13' W x 56' L)

*REMOVE ALL BOULDERS ON SURFACE AND BELOW THE SYSTEM

INSTALL NEW SEWER LINE 4" SOLID SCH. 40 PVC 1/4" PER FT. MINIMUM GRADIENT. (APPROX. SEWER OUTLET LOCATION)

INSTALL 1,500 GAL. SEPTIC TANK W/ A1800 FILTER. BE SURE WATERTIGHT AND LEVEL. BE SURE ACCESS PORTS ARE MADE FOR OFFSET OVER INLETS. MUST BE BEDDED PROPERLY IN STONE, EXTENDING OUT AT LEAST 4" BEYOND EDGE OF TANK. INSULATE TOP AND SIDES OF TANK WITH MIN. 2" RIGID POLYSTYRENE INSULATION BOARD.

BACKFILL REQUIREMENTS

CONSTRUCTION ELEVATIONS

ELEVATION REFERENCE POINT (ERP)

Depth of Backfill (upslope) 19" to 26"
 Depth of Backfill (downslope) 48" to 57"

| | |
|----------------------------|------|
| ERP | 0 |
| Finished Grade Elevation | -18" |
| Top of Chambers | -30" |
| Bottom of Chambers (Row 1) | -43" |

Location & Description: _____
 Nail in Blue Flagging 12" Up On Private Power Pole.
 Double Blue Flagged

DISPOSAL FIELD CROSS SECTION

FILL MATERIAL SPEC. BY VOLUME:
 < 0% GREATER THAN 3" DIA.
 15 - 30% GRAVEL (2mm-3" DIA.)
 2-8% PASSING A # 200 SIEVE (ASTM)
 0-2% CLAY

Scales:
 Vertical: 1" = 8'
 Horizontal: 1" = 8'

*Disposal Field is Proposed to be Underneath The Driveway And Parking Area. Depth of Cover Fill Unknown At This Time, 18" of Fill is Minimum Required Over The Chambers To Be H-20 Load. (See Spec. Above). Additional Fill May Be Placed To Blend Grades. No Coarse Fragments Larger Than 3" Dia. Should Be Placed Over The Chambers.

| | | |
|--------|------|------|
| ROW # | 1 | 2 |
| TOP | -30" | -51" |
| BOTTOM | -43" | -64" |

* Note That Additional Fill May Be Placed Over and Around Disposal Field to Blend Finished Grade with Existing Slopes, If Desired.

* Finished Grades Should Divert All Runoff Away From Disposal Field.

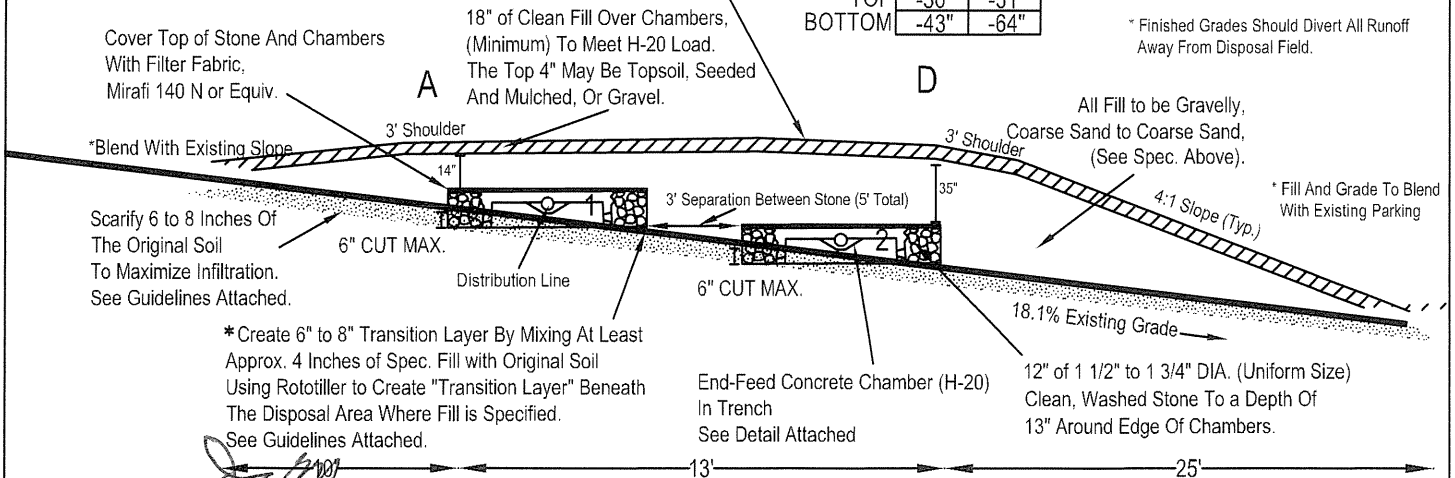

[Signature]
 Site Evaluator Signature

264
 SE #

7-19-22
 Date