

# SUBSURFACE WASTEWATER DISPOSAL SYSTEM APPLICATION

Department of Human Services  
Division of Health Engineering

**PROPERTY ADDRESS**

Town Or Plantation: BAR HARBOR

Street Subdivision Lot #: PINE HEATH LOT # 17

**PROPERTY OWNERS NAME**

Last: COLTON First: RICHARD AND ROSIE

Applicant Name:

Mailing Address of Owner/Applicant (If Different): 104 GOV. WAY N, QUEENSTOWN, MD. 21658

BAR HARBOR PERMIT # 1718 STATE COPY

Date Permit Issued: 3/18/94 \$ 40 FEE  If Double Fee Charged

[Signature] L.P.I. # 11314

Local Plumbing Inspector Signature

**Owner/Applicant Statement**

*I certify that the information submitted is correct to the best of my knowledge and understand that any falsification is reason for the Local Plumbing Inspector to deny a Permit.*

[Signature]  
Signature of Owner/Applicant Date

**Caution: Inspection Required**

*I have inspected the installation authorized above and found it to be in compliance with the Subsurface Wastewater Disposal Rules.*

Local Plumbing Inspector Signature Date Approved

## PERMIT INFORMATION

**THIS APPLICATION IS FOR:**

- NEW SYSTEM
- REPLACEMENT SYSTEM
- EXPANDED SYSTEM
- EXPERIMENTAL SYSTEM

**THIS APPLICATION REQUIRES:**

- NO RULE VARIANCE
- NEW SYSTEM VARIANCE  
Attach New System Variance Form
- REPLACEMENT SYSTEM VARIANCE  
Attach Replacement System Variance Form
  - requiring Local Plumbing Inspector Approval
  - Requires State and Local Plumbing Inspector Approval
- MINIMUM LOT SIZE VARIANCE

**INSTALLATION IS:**

**COMPLETE SYSTEM**

- NON-ENGINEERED SYSTEM
- PRIMITIVE SYSTEM  
(Includes Alternative Toilet)
- ENGINEERED (+2000 gpd)

**INDIVIDUALLY INSTALLED COMPONENTS:**

- TREATMENT TANK (ONLY)
- HOLDING TANK \_\_\_\_\_ GAL
- ALTERNATIVE TOILET (ONLY)
- NON-ENGINEERED DISPOSAL AREA (ONLY)
- ENGINEERED DISPOSAL AREA (ONLY)
- SEPARATED LAUNDRY SYSTEM

**SEASONAL CONVERSION**

to be completed by the LPI

- SYSTEM COMPLIES WITH RULES
- CONNECTED TO SANITARY SEWER
- SYSTEM INSTALLED - P# \_\_\_\_\_
- SYSTEM DESIGN RECORDED AND ATTACHED

**IF REPLACEMENT SYSTEM:**

YEAR FAILING SYSTEM INSTALLED N/A

THE FAILING SYSTEM IS:

- BED
- CHAMBER
- TRENCH
- OTHER: \_\_\_\_\_

**DISPOSAL SYSTEM TO SERVE:**

- SINGLE FAMILY DWELLING
- MODULAR OR MOBILE HOME
- MULTIPLE FAMILY DWELLING
- OTHER: \_\_\_\_\_  
SPECIFY

SIZE OF PROPERTY: 2.02 ACRES

ZONING: \_\_\_\_\_

**TYPE OF WATER SUPPLY**

PROPOSED DRILLED WELL

## DESIGN DETAILS (SYSTEM LAYOUT SHOWN ON PAGE 3)

**TREATMENT TANK**

- SEPTIC:  Regular  Low Profile
- AEROBIC

SIZE: 1000 GALS.

**WATER CONSERVATION**

- NONE
- LOW VOLUME TOILET
- SEPARATED LAUNDRY SYSTEM
- ALTERNATIVE TOILET

SPECIFY: \_\_\_\_\_

**PUMPING**

- NOT REQUIRED
- MAY BE REQUIRED  
(DEPENDING ON TREATMENT TANK LOCATION AND ELEVATION)
- REQUIRED

DOSE: \_\_\_\_\_ GALS.

CRITERIA USED FOR DESIGN FLOW (BEDROOMS, SEATING, EMPLOYEES, WATER RECORDS, ETC.)

TWO - TWO BEDROOM SINGLE FAMILY DWELLING

MINIMUM

DESIGN FLOW: 360  
(GALLONS/DAY)

**SOIL CONDITIONS USED FOR DESIGN PURPOSES**

PROFILE	CONDITION
<u>3</u>	<u>C</u>

DEPTH TO LIMITING FACTOR: 17

**SIZE RATINGS USED FOR DESIGN PURPOSES**

- SMALL
- MEDIUM
- MEDIUM-LARGE
- LARGE
- EXTRA LARGE

**DISPOSAL AREA TYPE/SIZE**

- BED \_\_\_\_\_ Sq. Ft.
- CHAMBER 675 Sq. Ft.  
 REGULAR  H-20
- TRENCH \_\_\_\_\_ Linear Ft.
- OTHER: \_\_\_\_\_

## SITE EVALUATOR STATEMENT

On MAY 20, 1994 (date) I conducted a site evaluation for this project and certify that the data reported is accurate. The system I propose is in accordance with the Subsurface Wastewater Disposal Rules.

[Signature] Site Evaluator Signature      203 SE#      5/25/1994 Date

# SUBSURFACE WASTEWATER DISPOSAL SYSTEM APPLICATION

Department of Human Services  
Division of Health Engineering

Town, City, Plantation

Street, Road, Subdivision

Owners Name

BAR HARBOR

PINE HEATH LOT # 17  
SITE PLAN

COLTON, RICHARD AND ROSIE  
SITE LOCATION PLAN (Attach Map from Maine Atlas for New System Variance)

Scale 1" = 50 Ft.

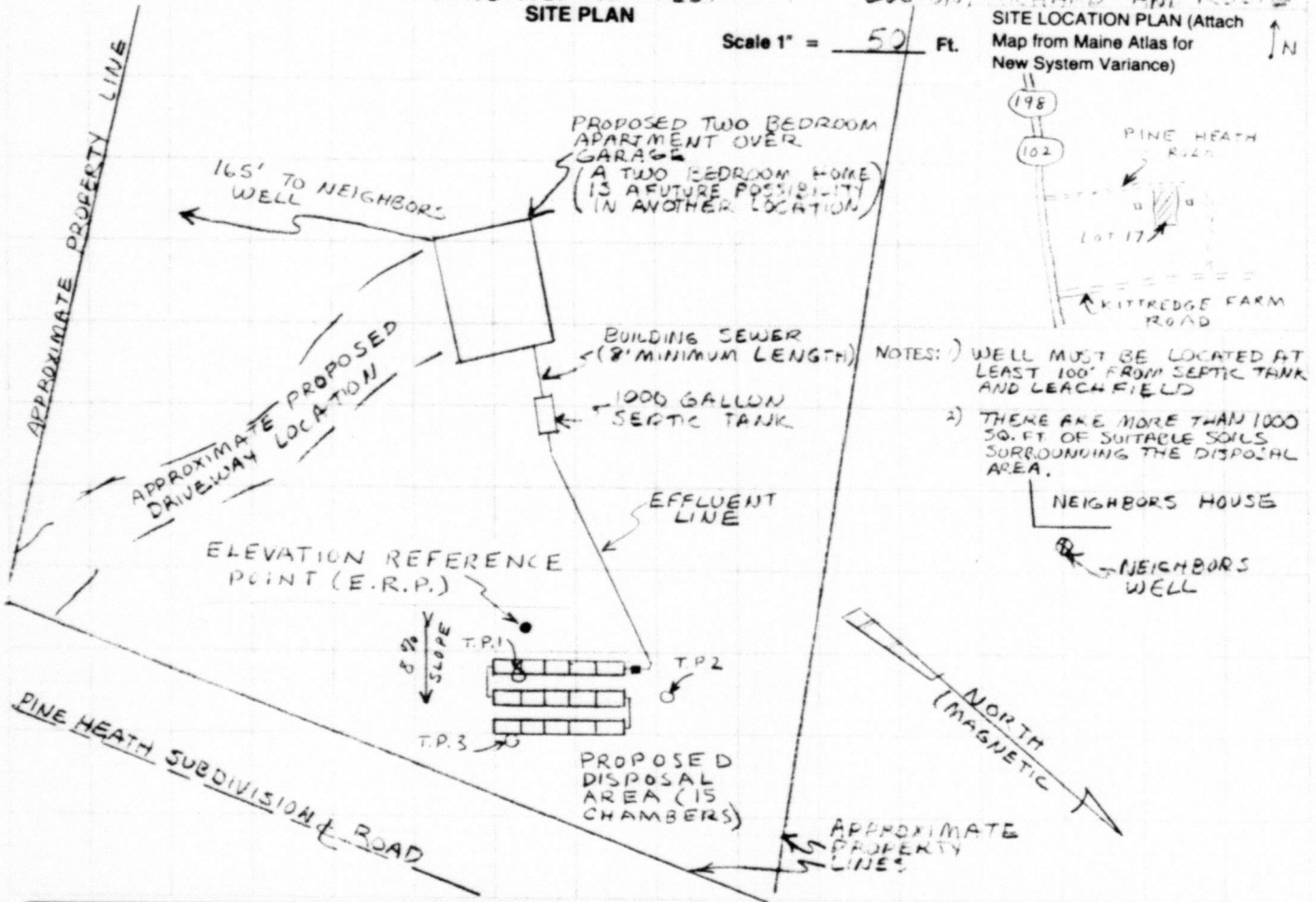

## SOIL DESCRIPTION AND CLASSIFICATION

(Location of Observation Holes Shown Above)

Observation Hole T.P. 1  Test Pit  Boring  
2" Depth of Organic Horizon Above Mineral Soil

Observation Hole T.P. 2  Test Pit  Boring  
2" Depth of Organic Horizon Above Mineral Soil

Depth (Inches)	Texture	Consistency	Color	Mottling
0-2	LOAM	FRIBLE	DARK BROWN 10YR 3/3	
2-6	FINE SANDY LOAM		ALBIC GRAY	
6-10			STRONG BROWN 7.5YR 4/6	
10-15				
15-20	SANDY LOAM		LIGHT YELLOW BROWN 2.5Y 6/2	
20-30		FIRM	LIGHT OLIVE BROWN 2.5Y 5/4	COMMON MEDIUM FAINT
30-40				
40-50				

Depth (Inches)	Texture	Consistency	Color	Mottling
0-2	LOAM	FRIBLE	10YR 3/3	ALBIC
2-6	FINE SANDY LOAM		DARK BROWN	LATCHES
6-10				
10-15				
15-20				
20-30	LOAMY SAND	FIRM	LIGHT OLIVE BROWN 2.5Y 5/4	FEW MEDIUM FAINT
30-40				
40-50				

NOTE: T.P. 3 IS ALSO 2-C SOILS, WITH 19" TO MOTTLING.

Soil Profile <u>3</u>	Classification <u>C</u>	Slope <u>8%</u>	Limiting Factor <u>19"</u>	<input checked="" type="checkbox"/> Ground Water <input type="checkbox"/> Restrictive Layer <input type="checkbox"/> Bedrock
-----------------------	-------------------------	-----------------	----------------------------	--

Soil Profile <u>3</u>	Classification <u>C</u>	Slope <u>8%</u>	Limiting Factor <u>17"</u>	<input checked="" type="checkbox"/> Ground Water <input type="checkbox"/> Restrictive Layer <input type="checkbox"/> Bedrock
-----------------------	-------------------------	-----------------	----------------------------	--

*Julian L. Davis*  
Site Evaluator Signature

203  
SE#

5/25/1994  
Date

# SUBSURFACE WASTEWATER DISPOSAL SYSTEM APPLICATION

Town, City, Plantation

Street, Road, Subdivision LOT 17

Department of Human Services  
Division of Health Engineering

Owners Name

BAR HARBOR

PINE HEATH SUBDIVISION

RICHARD & ROSE COLTON

## SUBSURFACE WASTEWATER DISPOSAL PLAN

Scale 1" = 20 Ft.

22' WIDE BY 40' LONG DISPOSAL AREA WITH TOTAL OF 15 CONCRETE CHAMBERS

THREE ROWS ARE SEPARATED BY 5' AND FED BY SERIAL DISTRIBUTION.

INSTALL 1 FT WIDTH OF CLEAN STONE FILL AROUND PERIMETER OF CHAMBERS.

CAP END OF LAST CHAMBER IN SERIES

INSTALL 3 FT. WIDE BERM AROUND CHAMBERS AND STONE BEFORE DROPPING OFF FILL EXTENSION AT 4:1 SLOPE.

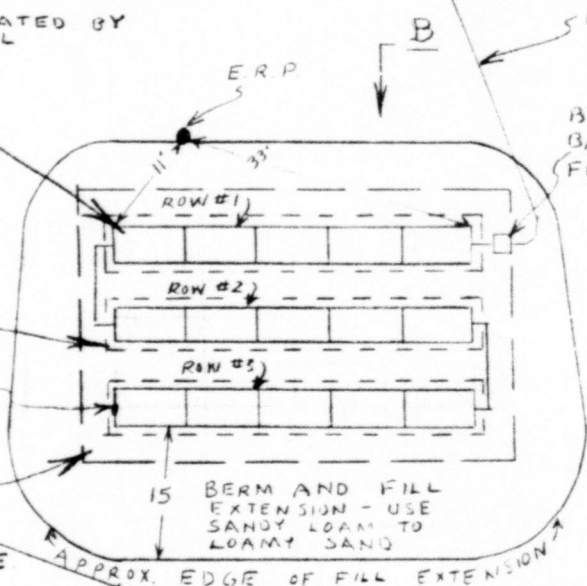

EFFLUENT LINE

DISTRIBUTION BOX MUST BE SET LEVEL ON A FIRM BASE AND INSULATED AGAINST FREEZING.

15 BERM AND FILL EXTENSION - USE SANDY LOAM TO LOAMY SAND

APPROX. EDGE OF FILL EXTENSION

APPROX. PROPERTY LINE

PINE HEATH R.O.W.

BOTTOMS OF CHAMBERS IN:	DEPTH BELOW E.R.P.
ROW # 1	-60"
ROW # 2	-69"
ROW # 3	-78"

### FILL REQUIREMENTS

Depth of Fill (Upslope)

21"

Depth of Fill (Downslope)

24"

### CONSTRUCTION ELEVATIONS

Reference Elevation is

0"

Bottom of Disposal Area (ROW #1)

-60"

Top of Distribution Lines of Chambers

-47"

### ELEVATION REFERENCE POINT

LOCATION & DESCRIPTION

NAIL 3/4" ABOVE GROUND IN A 20" DIA. OAK TREE LOCATED 11' AT 237' FROM SW COR. OF CHAMBERS.

Scale:

Vertical: 1 inch = 5 Ft.

Horizontal: 1 inch = 10 Ft.

### DISPOSAL AREA CROSS SECTION (ACROSS A-B ABOVE)

DISPOSAL AREA AND FILL EXTENSIONS SHOULD BE SEEDED TO PREVENT EROSION. LOAM AND MULCH ENTIRE AREA NO GREATER THAN 25% SLOPE (4:1) ON FILL EXTENSION BEYOND 3' BERM.

CLEAN SANDY LOAM TO LOAMY SAND FILL AROUND CHAMBERS AND 8" 12" THICK OVER CHAMBERS.

INSTALL 3 FT. WIDE BERM

2" COMPRESSED MAT PLACED OVER STONE

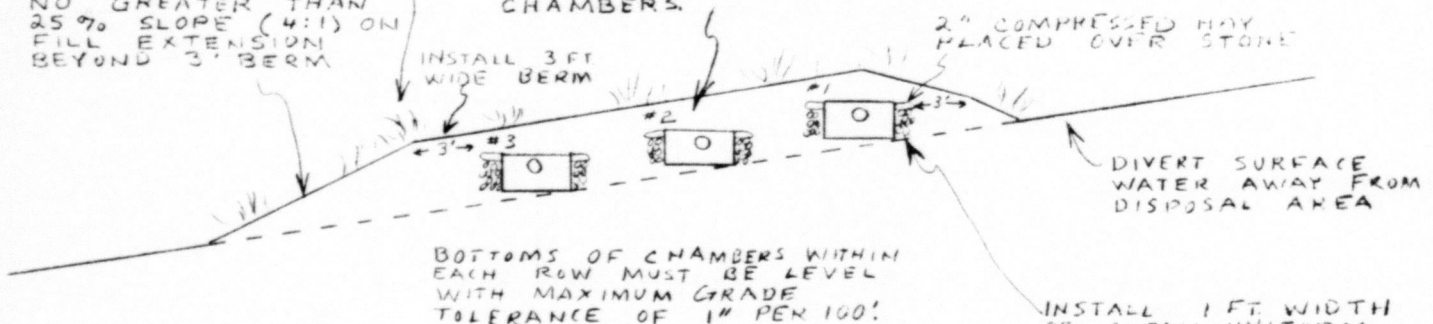

DIVERT SURFACE WATER AWAY FROM DISPOSAL AREA

BOTTOMS OF CHAMBERS WITHIN EACH ROW MUST BE LEVEL WITH MAXIMUM GRADE TOLERANCE OF 1" PER 100'

INSTALL 1 FT. WIDTH OF CLEAN, UNIFORM SIZED STONE OF 3/4" - 2 1/2" DIA. AROUND PERIMETER OF CHAMBERS.

NOTE: SCARIFY ORIGINAL GROUND UNDER CHAMBERS AND FILL EXTENSIONS.

*William L. Davis*  
Site Evaluator Signature

203  
SE#

5/25/1994  
Date