

SUBSURFACE WASTEWATER DISPOSAL SYSTEM APPLICATION

Division of Health Engineering, Station 10
(207) 287-5672 FAX (207) 287-4172

PROPERTY LOCATION		>> Caution: Permit Required -- Attach in Space Below <<
City, Town, or Plantation	FRENCHBORO	The Subsurface Wastewater Disposal System <i>shall not</i> be installed until a Permit is attached HERE by the Local Plumbing Inspector. The Permit shall authorize the owner or installer to install the disposal system in accordance with this application and the Maine Subsurface Wastewater Disposal Rules.
Street or Road	BUTLER ROAD	
Subdivision, Lot #		
OWNER/APPLICANT INFORMATION		
Name (last, first, MI)	LUNT, DEAN	<input checked="" type="checkbox"/> Owner <input type="checkbox"/> Applicant
Mailing Address of	DAVID LUNT 2 WEST SIDE	
<input type="checkbox"/> Owner <input checked="" type="checkbox"/> Applicant	FRENCHBORO, ME 04635	
Daytime Tel. #	334-2923	Municipal Tax Map # _____ Lot # _____
Owner or Applicant Statement		Caution: Inspections Required
I state that the information submitted is correct to the best of my knowledge and understand that any falsification is reason for the Department and/or Local Plumbing Inspector to deny a Permit.		I have inspected the installation authorized above and found it to be in compliance with the Subsurface Wastewater Disposal Rules Application.
Signature of Owner or Applicant _____ Date _____		Local Plumbing Inspector Signature _____ (1st) Date Approved _____ (2nd) Date Approved _____

PERMIT INFORMATION		
TYPE OF APPLICATION 1. <input checked="" type="checkbox"/> First Time System 2. <input type="checkbox"/> Replacement System Type Replaced: _____ Year installed: _____ 3. <input type="checkbox"/> Expanded System a. <input type="checkbox"/> Minor Expansion b. <input type="checkbox"/> Major Expansion 4. <input type="checkbox"/> Experimental System 5. <input type="checkbox"/> Seasonal Conversion	THIS APPLICATION REQUIRES 1. <input checked="" type="checkbox"/> No Rule Variance 2. <input type="checkbox"/> First Time System Variance a. <input type="checkbox"/> Local Plumbing Inspector Approval b. <input type="checkbox"/> State & Local Plumbing Inspector Approval 3. Replacement System Variance a. <input type="checkbox"/> Local Plumbing Inspector Approval b. <input type="checkbox"/> State & Local Plumbing Inspector Approval 4. <input type="checkbox"/> Minimum Lot Size Variance 5. <input type="checkbox"/> Seasonal Conversion Approval	DISPOSAL SYSTEM COMPONENT(S) 1. <input checked="" type="checkbox"/> Complete Non-engineered System 2. <input type="checkbox"/> Primitive System (graywater & alt toilet) 3. <input type="checkbox"/> Alternative Toilet, specify: _____ 4. <input type="checkbox"/> Non-Engineered Treatment Tank (only) 5. <input type="checkbox"/> Holding Tank, _____ gallons 6. <input type="checkbox"/> Non-engineered Disposal Field (only) 7. <input type="checkbox"/> Separated Laundry System 8. <input type="checkbox"/> Complete Engineered System (2000 gpd or more) 9. <input type="checkbox"/> Engineered Treatment Tank (only) 10. <input type="checkbox"/> Engineered Disposal Field (only) 11. <input type="checkbox"/> Pre-treatment, specify: _____ 12. <input type="checkbox"/> Miscellaneous components
SIZE OF PROPERTY +/- 1 <input type="checkbox"/> sq. ft. <input checked="" type="checkbox"/> acres	DISPOSAL SYSTEM TO SERVE 1. <input checked="" type="checkbox"/> Single Family Dwelling Unit, No. of Bedrooms: <u>4</u> 2. <input type="checkbox"/> Multiple Family Dwelling, No. of Units: _____ 3. <input type="checkbox"/> Other: _____	TYPE OF WATER SUPPLY 1. <input checked="" type="checkbox"/> Drilled Well 2. <input type="checkbox"/> Dug Well 3. <input type="checkbox"/> Private 4. <input type="checkbox"/> Public 5. <input type="checkbox"/> Other: _____
SHORELAND ZONING <input checked="" type="checkbox"/> Yes <input type="checkbox"/> No		

DESIGN DETAILS (SYSTEM LAYOUT SHOWN ON PAGE 3)			
TREATMENT TANK 1. <input checked="" type="checkbox"/> Concrete a. <input checked="" type="checkbox"/> Regular b. <input type="checkbox"/> Low Profile 2. <input type="checkbox"/> Plastic 3. <input type="checkbox"/> Other: _____ CAPACITY <u>1000</u> gallons	DISPOSAL FIELD TYPE & SIZE 1. <input type="checkbox"/> Stone Bed 2. <input type="checkbox"/> Stone Trench 3. <input checked="" type="checkbox"/> Proprietary Device a. <input type="checkbox"/> Cluster array c. <input checked="" type="checkbox"/> Linear b. <input checked="" type="checkbox"/> Regular load d. <input type="checkbox"/> H-20 load 4. <input type="checkbox"/> Other: _____ SIZE <u>950</u> <input checked="" type="checkbox"/> sq. ft. <input type="checkbox"/> lin. ft.	GARBAGE DISPOSAL UNIT 1. <input checked="" type="checkbox"/> No 3. <input type="checkbox"/> Maybe 2. <input type="checkbox"/> Yes >> Specify one below: a. <input type="checkbox"/> Multi-compartment Tank b. <input type="checkbox"/> Tanks in Series c. <input type="checkbox"/> Increase in Tank Capacity d. <input type="checkbox"/> Filter on Tank Outlet	DESIGN FLOW <u>360</u> gallons per day BASED ON: 1. <input checked="" type="checkbox"/> Table 501.1 (dwelling unit(s)) 2. <input type="checkbox"/> Table 501.2 (other facilities) SHOW CALCULATIONS - for other facilities -
SOIL DATA & DESIGN CLASS PROFILE CONDITION DESIGN <u>4 / C / 1</u> at Observation Hole # <u>TP1</u> Depth <u>45</u> - Elevation <u>+36</u> OF MOST LIMITING SOIL FACTOR	DISPOSAL FIELD SIZING 1. <input type="checkbox"/> Small - 2.0 sq. ft./gpd 2. <input checked="" type="checkbox"/> Medium - 2.6 sq. ft./gpd 3. <input type="checkbox"/> Medium-Large - 3.3 sq. ft./gpd 4. <input type="checkbox"/> Large - 4.1 sq. ft./gpd 5. <input type="checkbox"/> Extra Large - 5.0 sq. ft./gpd	PUMPING 1. <input checked="" type="checkbox"/> Not Required 2. <input type="checkbox"/> May Be Required 3. <input type="checkbox"/> Required >> Specify only for engineered or experimental systems: DOSE: _____ gallons	3. <input type="checkbox"/> Section 503.0 (meter readings) ATTACH WATER-METER DATA

SITE EVALUATOR STATEMENT		
Certify that on <u>05/14/01</u> (date) I completed a site evaluation on this property and state that the data reported are accurate and that the proposed system is in compliance with the State of Maine Subsurface Wastewater Disposal Rules (10-144A CMR 241).		
 Site Evaluator Signature	<u>265</u> SE #	<u>6-2-01</u> Date

FRENCHBORO

BUTLER ROAD

DEAN LIGHT

STANDARD BIODIFFUSER (TYP.)

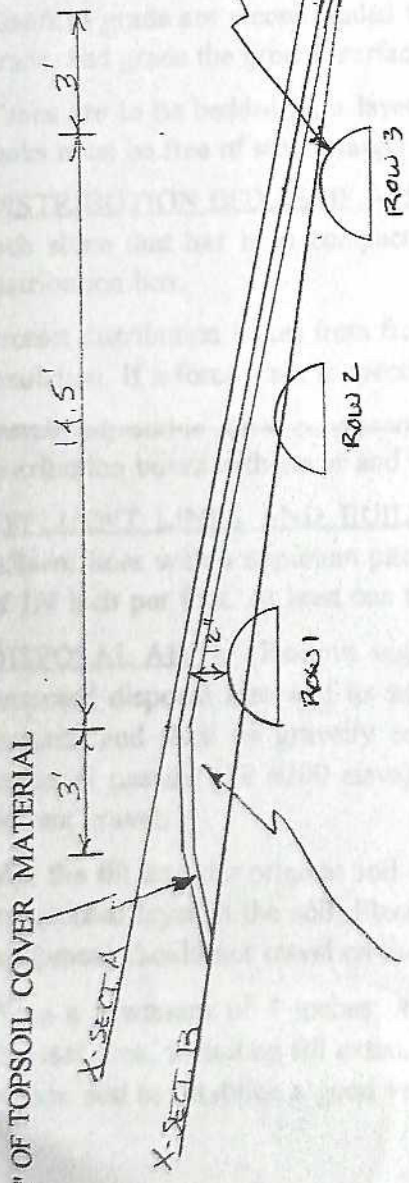

GRAVELLY COARSE SAND
 BACKFILL:
 FILL SHALL HAVE 4 TO 8 % FINES
 (MATERIAL PASSING #200 SIEVE),
 WITH LESS THAN 2% CLAY. FILL
 SHALL CONTAIN 15 TO 30 %
 GRAVEL (BY WEIGHT).

ROW	ELEVATION OF BOTTOM OF CHAMBERS	ELEVATION OF TOP OF CHAMBERS
1	+ 42" OR 104.0'	+ 62" OR 105.17'
2	+ 33" OR 102.75'	+ 47" OR 103.92'
3	+ 18" OR 101.5'	+ 32" OR 102.67'

ELEVATION REFERENCE POINT
 LOCATION & DESCRIPTION
 TBM- SCREW WITH FLAGGING,
 24" ABOVE GROUND IN UTILITY
 POLE #6

FILL REQUIREMENTS	X-SECTION A	X-SECTION B
Depth of Fill (Upslope)	0	18"
Depth of Fill (Downslope)	0	10"

CONSTRUCTION ELEVATIONS

Reference Elevation is 0" or 100.00'
 Bottom of Chambers See Cross Section Table Above
 Top of Chambers See Cross Section Table Above

NOTES:

- System to be level with a maximum grade tolerance of 2" / 100'.
- Remove vegetation and scarify the original surface in the disposal area and fill extensions.
- Place and compact fill in 8" lifts using small track equipment only. Do not over compact.
 Do not use rubber tired equipment within the disposal area.
- Mix fill material into original soil to a depth of 6" or greater by plowing, disking, or rototilling.
- Protect all system components from freezing or crushing with adequate fill and/or insulation as necessary.
- Grade all areas around system to divert surface water away from system.
- Lime, fertilizer, seed, and mulch all disturbed areas to promote growth of grass cover and prevent erosion.
- Any other permit applications or notifications needed for the installation of this disposal system or any associated development are the responsibility of the owner/applicant.
- This system is not designed for use with a garbage disposal.
- See additional notes attached.

PAUL B. COREY
 SOIL CONSULTING
 99 BOUTELLE ROAD BANGOR, ME 04401
 (207) 945-4302

DISPOSAL AREA CROSS SECTION

Scale:
 Vertical: 1 Inch = 5 Feet
 Horizontal: 1 Inch = 5 Feet

Paul B. Corey 265 6-2-01

SUBSURFACE WASTEWATER DISPOSAL SYSTEM APPLICATION

Department of Human Services
Division of Health Engineering
(207) 287-5672 FAX (207) 287-4172

Town, City, Plantation
FRENCHCRO

Street, Road, Subdivision
BUTLER ROAD

Owner's Name
DEAN LUNT

SCALE 1" = 20 FT

SUBSURFACE WASTEWATER DISPOSAL PLAN

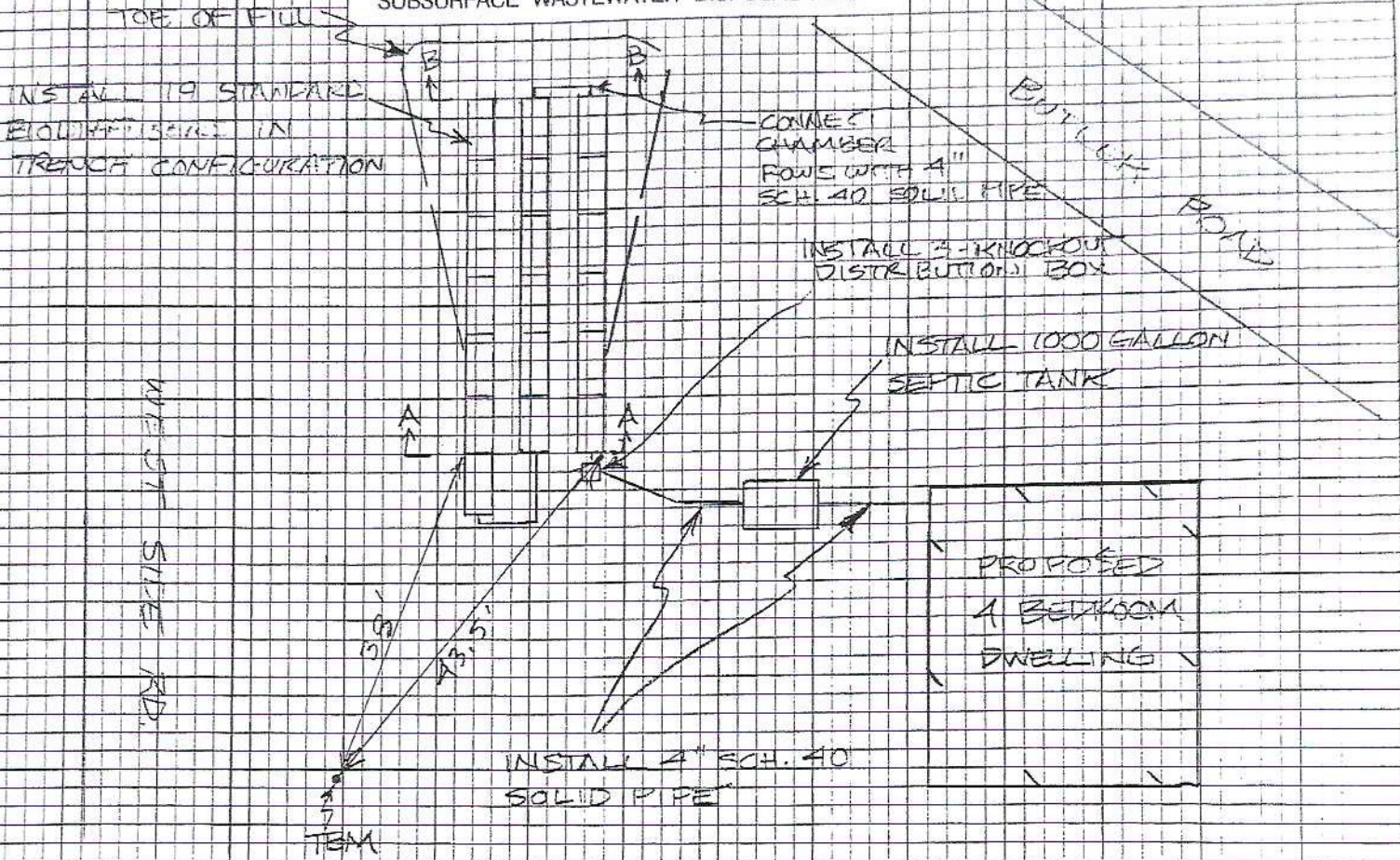

FILL REQUIREMENTS

Depth of Fill (Upslope) _____
Depth of Fill (Downslope) _____

CONSTRUCTION ELEVATIONS

Finished Grade Elevation _____
Top of Distribution Pipe or Proprietary Device _____
Bottom of Disposal Area _____

ELEVATION REFERENCE POINT

Location & Description _____
Reference Elevation _____

DISPOSAL AREA CROSS SECTION

SCALE:
VERTICAL: 1" = _____
HORIZONTAL: 1" = _____

SEE DISPOSAL AREA CROSS SECTION ATTACHED

Paul Bl...

Site Evaluator Signature

265
d "

0.2-01
Date

SUBSURFACE WASTEWATER DISPOSAL SYSTEM APPLICATION

Department of Human Services
 Division of Health Engineering
 (207) 287-5572 FAX (207) 287-4372

Town, City, Plantation
FRENCHTOWN ORO

Street, Road Subdivision
BUTLER ROAD

Owner's Name
DEAN LUNT

Owner's Name
DEAN LUNT

SITE LOCATION PLAN
 (Map from Maine Atlas
 recommended) SEE MAP
 ATTACHED

SITE PLAN

Scale 1" = 50 Ft.
 or as shown

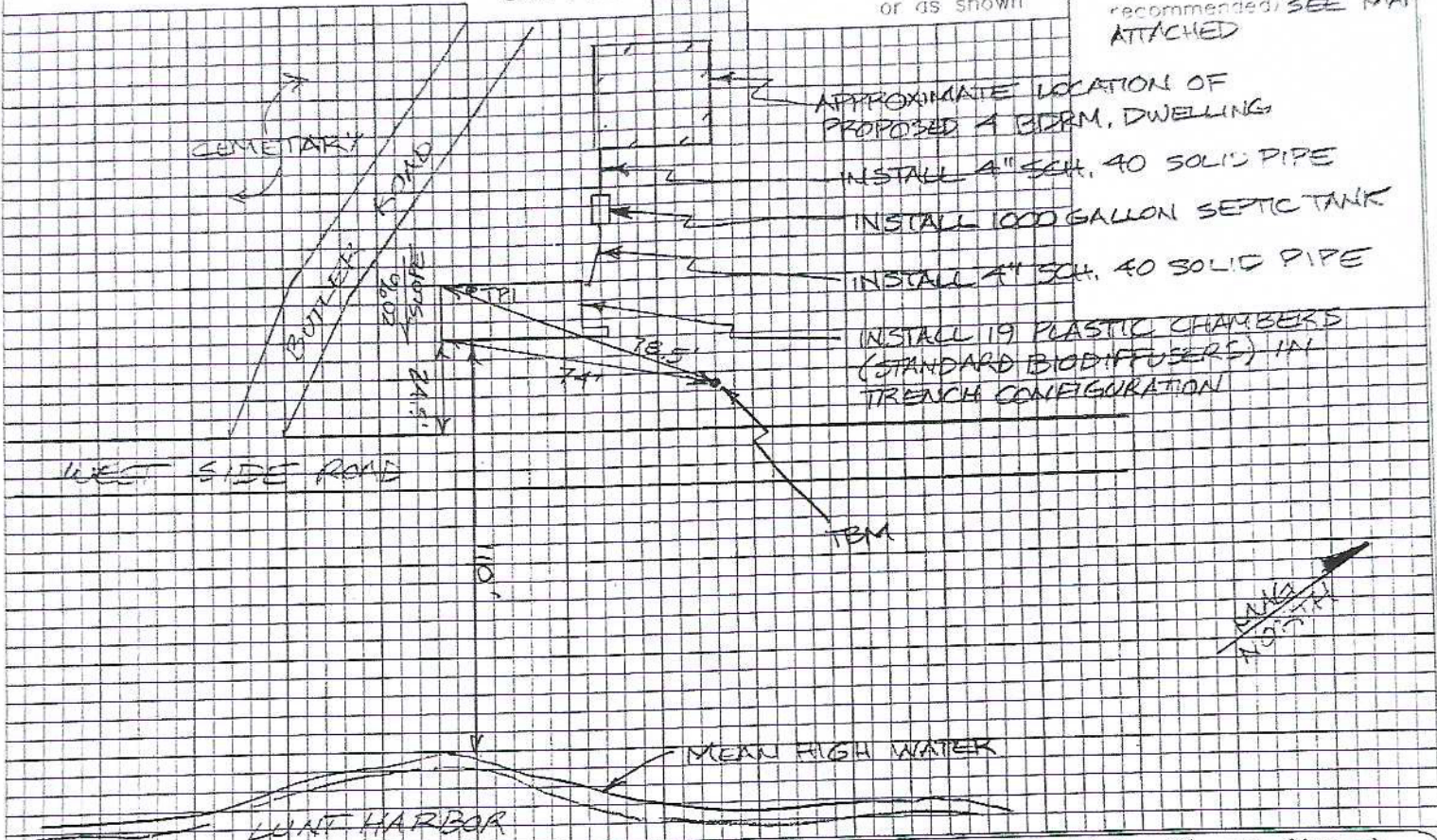

SOIL DESCRIPTION AND CLASSIFICATION (Location of Observation Holes Shown Above)

Observation Hole TPI Test Pit Boring
4 " Depth of Organic Horizon Above Mineral Soil

DEPTH BELOW MINERAL SOIL SURFACE (inches)	Texture	Consistency	Color	Mottling
0				
10	FINE SAND		DARK BROWN	
20	LOAM	FRIABLE	STRONG BROWN	
30	GRAVELLY LOAM			
40	SAND			
50		FIRM	LIGHT OLIVE BROWN	COMMON FL MOTTLED

Soil Classification A C	Slope 20%	Limiting Factor 15"	<input checked="" type="checkbox"/> Ground Water <input type="checkbox"/> Restrictive Layer <input type="checkbox"/> Bedrock <input type="checkbox"/> Pit Depth
Profile	Condition		

Observation Hole _____ Test Pit Boring
 _____ " Depth of Organic Horizon Above Mineral Soil

DEPTH BELOW MINERAL SOIL SURFACE (inches)	Texture	Consistency	Color	Mottling
0				
10				
20				
30				
40				
50				

Soil Classification	Slope	Limiting Factor	<input type="checkbox"/> Ground Water <input type="checkbox"/> Restrictive Layer <input type="checkbox"/> Bedrock <input type="checkbox"/> Pit Depth
Profile	Condition		

Paul B. Co...
 Site Evaluator Signature

265
 SE *

6-2-01
 Date